

---

LAVAVAJILLAS DE CAPOTA  
*HOOD TYPE DISHWASHERS*

---

MODELOS / *MODELS*

CO-110

CO-142

COP-144

AD-125

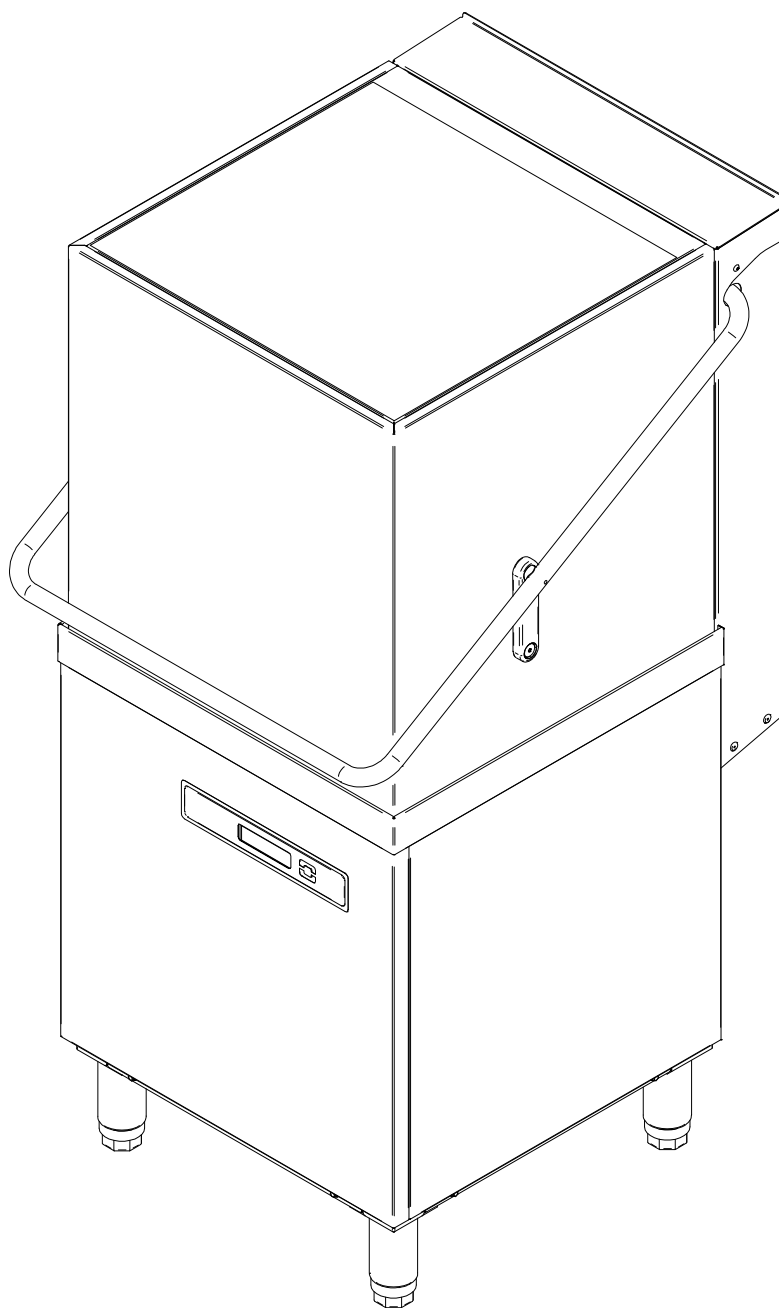

JUNIO 2018 *JUNE*  
Revisado JULIO 2019 *JULY updated*

Despiece técnico CO-110-142; COP-144; AD-125 /  
*Spare Parts CO-110-142; COP-144; AD-125*

---

## CONTENIDO / CONTENTS

---

MUEBLE / UNIT.	1-2
CAPOTA / HOOD.	3-4
PORTAMANDOS (CO-110) / CONTROL HOLDER (CO-110).	5-6
PORTAMANDOS (CO-142) / CONTROL HOLDER (CO-142).	7-8
PORTAMANDOS (COP) / CONTROL HOLDER (COP).	9-10
PORTAMANDOS (AD) / CONTROL HOLDER (AD).	11-12
COMPONENTES CUBA (CO-COP) / TANK PARTS (CO-COP).	13-14
COMPONENTES CUBA (AD) / TANK PARTS (AD).	15-16
CONJUNTO DESAGÜE (AD) / DRAINAGE ASSEMBLY (AD).	17-18
CONJUNTO HIDRÁULICO (CO) / HYDRAULIC ASSEMBLY (CO).	19-20
CONJUNTO HIDRÁULICO (COP-AD) / HYDRAULIC ASSEMBLY (COP-AD).	21-22
CONJUNTO HIDRÁULICO (AD SOFT) / HYDRAULIC ASSEMBLY (AD SOFT).	23-24
CALDERÍN (CO) / HEATER (CO).	25-26
CALDERÍN (COP-AD) / HEATER (COP-AD).	27-29
*KIT BOMBA DESAGÜE (B) / DRAINAGE PUMP KIT (B)	30-31
*KIT DOSIFICADOR DETERGENTE (DD) / SOAP DISPENSER KIT (DD).	32-33
*KIT HRS / HRS KIT.	34-35
VARIOS / MISCELLANEOUS.	36
REPUESTOS RECOMENDADOS / RECOMMENDED SPARE PARTS.	37-38
ESQUEMAS ELÉCTRICOS / WIRING DIAGRAMS.	39-42

\* KITS NO INCLUIDOS EN TODOS LOS MODELOS / KITS NOT INCLUDED IN ALL MODELS

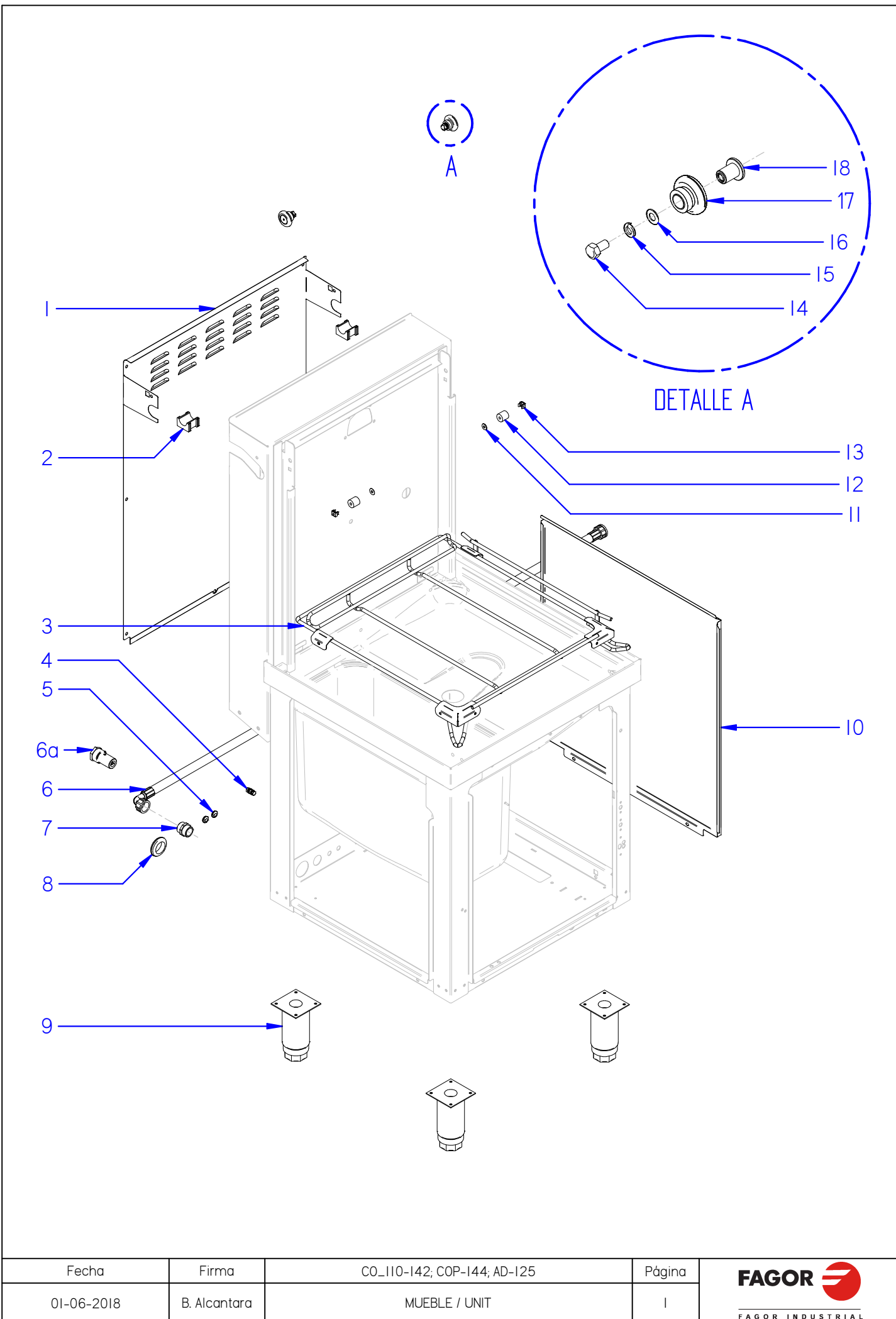



Fecha	Firma	CO-I10-I42; COP-I44; AD-I25	Página	<b>FAGOR</b>  FAGOR INDUSTRIAL
01-06-2018	B. Alcantara	MUEBLE / UNIT	I	

## LAVAVAJILLAS / DISHWASHER

MUEBLE / UNIT	
---------------	--

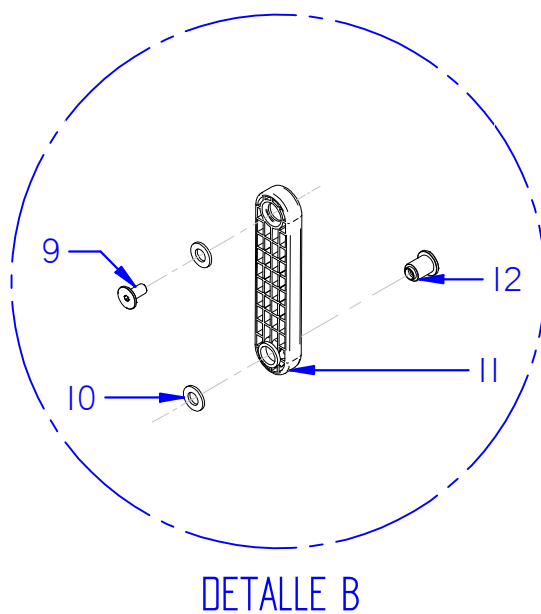
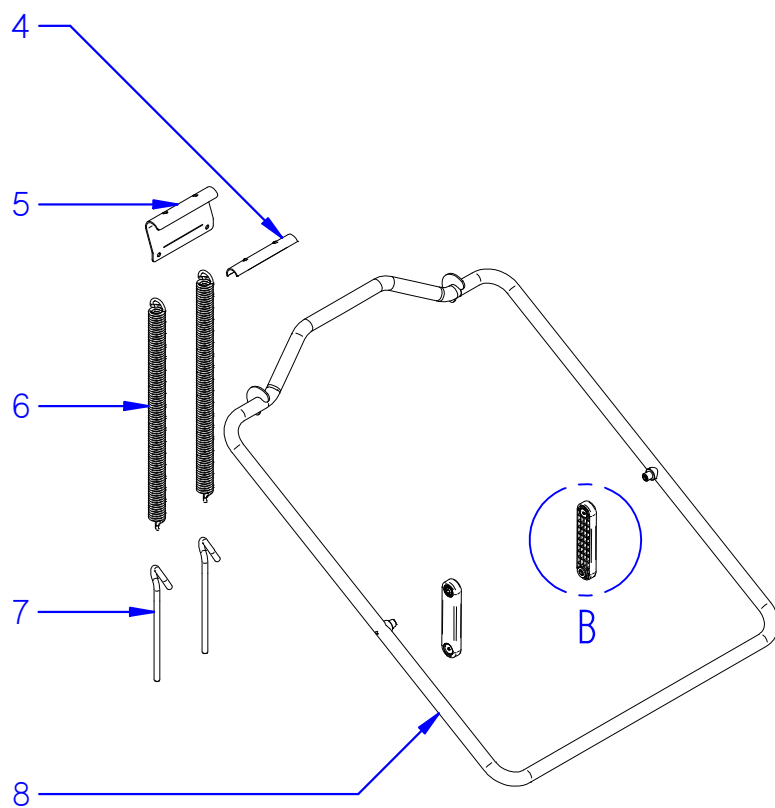
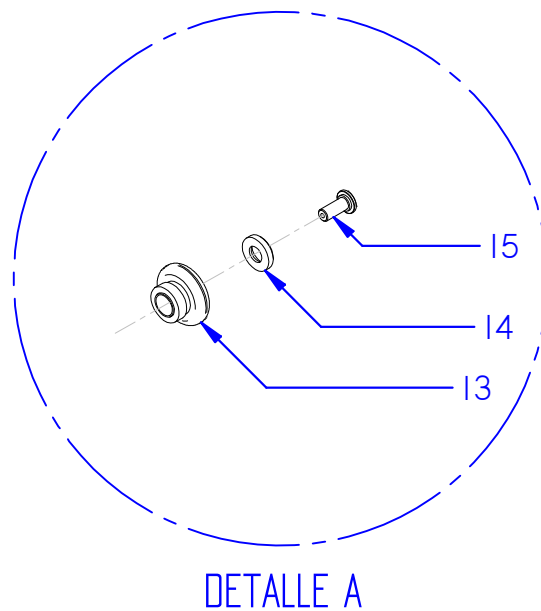
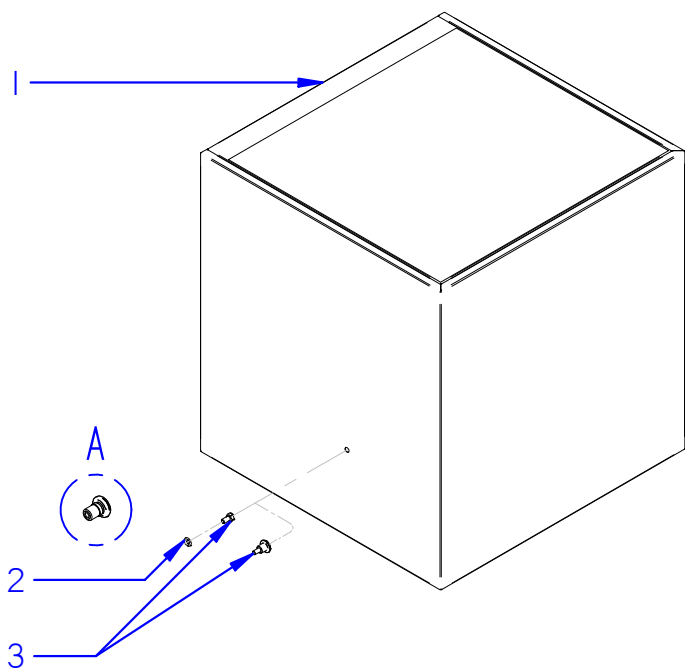
[illegible]





Fecha	Firma	CO-110; CO-142; COP-144; AD-125	Página	<b>FAGOR</b>  <small>FAGOR INDUSTRIAL</small>
01-06-2018	B. Alcantara	CAPOTA / HOOD	3	

## LAVAVAJILLAS / DISHWASHER

CAPOTA / HOOD
---------------

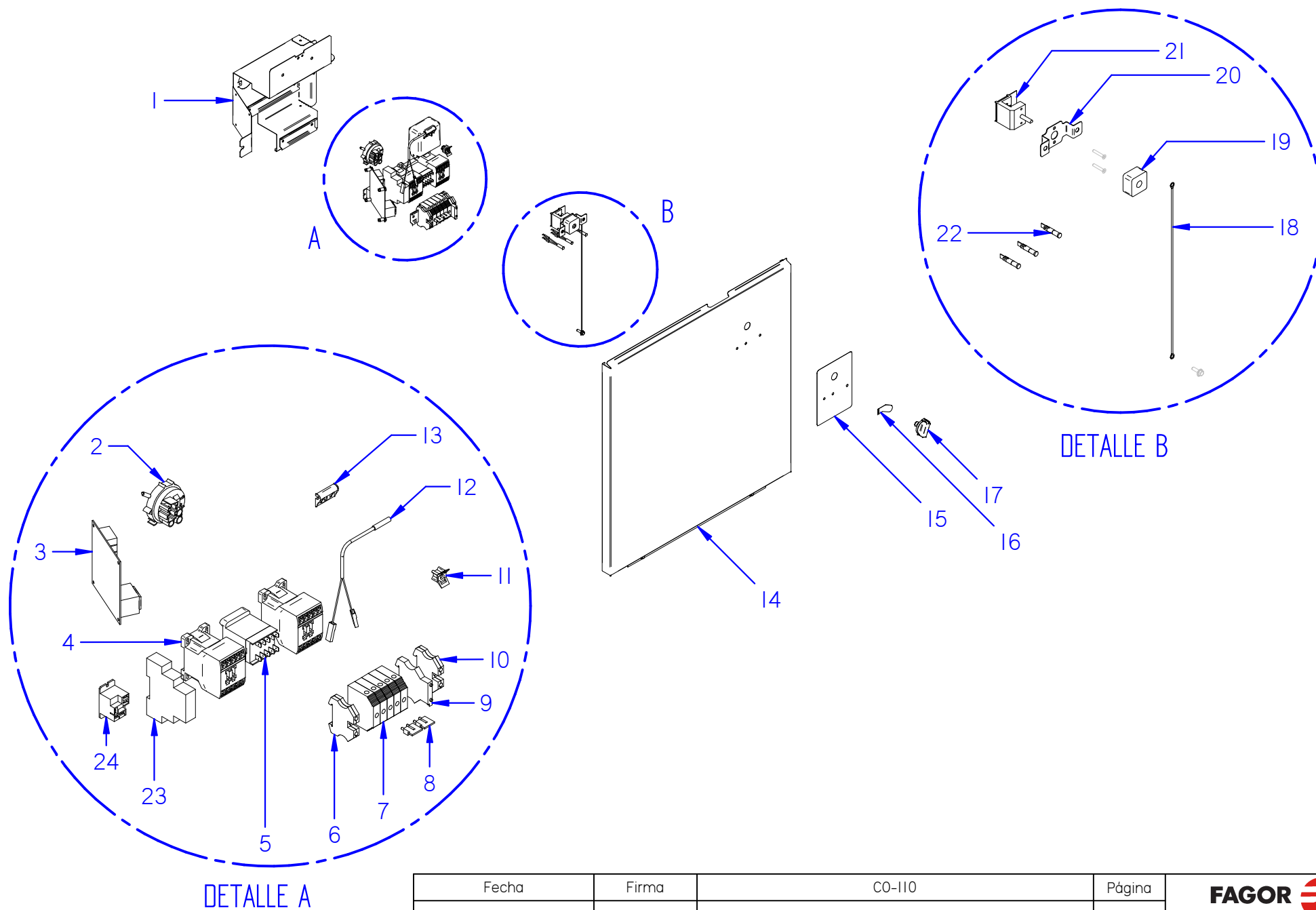
[illegible]



Fecha	Firma	CO-110	Página	<b>FAGOR</b>  FAGOR INDUSTRIAL
01-06-2018	B. Alcantara	PORTAMANDOS (CO-110) / CONTROL HOLDER (CO-110)	5	

**LAVAVAJILLAS / DISHWASHER**

**PORTAMANDOS (CO-110) / CONTROL HOLDER (CO-110)**

<p> solo modelos <i>HRS</i> / <i>HRS</i> models only  solo modelos <i>HRS</i> / <i>HRS</i> models only </p>
---



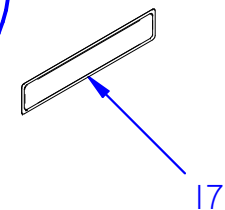
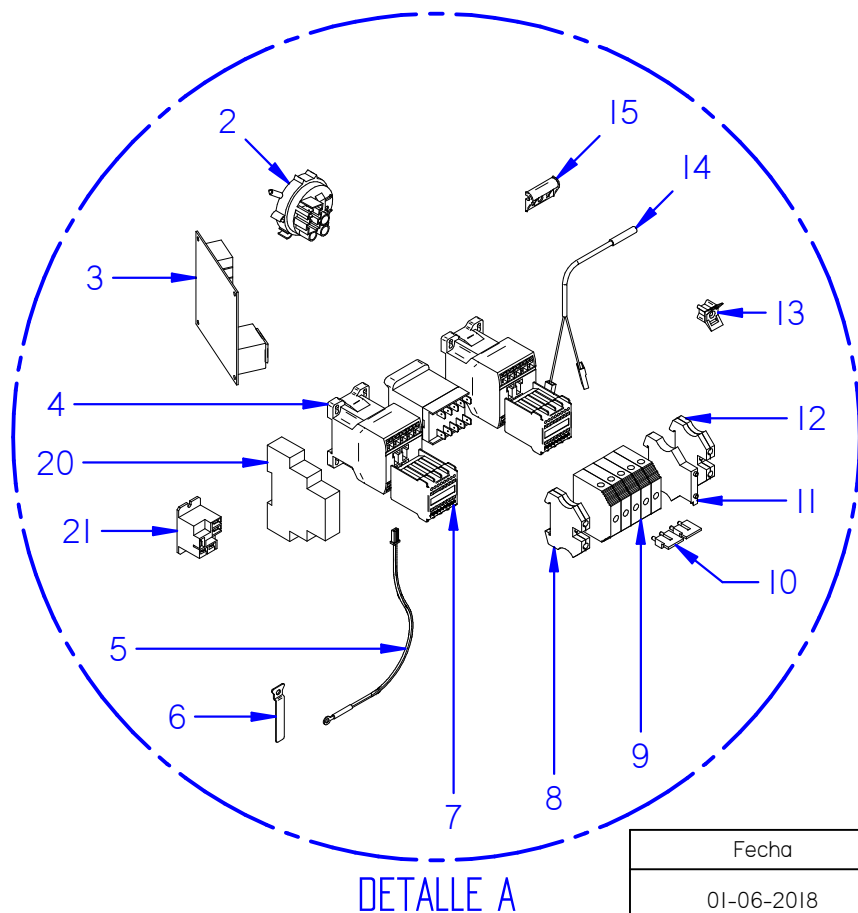
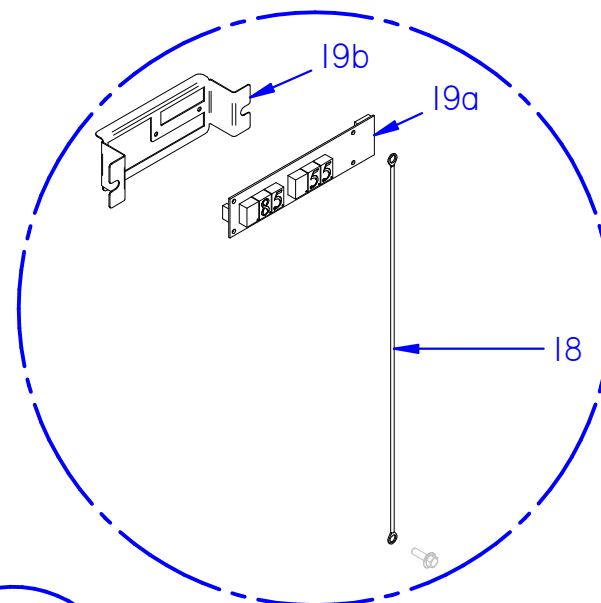
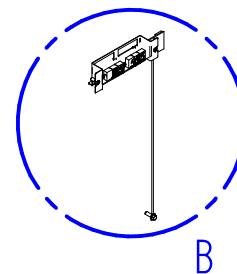
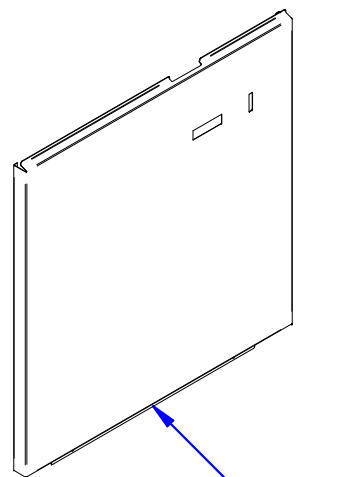
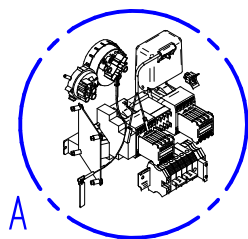
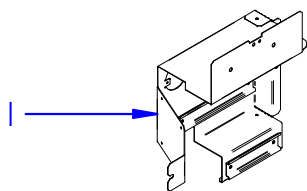

Fecha	Firma	CO-I42	Página	<b>FAGOR</b>  FAGOR INDUSTRIAL
01-06-2018	B. Alcantara	PORTAMANDOS (CO-I42) / CONTROL HOLDER (CO-I42)	7	

## LAVAVAJILLAS / DISHWASHER

## PORTAMANDOS (CO-142) / CONTROL HOLDER (CO-142)

[illegible]

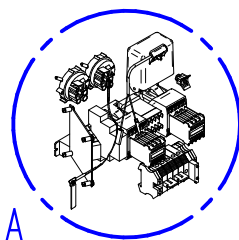
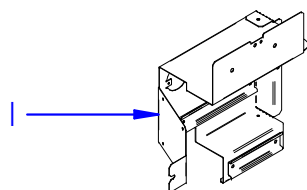

A

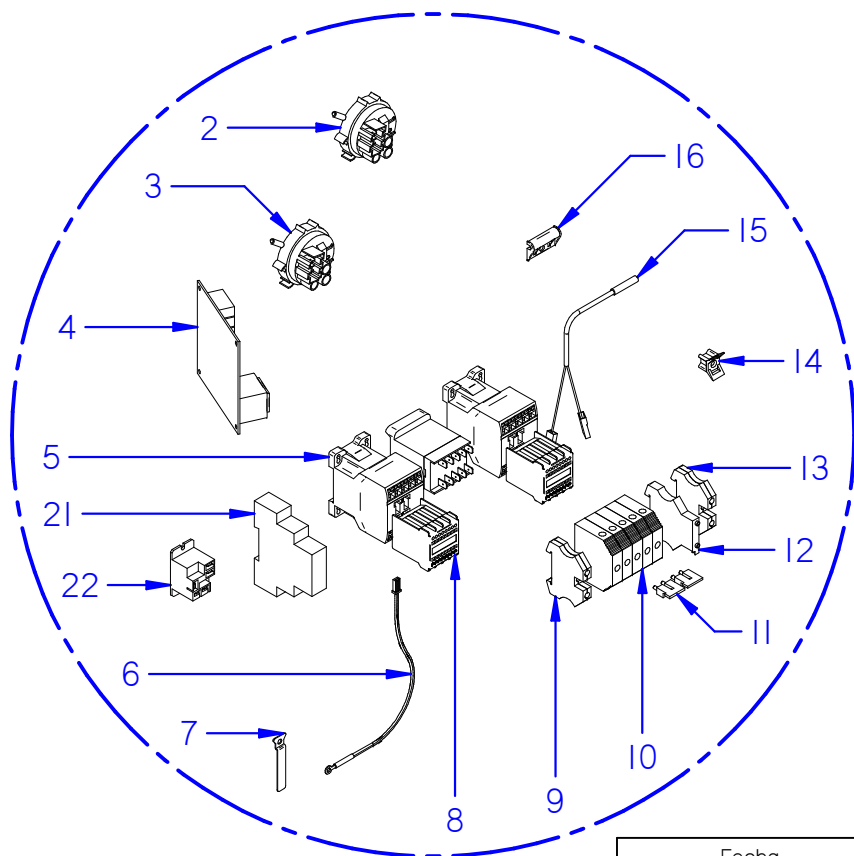

DETALLE A

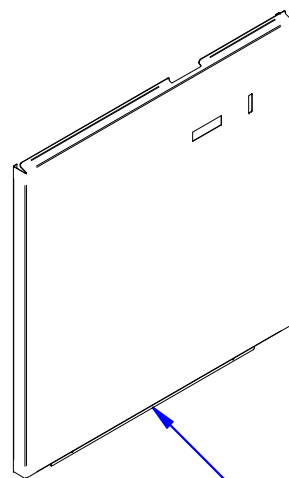

17

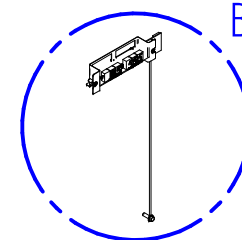

B

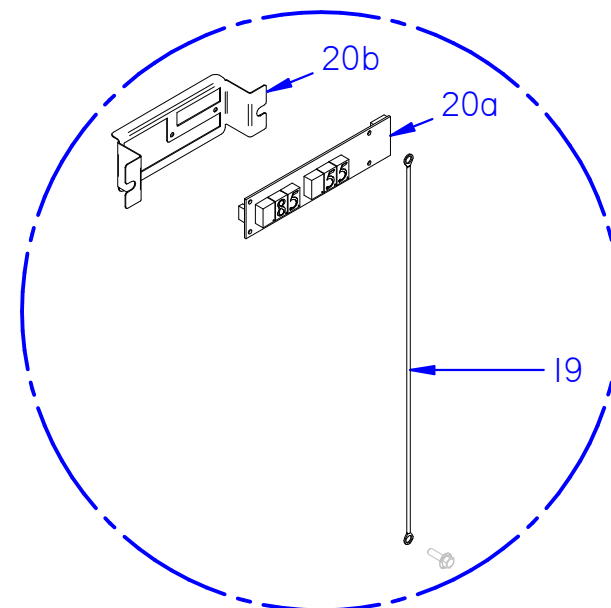

DETALLE B

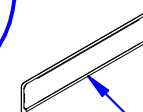

18

Fecha	Firma	COP-I44	Página	<b>FAGOR</b>  FAGOR INDUSTRIAL
01-06-2018	B. Alcantara	PORTAMANDOS (COP) / CONTROL HOLDER (COP)	9	

## LAVAVAJILLAS / DISHWASHER

PORTAMANDOS (COP) / CONTROL HOLDER (COP)
--

[illegible]

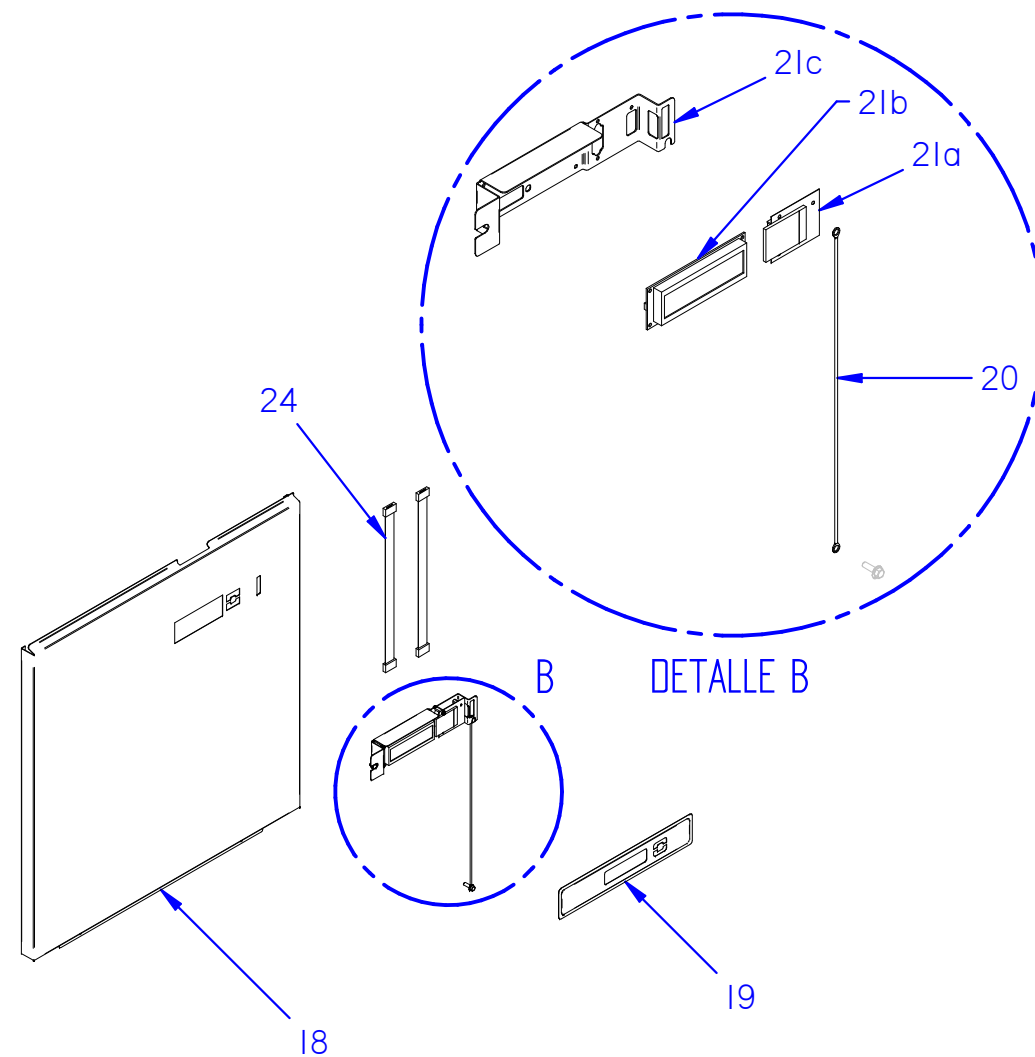
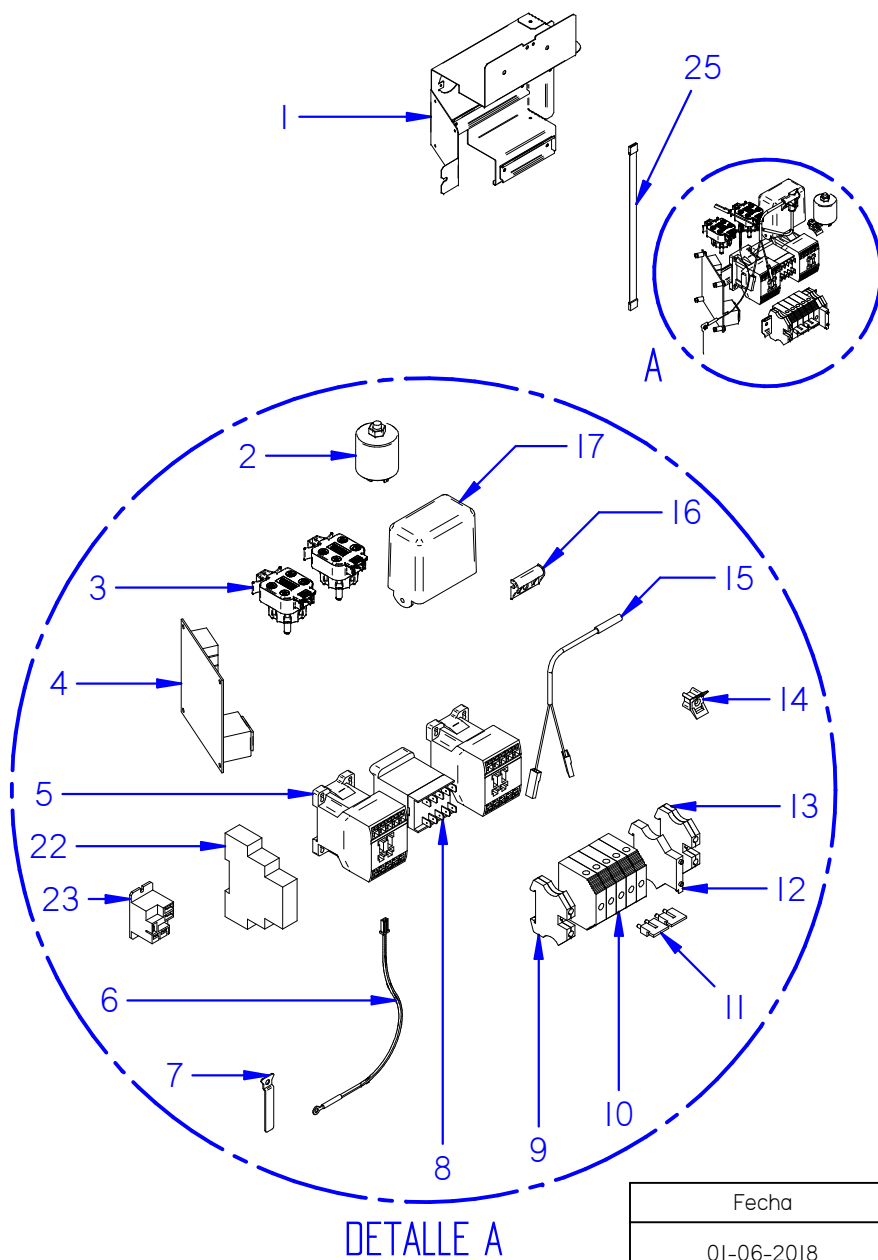



Fecha	Firma	AD-I25	Página	<b>FAGOR</b>  FAGOR INDUSTRIAL
01-06-2018	B. Alcantara	PORTAMANDOS (AD) / CONTROL HOLDER (AD)	II	

## LAVAVAJILLAS / DISHWASHER

PORTAMANDOS (AD) / CONTROL HOLDER (AD)
--

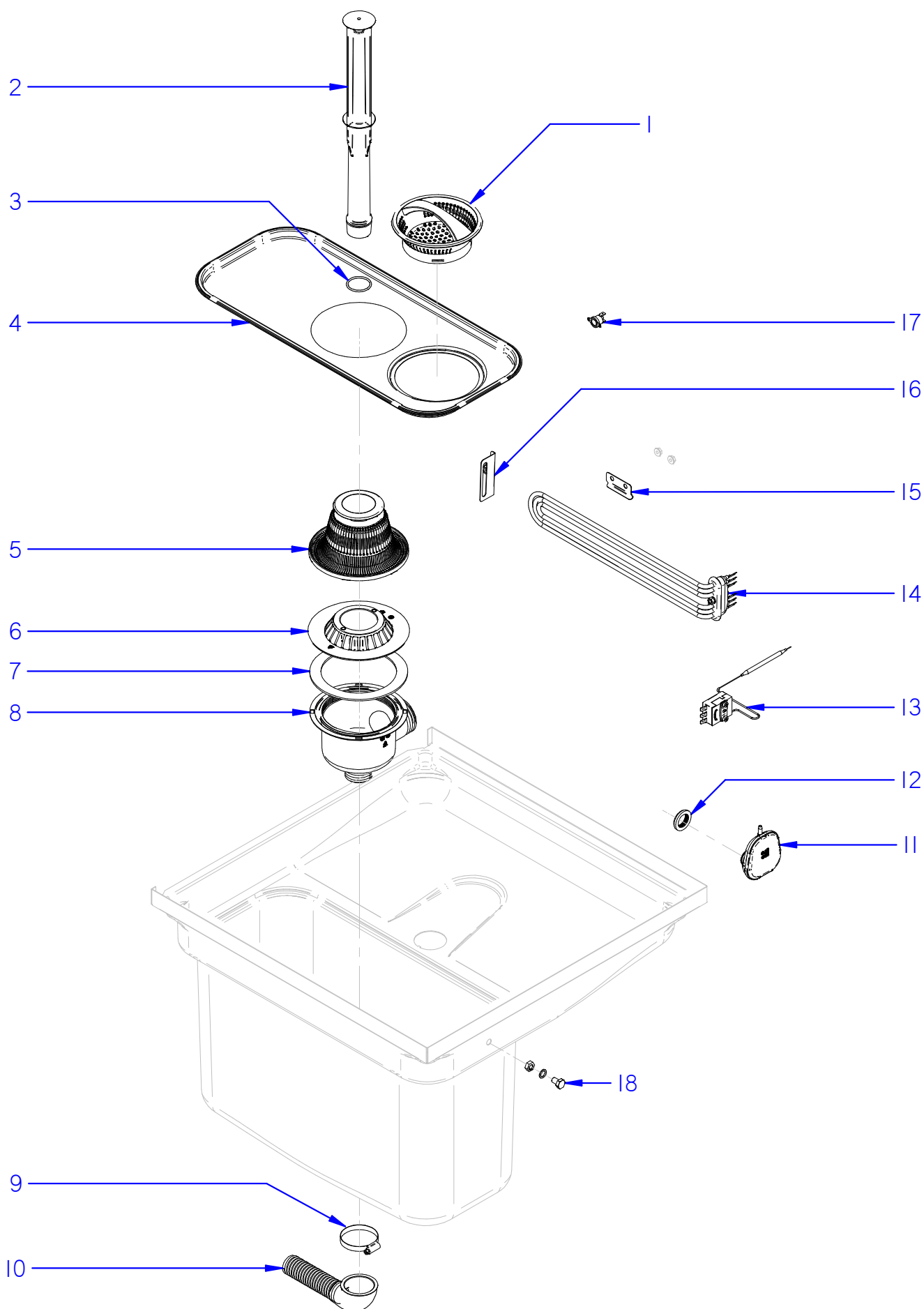
[illegible]



Fecha	Firma	CO_110-142; COP-144	Página	<b>FAGOR</b>  FAGOR INDUSTRIAL
01-06-2018	B. Alcantara	COMPONENTES CUBA (CO-COP) / TANK PARTS (CO-COP)	13	

**APARATO /  
APPLIANCE**

LAVAVAJILLAS / DISHWASHER

ZONA / ZONE

**COMPONENTES CUBA (CO-COP) / TANK PARTS (CO-COP)**

[illegible]

**Despiece técnico CO\_110-142; COP-144; AD-125 /  
Spare Parts CO\_110-142; COP-144; AD-125**



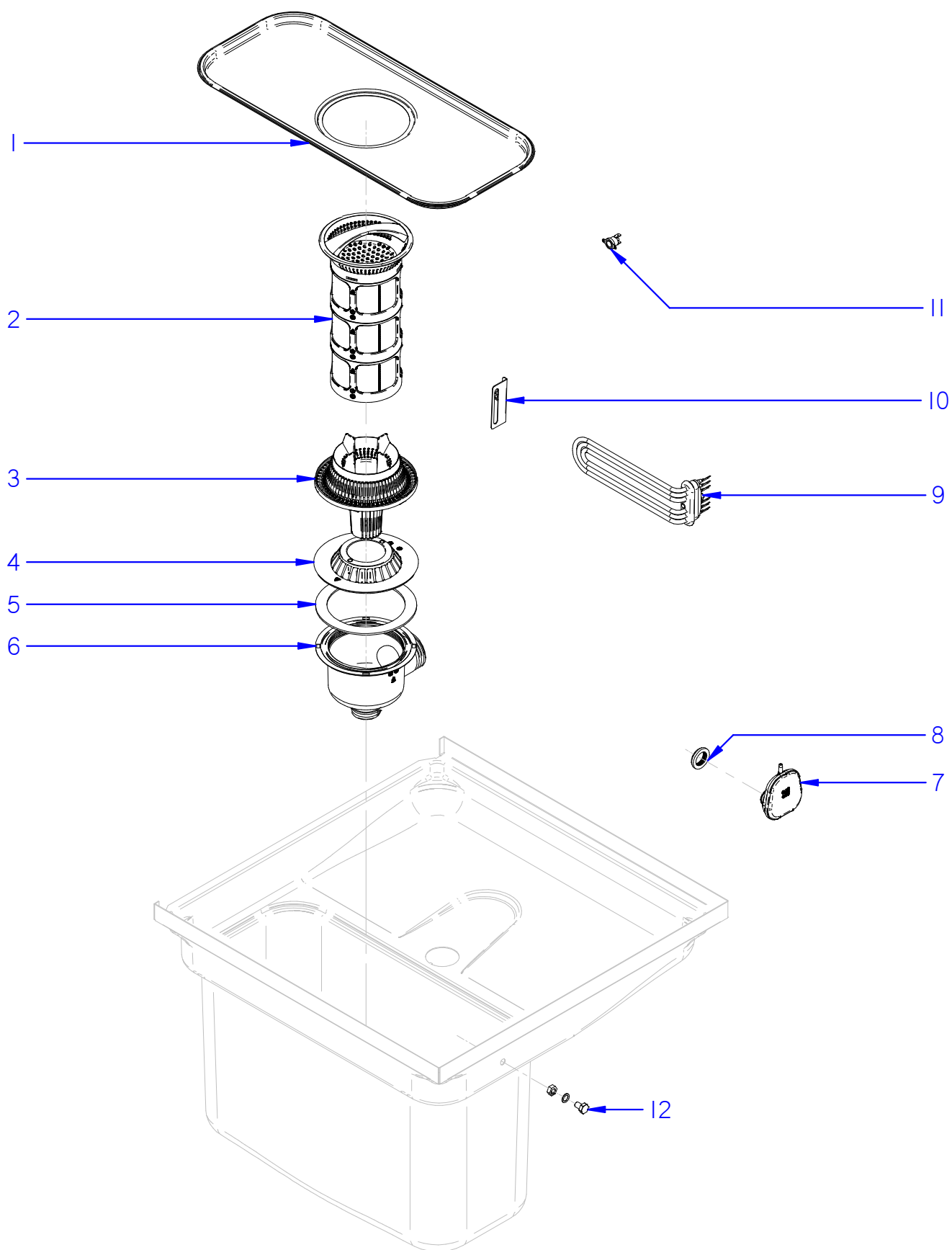



Fecha	Firma	AD-I25	Página	<b>FAGOR</b>  <small>FAGOR INDUSTRIAL</small>
01-06-2018	B. Alcantara	COMPONENTES CUBA (AD) / TANK PARTS (AD)	I5	

## LAVAVAJILLAS / DISHWASHER

## COMPONENTES CUBA (AD) / TANK PARTS (AD)

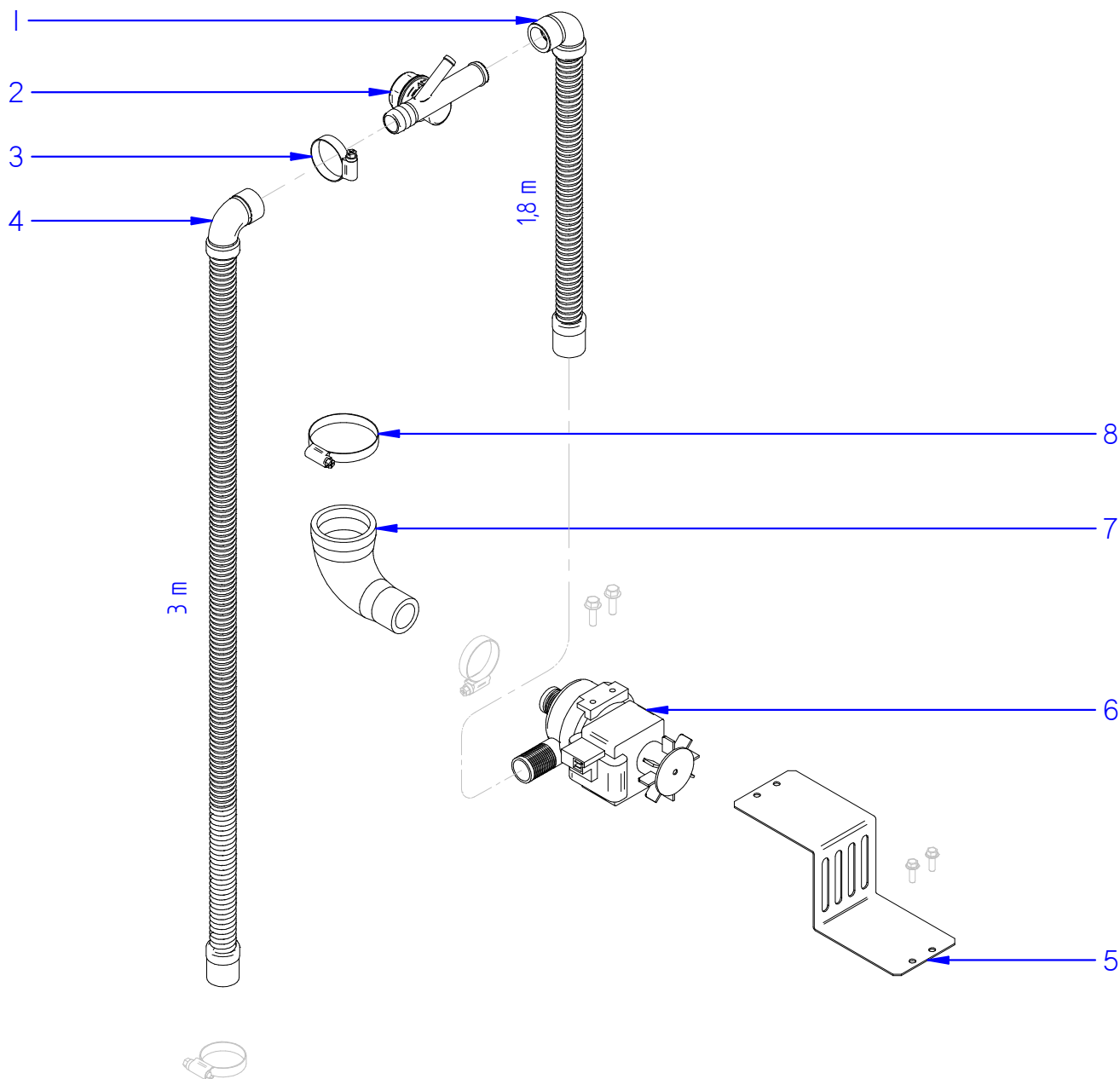
[illegible]



Fecha	Firma	AD-125, AD-125 SOFT	Página	<b>FAGOR</b>  FAGOR INDUSTRIAL
01-06-2018	B. Alcantara	CONJUNTO DESAGÜE (ADI) / DRAINAGE ASSEMBLY (ADI)	17	

**APARATO /  
APPLIANCE**

## LAVAJILLAS / DISHWASHER

**ZONA / ZONE**

**CONJUNTO DESAGÜE (AD) / DRAINAGE ASSEMBLY (AD)**

[illegible]

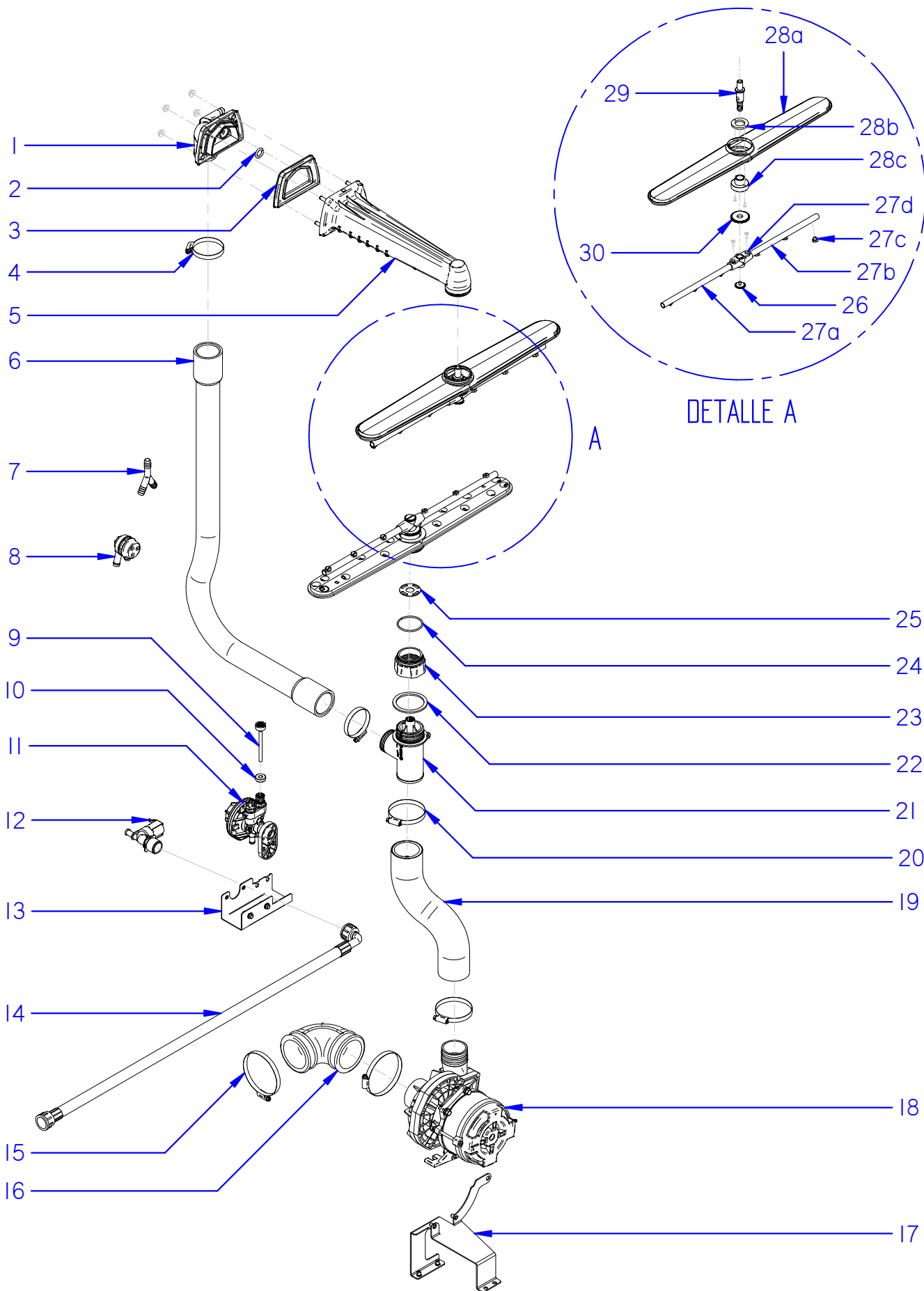

Fecha	Firma	C0_110-142	Página	<b>FAGOR</b>  FAGOR INDUSTRIAL
01-06-2018	B. Alcantara	CONJUNTO HIDRÁULICO (CO) / HYDRAULIC ASSEMBLY (CO)	19	

**FAGOR**   
FAGOR INDUSTRIAL

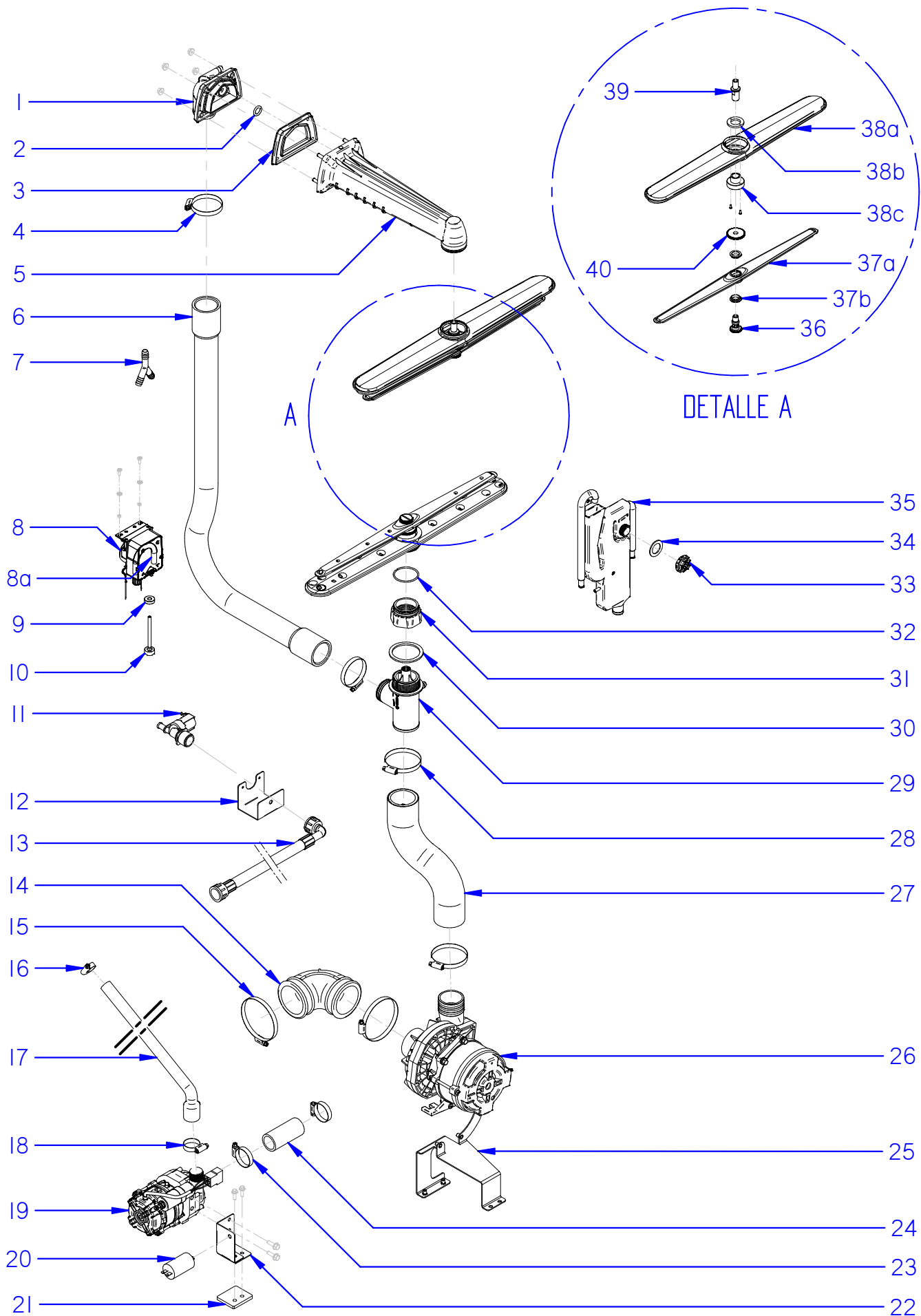

Fecha	Firma	COP-I44; AD-I25	Página	<b>FAGOR</b>  FAGOR INDUSTRIAL
01-06-2018	B. Alcantara	CONJUNTO HIDRÁULICO (COP-AD) / HYDRAULIC ASSEMBLY (COP-AD)	21	

ITEM	CODIGO REFERENCE	DENOMINACIÓN	DENOMINATION	COP-144	COP-144 S	AD-125	AD-125 S										RECOMENDADOS RECOMMENDED	ELIMINADO ELIMINATED	INTRODUCIDO INTRODUCED	NOTAS / NOTES
1	12165982	CIERRE BRAZO CAPOTA	DISHWASHER ARM LOCK	1	1	1	1													
2	12049214	JUNTA TÓRICA 12.8-3-5	2.8-3-5 SEAL	1	1	1	1													
3	12048366	JUNTA BRAZO CAPOTA	DISHWASHER ARM SEAL	1	1	1	1													
4	12009962	ABRAZAD. Fe-Zn 40-60mm DIN3017	Fe-Zn 40-60mm DIN3017 CLAMP	2	2	2	2													
5	12150658	CONJUNTO BRAZO CAPOTA	DISHWASHER ARM ASSEMBLY	1	1	1	1													
6	12150548	CONDUCCIÓN RAMA SUPERIOR	TOP BRANCH PIPE	1	1	1	1													
7	12023511	RACORD EN Y	Y FORM RACORD	1	1	1	1													
8	12132254	DOSIF. PERISTÁLTICO ABRILLANTADOR	PERISTALTIC POLISHER DISPENSER	1	1	1	1									X				
8a	12132254	TUBO PERISTÁLTICO DOS. ABRILLANTADOR	POLISHER DISP. PERISTALTIC TUBE	1	1	1	1													
9	12164632	PESO FILTRO	FILTER WEIGHT	1	1	1	1													
10	12092499	CONDUCTO ABRILLANTADOR Ø4x6	Ø4x6 POLISHER PIPE	1	1	1	1													
11	12219511	ELECTROVÁLVULA + REGULADOR 4L/min	ELECTROVALVE + 4L/min REGULATOR	1	1	1	1									X				
12	12225749	SOPORTE ELECTROVÁLVULA	ELECTROVALVE SUPPORT	1	1	1	1													
13	12161034	MANGUERA ENTRADA AGUA INTERIOR	INNER WATER INLET HOSE	1	1	1	1													
13	12115397	MANGUERA ENTRADA AGUA INTERIOR	INNER WATER INLET HOSE	1	1	1	1													solo modelos "AU" / "AU" models only
14	12139078	CONDUCTO ASPIRACIÓN	SUCTION PIPE	1	1	1	1													
15	12009914	ABRAZADERA DIN3017 W2 70-90L	DIN3017 W2 70-90L CLAMP	2	2	2	2													
16	12010036	ABRAZAD. Fe-Zn 12-22mm DIN3017	Fe-Zn 12-22mm DIN3017 CLAMP	1	1	1	1													
17	12046080	CONDUCTO IMPULSIÓN ACLARADO	RINSING IMPULSION PIPE	1	1	1	1													
18	12010023	ABRAZAD. Fe-Zn 20-32mm DIN3017	Fe-Zn 20-32mm DIN3017 CLAMP	1	1	1	1													
19	12187518	BOMBA ACLARADO 50Hz	50Hz RINSING PUMP	1	1	1	1									X				solo modelos 50Hz / 50Hz models only
19	12216217	BOMBA ACLARADO 60Hz	60Hz RINSING PUMP	1	1	1	1									X				solo modelos 60Hz / 60Hz models only
20	12023600	CONDENSADOR 400V U VDE	400V UL GREEN CONDENSER	1	1	1	1													
21	12152162	AISLANTE BOMBA ACLARADO	RINSING PUMP INSULATOR	1	1	1	1													
22	12136327	SOPORTE BOMBA ACLARADO	RINSING PUMP BRACKET	1	1	1	1													
23	12009997	ABRAZAD. Fe-Zn 25-40mm DIN3017	Fe-Zn 25-40mm DIN3017 CLAMP	2	2	2	2													
24	12136329	CONDUCTO ASPIRACIÓN BOMBA	RINSING PUMP SUCTION PIPE	1	1	1	1													
25	12225191	SOPORTE MOTOBOMBA 50Hz	50Hz PUMP BRACKET	1	1	1	1													solo modelos 50Hz / 50Hz models only
25	12225194	SOPORTE MOTOBOMBA 60Hz	60Hz PUMP BRACKET	1	1	1	1													solo modelos 60Hz / 60Hz models only
26	12141346	ELECTROPOMPA 50Hz	ELECTRIC PUMP 50Hz	1	1	1	1									X				solo modelos 50Hz / 50Hz models only
26	12210527	ELECTROPOMPA 60Hz	ELECTRIC PUMP 60Hz	1	1	1	1									X				solo modelos 60Hz / 60Hz models only
27	12150482	CONDUCTO IMPULSIÓN	IMPULSION PIPE	1	1	1	1													
28	12009933	ABRAZADERA DIN3017 W2 50-70L	DIN3017 W2 50-70L CLAMP	2	2	2	2													
29	12135783	SOPORTE DISTRIBUIDOR	DISTRIBUTOR SUPPORT	1	1	1	1													
30	12163602	JUNTA SOPORTE DISTRIBUIDOR	DISTRIBUTOR SUPPORT SEAL	1	1	1	1													
31	12150806	ADAPTADOR RAMAS LAVADO	WASHING BRANCHES ADAPTOR	1	1	1	1													
32	12138664	ARANDELA ELÁSTICA	ELASTIC RETAINER	2	2	2	2									X				
33	12104339	TAPÓN TUERCA	NUT CAP	1	1	1	1													
34	12091122	JUNTA AIR BREAK	AIR BREAK SEAL	1	1	1	1													
35	12163791	AIR BREAK	AIR BREAK	1	1	1	1													
36	12171232	EJE ACLARADO RAMAS PLANAS	FLAT BRANCHES RINSING SHAFT	2	2	2	2													
37	12228948	DISTRIBUIDOR ACLARADO COMPLETO	COMPLETE RINSING DISTRIBUTOR	2	2	2	2													
37a	12102984	DISTRIBUIDOR ACLARADO	RINSING DISTRIBUTOR	2	2	2	2													
37b	12041628	PROTECTOR FUGAS	PROTECTOR	4	4	4	4													
38	12228947	DISTRIBUIDOR LAVADO COMPLETO	COMPLETE WASHING DISTRIBUTOR	2	2	2	2													
38a	12003421	DISTRIBUIDOR LAVADO	WASHING DISTRIBUTOR	2	2	2	2													
38b	12023674	ARANDELA AMARRE	CLAMPING RETAINER	2	2	2	2													
38c	12141336	CASQUILLO DISTRIBUIDOR	DISTRIBUTOR BUSHING	2	2	2	2													
39	12138392	EJE ALAVADO	WASHING SHAFT	2	2	2	2													
40	12171233	TUERCA ESPECIAL ACLARADO M12x1.5	M12x1.5 RINSING SPECIAL NUT	2	2	2	2													



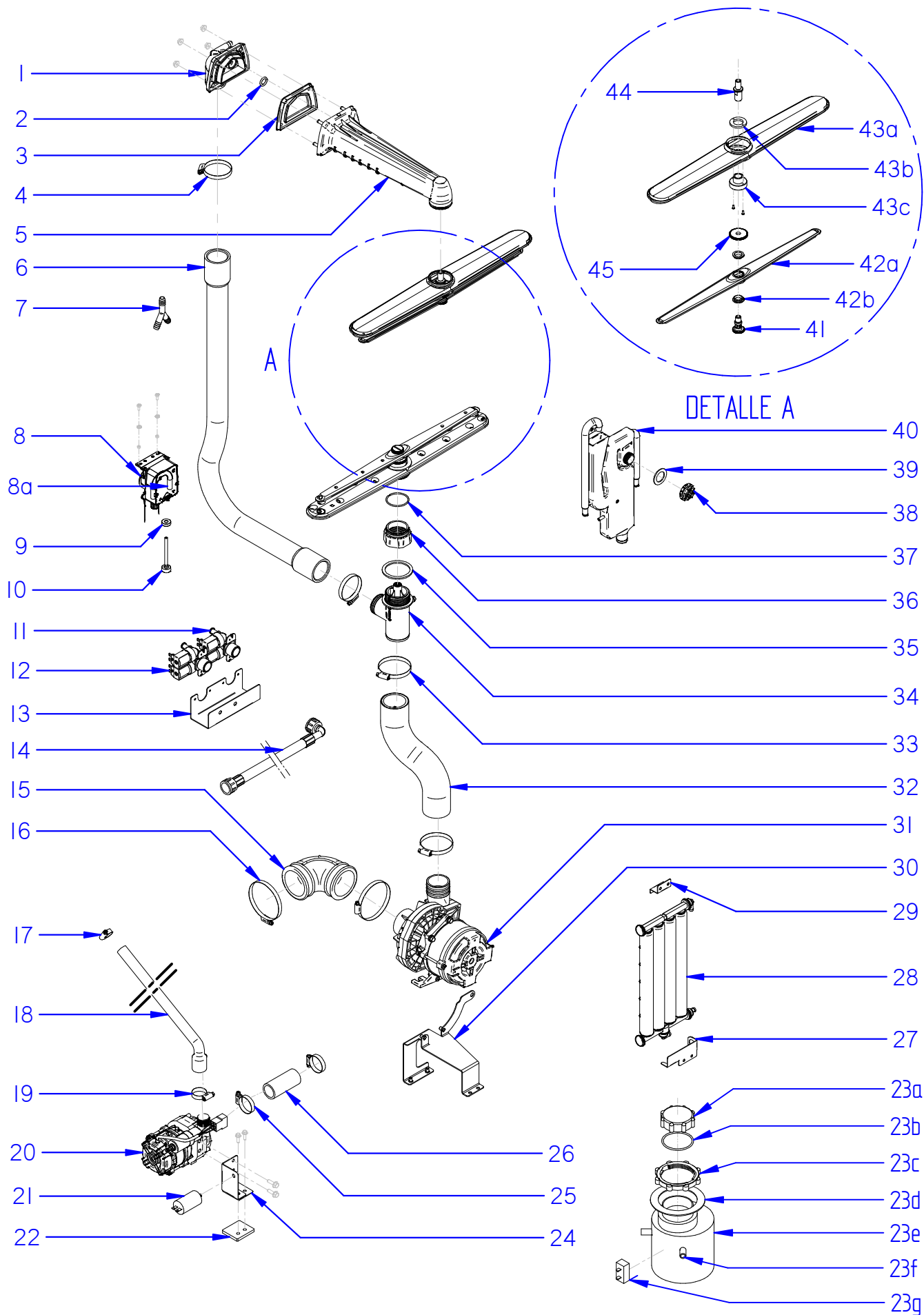

Fecha	Firma	AD-125 SOFT	Página	<b>FAGOR</b>  FAGOR INDUSTRIAL
01-06-2018	B. Alcantara	CONJUNTO HIDRÁULICO (AD SOFT) / HYDRAULIC ASSEMBLY (AD SOFT)	23	

ITEM	CODIGO REFERENCE	DENOMINACIÓN	DENOMINATION	AD-125 SOFT	AD-125 SOFT S													RECOMENDADOS RECOMMENDED	ELIMINADO ELIMINATED	INTRODUCIDO INTRODUCED	NOTAS / NOTES
1	12165982	CIERRE BRAZO CAPOTA	DISHWASHER ARM LOCK	1	1																
2	12049214	JUNTA TÓRICA 12.8-3-5	2.8-3-5 SEAL	1	1																
3	12048366	JUNTA BRAZO CAPOTA	DISHWASHER ARM SEAL	1	1																
4	12009962	ABRAZAD. Fe-Zn 40-60mm DIN3017	Fe-Zn 40-60mm DIN3017 CLAMP	2	2																
5	12150658	CONJUNTO BRAZO CAPOTA	DISHWASHER ARM ASSEMBLY	1	1																
6	12150548	CONDUCCIÓN RAMA SUPERIOR	TOP BRANCH PIPE	1	1																
7	12023511	RACORD EN Y	Y FORM RACORD	1	1																
8	12132254	DOSIF. PERISTÁLTICO ABRILLANTADOR	PERISTALTIC POLISHER DISPENSER	1	1												X				
8a	12230391	TUBO PERISTÁLTICO DOS. ABRILLANTADOR	POLISHER DISP. PERISTALTIC TUBE	1	1																
9	12164632	PESO FILTRO	FILTER WEIGHT	1	1																
10	12092499	CONDUCTO ABRILLANTADOR Ø4x6	Ø4x6 POLISHER PIPE	1	1																
11	12217769	CONJUNTO ELECTROVÁLVULA REGEN.	REGEN. ELECTROVALVE ASSEMBLY	1	1												X				
12	12217768	CONJUNTO ELECTROVÁLVULA ENTRADA	INLET ELECTROVALVE ASSEMBLY	1	1												X				
13	12225770	SOPORTE ELECTROVÁLVULAS	ELECTROVALVES SUPPORT	1	1																
14	12161034	MANGUERA ENTRADA AGUA INTERIOR	INNER WATER INLET HOSE	1	1																
14	12115397	MANGUERA ENTRADA AGUA INTERIOR	INNER WATER INLET HOSE	1	1																solo modelos "AU" / "AU" models only
15	12139078	CONDUCTO ASPIRACIÓN	SUCTION PIPE	1	1																
16	12009914	ABRAZADERA DIN3017 W2 70-90L	DIN3017 W2 70-90L CLAMP	2	2																
17	12010036	ABRAZAD. Fe-Zn 12-22mm DIN3017	Fe-Zn 12-22mm DIN3017 CLAMP	1	1																
18	12046080	CONDUCTO IMPULSIÓN ACLARADO	RINSING IMPULSION PIPE	1	1																
19	12010023	ABRAZAD. Fe-Zn 20-32mm DIN3017	Fe-Zn 20-32mm DIN3017 CLAMP	1	1																
20	12187518	BOMBA ACLARADO 50Hz	50Hz RINSING PUMP	1	1												X				solo modelos 50Hz / 50Hz models only
20	12216217	BOMBA ACLARADO 60Hz	60Hz RINSING PUMP	1	1												X				solo modelos 60Hz / 60Hz models only
21	12023600	CONDENSADOR 400V U VDE	400V UL GREEN CONDENSER	1	1																
22	12152162	AISSANTE BOMBA ACLARADO	RINSING PUMP INSULATOR	1	1																
23	12226075	BOTE DE SALES COMPLETO	COMPLETE SALT CONTAINER	1	1												X				
23a	12025273	TAPON (BITRON 27415.00)	COVER (BITRON 27415.00)	1	1																
23b	12024031	JUNTA TAPON (BITRON 06485.02)	COVER O-RING (BITRON 06485.02)	1	1																
23c	12164597	TUERCA BOTE DE SALES	SALT CONTAINER NUT	1	1																
23d	12047154	JUNTA TUERCA	NUT SEAL	1	1																
23e	12113090	BOTE SALES SENSOR EVCO-21	EVCO-21 SALT CONTAINER	1	1																
23f	12023847	FILTRO (BITRON 06281.01)	FILTER (BITRON 06281.01)	1	1																
23g		REED NIVEL BOTE DE SALES	SALT CONTAINER'S LEVEL REED	1	1																
24	12136327	SOPORTE BOMBA ACLARADO	RINSING PUMP SUPPORT	1	1																
25	12009997	ABRAZAD. Fe-Zn 25-40mm DIN3017	Fe-Zn 25-40mm DIN3017 CLAMP	2	2																
26	12136329	CONDUCTO ASPIRACIÓN BOMBA	RINSING PUMP SUCTION PIPE	1	1																
27	12222762	SOPORTE INFERIOR DESCALCIFICADOR	SOFTENER BOTTOM SUPPORT	1	1																
28	12024874	DESCALCIFICADOR 4 COLUMNAS	4 COLUMN SOFTENER	1	1												X				
29	12222761	SOPORTE SUPERIOR DESCALCIFICADOR	SOFTENER TOP SUPPORT	1	1																
30	12225191	SOPORTE MOTOBOMBA 50Hz	50Hz PUMP SUPPORT	1	1												X				solo modelos 50Hz / 50Hz models only
30	12225194	SOPORTE MOTOBOMBA 60Hz	60Hz PUMP SUPPORT	1	1												X				solo modelos 60Hz / 60Hz models only
31	12141346	ELECTROPOMPA 50Hz	ELECTRIC PUMP 50Hz	1	1												X				solo modelos 50Hz / 50Hz models only
31	12210527	ELECTROPOMPA 60Hz	ELECTRIC PUMP 60Hz	1	1												X				solo modelos 60Hz / 60Hz models only
32	12150482	CONDUCTO IMPULSIÓN	IMPULSION PIPE	1	1																
33	12009933	ABRAZADERA DIN3017 W2 50-70L	DIN3017 W2 50-70L CLAMP	2	2																
34	12135783	SOPORTE DISTRIBUIDOR	DISTRIBUTOR SUPPORT	1	1																
35	12163602	JUNTA SOPORTE DISTRIBUIDOR	DISTRIBUTOR SUPPORT SEAL	1	1																
36	12150806	ADAPTADOR RAMAS LAVADO	WASHING BRANCHES ADAPTOR	1	1																

## LAVAVAJILLAS / DISHWASHER

**CONJUNTO HIDRÁULICO (AD SOFT) / HYDRAULIC ASSEMBLY (AD SOFT)**

[illegible]

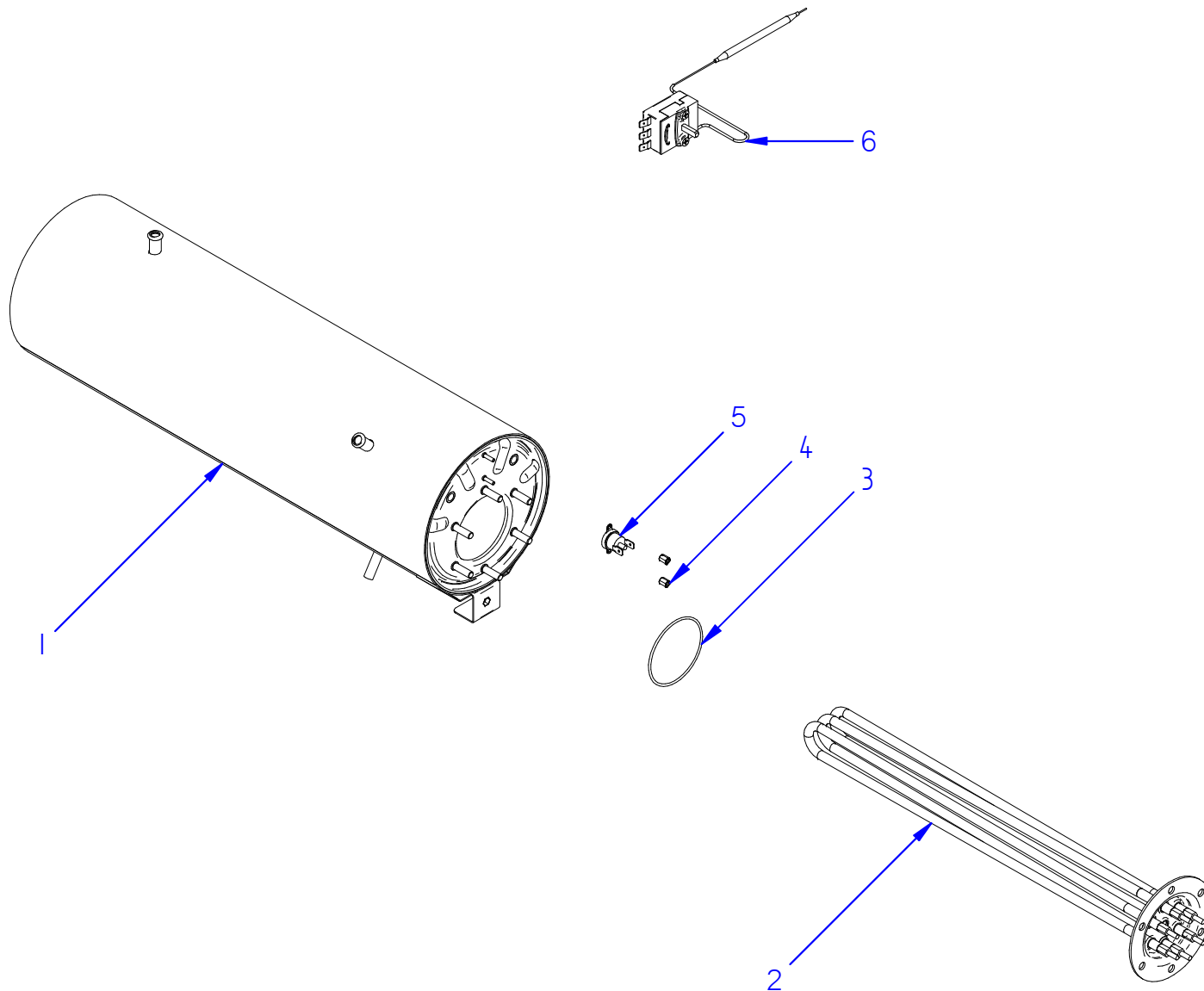



Fecha	Firma	CO_110-142	Página	<b>FAGOR</b>  FAGOR INDUSTRIAL
01-06-2018	B. Alcantara	CALDERÍN (CO) / HEATER (CO)	26	

## LAVAVAJILLAS / DISHWASHER

CALDERÍN (CO) / HEATER (CO)
-----------------------------

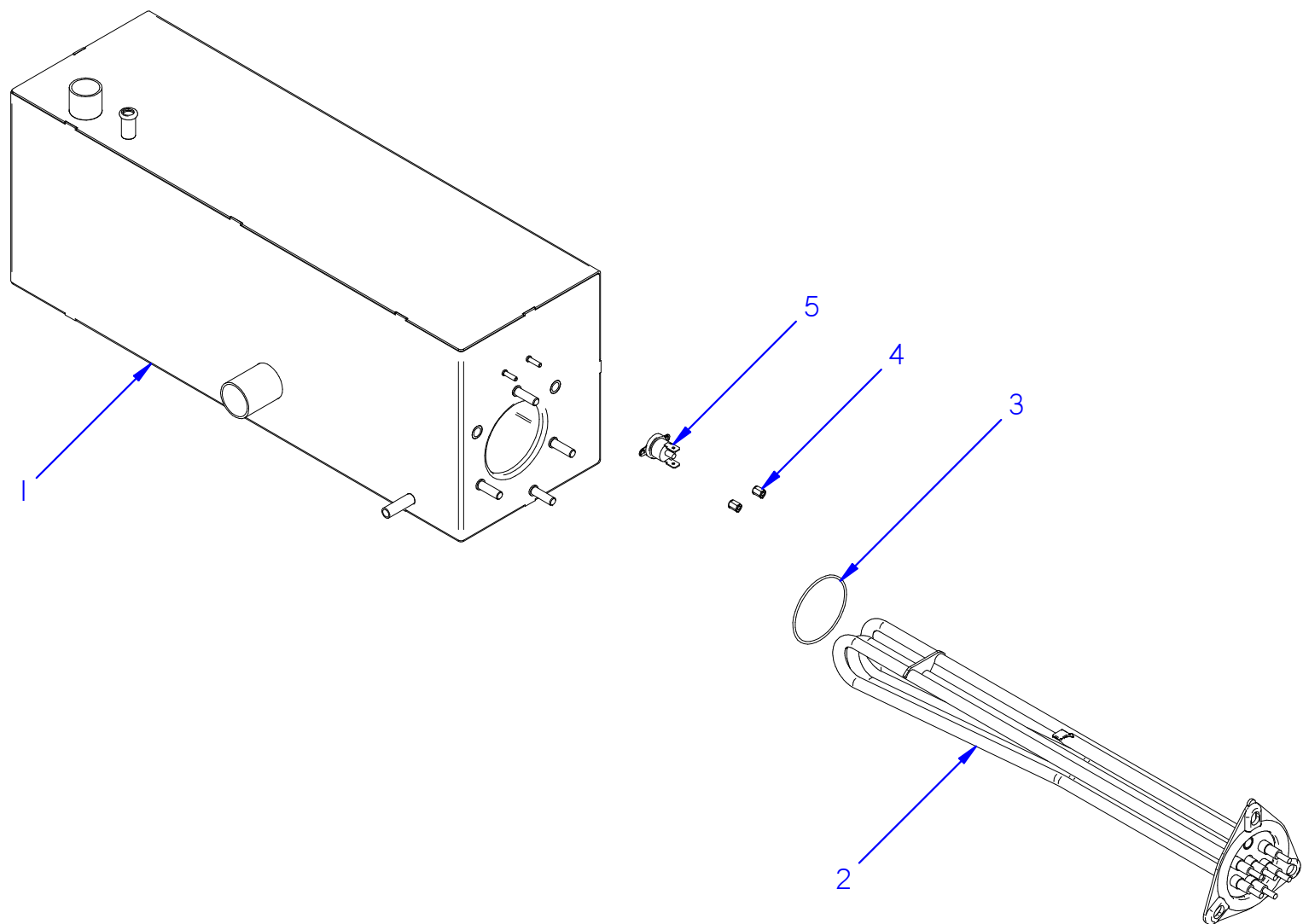
[illegible]



Fecha	Firma	COP-I44; AD-I25	Página	<b>FAGOR</b>  FAGOR INDUSTRIAL
01-06-2018	B. Alcantara	CALDERÍN (COP-AD) / HEATER (COP-AD)	28	

## LAVAVAJILLAS / DISHWASHER

CALDERÍN (COP-AD) / HEATER (COP-AD)
-------------------------------------

[illegible]

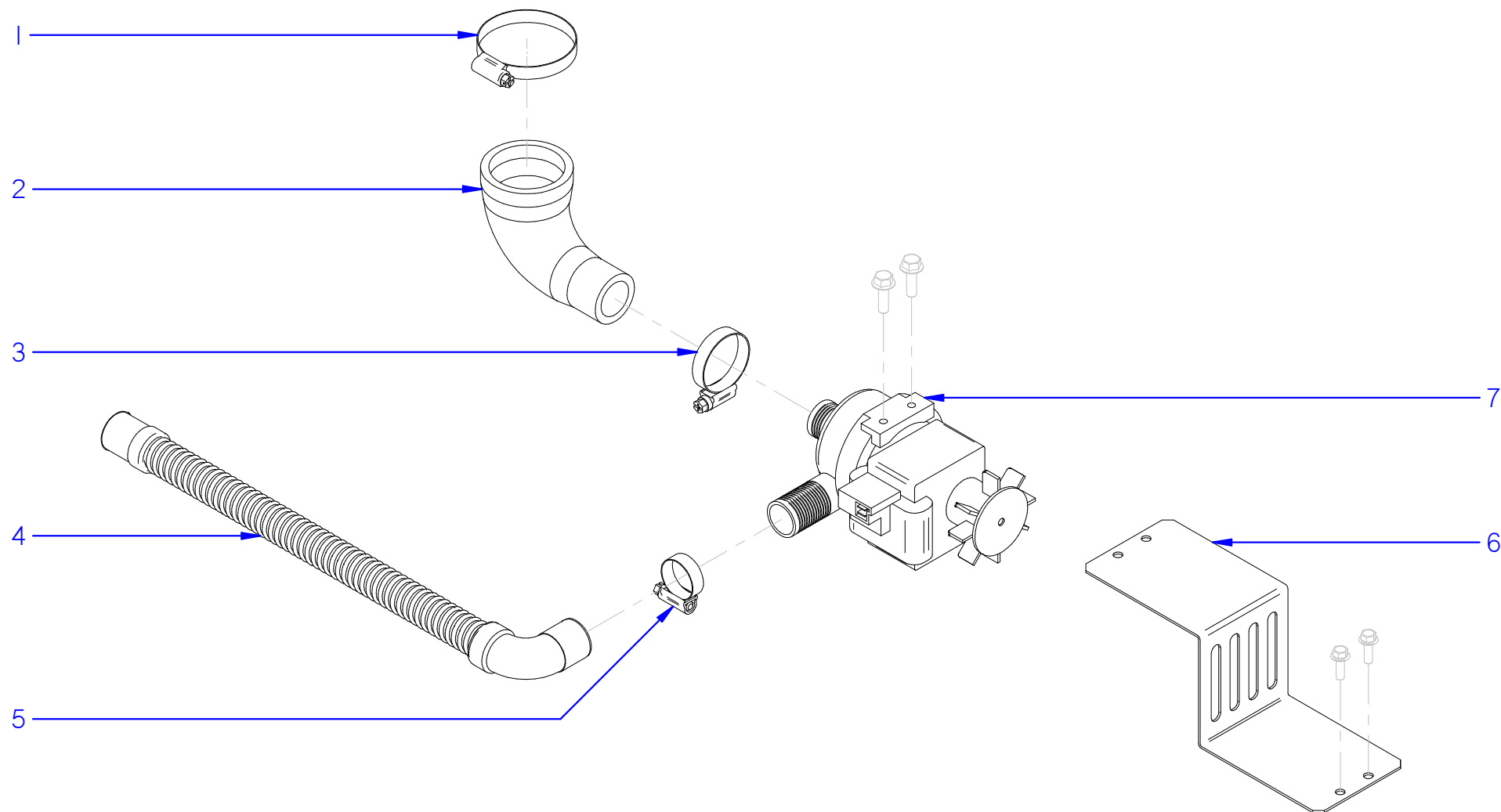

\*KIT OPCIONAL EN MODELOS CO-COP

Fecha	Firma	CO-I10-I42; COP-I44	Página	<b>FAGOR</b>  <small>FAGOR INDUSTRIAL</small>
01-06-2018	B. Alcantara	KIT BOMBA DESAGÜE / DRAINAGE PUMP KIT	30	



## LAVAVAJILLAS / DISHWASHER

## KIT BOMBA DESAGÜE (BD) / DRAINAGE PUMP KIT (BD)

[illegible]

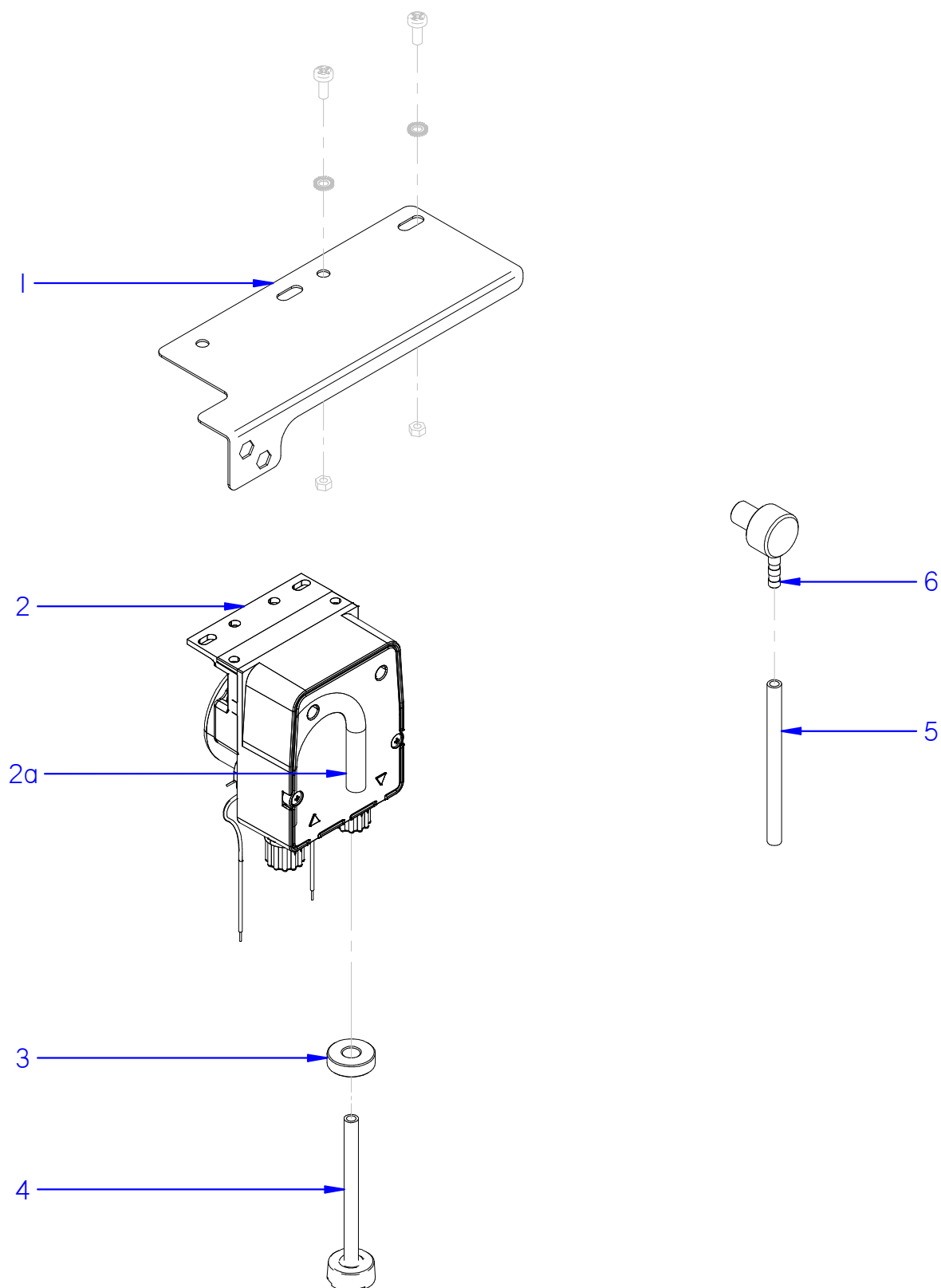

\*INCLUIDO EN MODELOS AD  
 \*KIT OPCIONAL EN MODELOS CO-COP

Fecha	Firma	CO-110-142; COP-144; AD-125	Página	<b>FAGOR</b>  <small>FAGOR INDUSTRIAL</small>
01-06-2018	B. Alcantara	KIT DOSIFICADOR DETERGENTE / SOAP DISPENSER KIT	32	

**APARATO /  
APPLIANCE**

## LAVAVAJILLAS / DISHWASHER

**ZONA / ZONE****KIT DOSIFICADOR DETERGENTE (DD) / SOAP DISPENSER KIT (DD)**[illegible]

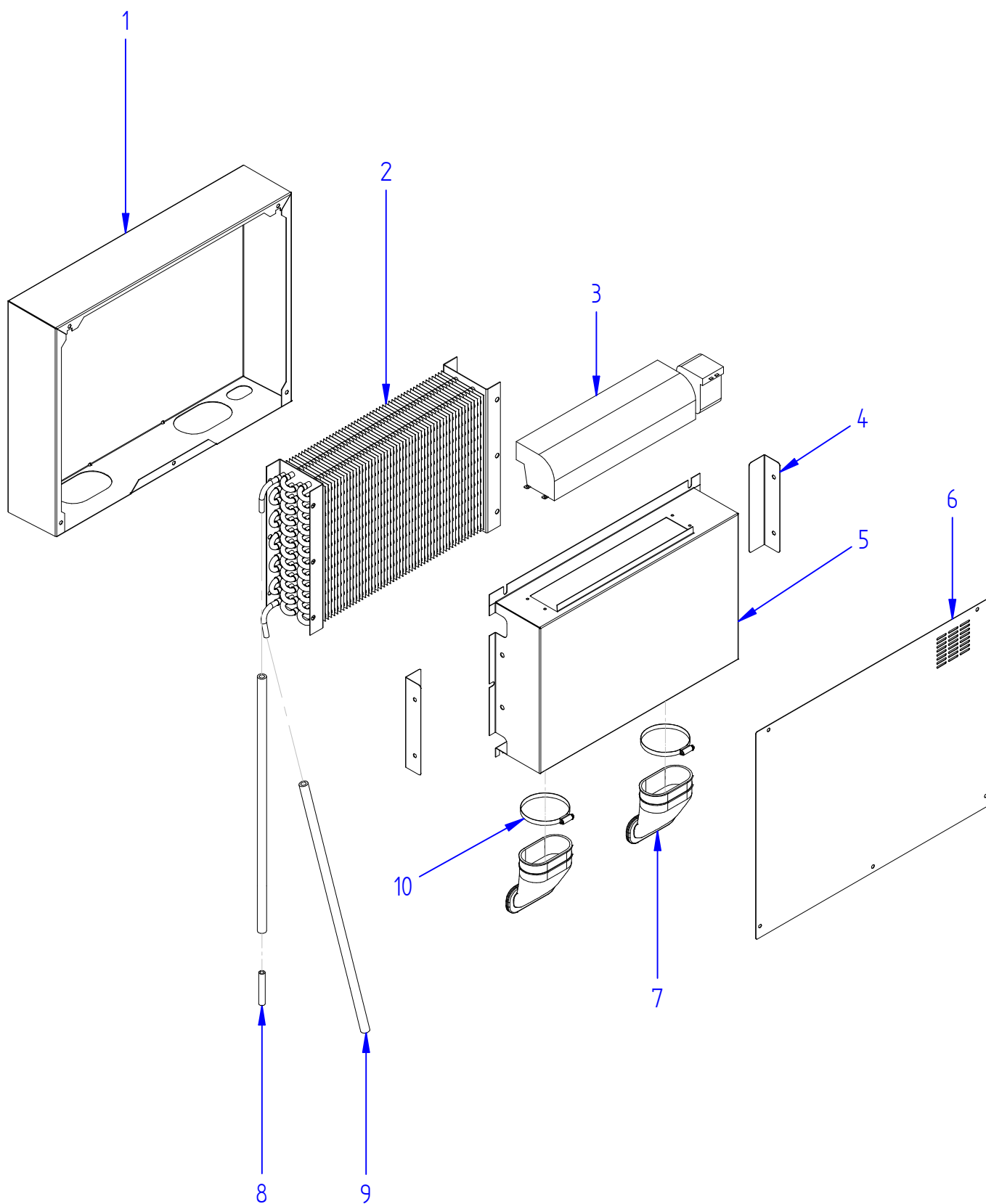

Fecha	Firma	VERSIONES HRS / HRS VERSIONS	Página	<b>FAGOR</b>  FAGOR INDUSTRIAL
01-06-2018	B. Alcantara	HEAT RECOVERY SYSTEM	34	

## LAVAVAJILLAS / DISHWASHER

KIT HRS / HRS KIT

[illegible]

[illegible]

**APARATO /  
APPLIANCE**
**LAVAVAJILLAS / DISHWASHER**
**ZONA / ZONE**
**REPUESTOS RECOMENDADOS / RECOMMENDED SPARE PARTS**

ITEM	CODIGO REFERENCE	DENOMINACIÓN	DENOMINATION	CO-110	CO-142	CO-142 S	COP-144	COP-144 S	AD-125	AD-125 S	AD-125 SOFT	AD-125 SOFT S						ELIMINADO ELIMINATED	INTRODUCIDO INTRODUCED	ZONA / ZONE
2	12123407	PRESOSTATO 0,01bar SIMPLE UL	PRESSURE GAUGE 0,01bar Simple UL	1	-	-	-	-	-	-	-	-								portamandos (CO-110) / control holder (CO-110)
3	12189021	TARJETA CONTROL 230V AC 50/60Hz	CONTROL CARD 230V AC 50/60Hz	1	-	-	-	-	-	-	-	-								portamandos (CO-110) / control holder (CO-110)
2	12123407	PRESOSTATO 0,01bar SIMPLE UL	PRESSURE GAUGE 0,01bar Simple UL	-	1	1	-	-	-	-	-	-								portamandos (CO-142) / control holder (CO-142)
3	12185533	TARJETA CONTROL 230V AC 50/60Hz	CONTROL CARD 230V AC 50/60Hz	-	1	1	-	-	-	-	-	-								portamandos (CO-142) / control holder (CO-142)
5	12025036	CONJUNTO Sonda 64KOhm NTC	PROBE ASSEMBLY 64KOhm NTC	-	2	2	-	-	-	-	-	-								portamandos (CO-142) / control holder (CO-142)
19	12024028	VISUALIZADOR	DISPLAY	-	1	1	-	-	-	-	-	-								portamandos (CO-142) / control holder (CO-142)
2	12023803	PRESOSTATO 1,3-2,8bar SIMPLE UL	PRESSURE GAUGE 1,3-2,8bar Simple UL	-	-	-	1	1	-	-	-	-								portamandos (COP) / control holder (COP)
3	12123407	PRESOSTATO 0,01bar SIMPLE UL	PRESSURE GAUGE 0,01bar Simple UL	-	-	-	1	1	-	-	-	-								portamandos (COP) / control holder (COP)
4	12185533	TARJETA CONTROL 230V AC 50/60Hz	CONTROL CARD 230V AC 50/60Hz	-	-	-	1	1	-	-	-	-								portamandos (COP) / control holder (COP)
6	12025036	CONJUNTO Sonda 64KOhm NTC	PROBE ASSEMBLY 64KOhm NTC	-	-	-	2	2	-	-	-	-								portamandos (COP) / control holder (COP)
20a	12024028	VISUALIZADOR	DISPLAY	-	-	-	1	1	-	-	-	-								portamandos (COP) / control holder (COP)
3	12042019	PRESOSTATO 0,3bar SIMPLE UL	PRESSURE GAUGE 0,3bar Simple UL	-	-	-	-	-	2	2	-	-								portamandos (AD) / control holder (AD)
4	12189023	TARJETA CONTROL 230V AC 50/60Hz	CONTROL CARD 230V AC 50/60Hz	-	-	-	-	-	1	1	-	-								portamandos (AD) / control holder (AD)
6	12025036	CONJUNTO Sonda 64KOhm NTC	PROBE ASSEMBLY 64KOhm NTC	-	-	-	-	-	2	2	-	-								portamandos (AD) / control holder (AD)
17	12120189	CONTROL TARJETA 12V DC 6rel UL	CARD CONTROL 12V DC 6rel UL	-	-	-	-	-	1	1	-	-								portamandos (AD) / control holder (AD)
21b	12048027	VISUALIZADOR	DISPLAY	-	-	-	-	-	1	1	-	-								portamandos (AD) / control holder (AD)
3	12048748	JUNTA TÓRICA 37x32x2.5	O-RING 37x32x2.5	1	1	1	1	1	-	-	-	-								componenetes cuba (CO-COP) / tank parts (CO-COP)
11	12166900	CÁMARA PRESOSTATO	PRESSURE GAUGE CHAMBER	1	1	1	1	1	-	-	-	-								componenetes cuba (CO-COP) / tank parts (CO-COP)
12	12024049	SOPORTE TERMOSTATO	THERMOSTAT SUPPORT	1	1	1	1	1	-	-	-	-								componenetes cuba (CO-COP) / tank parts (CO-COP)
13	12161299	TERMOSTATO TECASA 60°C	60°C TECA THERMOSTAT	1	1	1	1	1	-	-	-	-								componenetes cuba (CO-COP) / tank parts (CO-COP)
14	12045886	RESISTENCIA TRIPLE 230V 4,5Kw UL	230V 4,5Kw UL TRIPLE RESISTOR	1	1	1	1	1	-	-	-	-								componenetes cuba (CO-COP) / tank parts (CO-COP)
17	12096597	TERMOSTATO SEG. 110°C FAST 90	110°C FAST 90 SAFETY THERMOSTAT	1	1	1	1	1	-	-	-	-								componenetes cuba (CO-COP) / tank parts (CO-COP)
7	12166900	CÁMARA PRESOSTATO	PRESSURE GAUGE CHAMBER	-	-	-	-	-	1	1	-	-								componenetes cuba (AD) / tank parts (AD)
8	12024049	SOPORTE TERMOSTATO	THERMOSTAT SUPPORT	-	-	-	-	-	1	1	-	-								componenetes cuba (AD) / tank parts (AD)
9	12150959	RESISTENCIA TRIPLE 230V 2,1Kw UL	230V 2,1Kw UL TRIPLE RESISTOR	-	-	-	-	-	1	1	-	-								componenetes cuba (AD) / tank parts (AD)
11	12096597	TERMOSTATO SEG. 110°C FAST 90	110°C FAST 90 SAFETY THERMOSTAT	-	-	-	-	-	1	1	-	-								componenetes cuba (AD) / tank parts (AD)
6	12023456	BOMBA DESAGÜE	DRAINAGE PUMP	-	-	-	-	-	1	1	-	-								conjunto desagüe (AD) / drainage assembly (AD)
8	12024568	VÁLVULA ANTIRRETORNO	CHECK VALVE	1	1	1	-	-	-	-	-	-								conjunto hidráulico (CO) / hydraulic assembly (CO)
11	12133010	DOSIFICADOR ABRILLANTADOR	POLISHER DISPENSER	1	1	1	-	-	-	-	-	-								conjunto hidráulico (CO) / hydraulic assembly (CO)
12	12219512	CONJUNTO ELECTROV. + REGULADOR	ELECTROV. + REGULATOR ASSEMBLY	1	1	1	-	-	-	-	-	-								conjunto hidráulico (CO) / hydraulic assembly (CO)
18	12141346	ELECTROPOMPA 50Hz	ELECTRIC PUMP 50Hz	1	1	1	-	-	-	-	-	-								conjunto hidráulico (CO) / hydraulic assembly (CO)
18	12210527	ELECTROPOMPA 60Hz	ELECTRIC PUMP 60Hz	1	1	1	-	-	-	-	-	-								conjunto hidráulico (CO) / hydraulic assembly (CO)
24	12138664	ARANDELA ELÁSTICA	ELASTIC RETAINER	2	2	2	-	-	-	-	-	-								conjunto hidráulico (CO) / hydraulic assembly (CO)
27	12024252	TOBERA ACLARADO	RINSING NOZZLE	12	12	12	-	-	-	-	-	-								conjunto hidráulico (CO) / hydraulic assembly (CO)
8	12132254	DOSIF. PERISTÁLTICO ABRILLANTADOR	PERISTALTIC POLISHER DISPENSER	-	-	-	1	1	1	1	-	-								conjunto hidráulico (COP-AD) / hydraulic assembly (COP-AD)
11	12219511	ELECTROVÁLVULA + REGULADOR 4L/min	ELECTROVALVE + 4L/min REGULATOR	-	-	-	1	1	1	1	-	-								conjunto hidráulico (COP-AD) / hydraulic assembly (COP-AD)
19	12187518	BOMBA ACLARADO 50Hz	50Hz RINSING PUMP	-	-	-	1	1	1	1	-	-								conjunto hidráulico (COP-AD) / hydraulic assembly (COP-AD)
19	12216217	BOMBA ACLARADO 60Hz	60Hz RINSING PUMP	-	-	-	1	1	1	1	-	-								conjunto hidráulico (COP-AD) / hydraulic assembly (COP-AD)
26	12141346	ELECTROPOMPA 50Hz	ELECTRIC PUMP 50Hz	-	-	-	1	1	1	1	-	-								conjunto hidráulico (COP-AD) / hydraulic assembly (COP-AD)
26	12210527	ELECTROPOMPA 60Hz	ELECTRIC PUMP 60Hz	-	-	-	1	1	1	1	-	-								conjunto hidráulico (COP-AD) / hydraulic assembly (COP-AD)
32	12138664	ARANDELA ELÁSTICA	>	-	-	-	2	2	2	2	-	-								conjunto hidráulico (COP-AD) / hydraulic assembly (COP-AD)
8	12132254	DOSIF. PERISTÁLTICO ABRILLANTADOR	PERISTALTIC POLISHER DISPENSER	-	-	-	-	-	-	-	1	1								conjunto hidráulico (AD SOFT) / hydraulic assembly (AD SOFT)
11	12217769	CONJUNTO ELECTROVÁLVULA REGEN.	REGEN. ELECTROVALVE ASSEMBLY	-	-	-	-	-	-	-	1	1								conjunto hidráulico (AD SOFT) / hydraulic assembly (AD SOFT)
12	12217768	CONJUNTO ELECTROVÁLVULA ENTRADA	INLET ELECTROVALVE ASSEMBLY	-	-	-	-	-	-	-	1	1								conjunto hidráulico (AD SOFT) / hydraulic assembly (AD SOFT)
20	12187518	BOMBA ACLARADO 50Hz	50Hz RINSING PUMP	-	-	-	-	-	-	-	1	1								conjunto hidráulico (AD SOFT) / hydraulic assembly (AD SOFT)
20	12216217	BOMBA ACLARADO 60Hz	60Hz RINSING PUMP	-	-	-	-	-	-	-	1	1								conjunto hidráulico (AD SOFT) / hydraulic assembly (AD SOFT)
23	12226075	BOTE DE SALES COMPLETO	COMPLETE SALT CONTAINER	-	-	-	-	-	-	-	1	1								conjunto hidráulico (AD SOFT) / hydraulic assembly (AD SOFT)

**FAGOR**   
FAGOR INDUSTRIAL





# CO-502

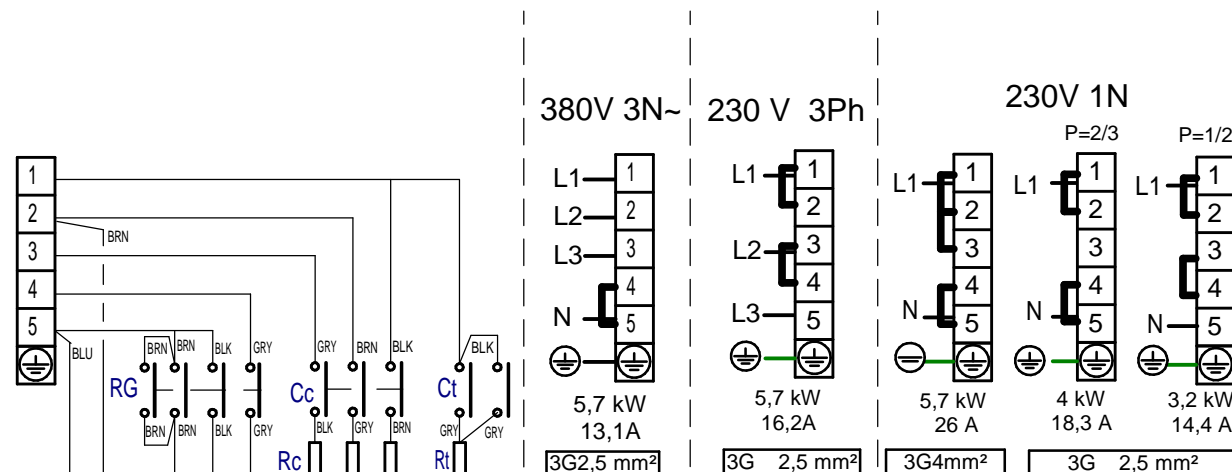

# CO-402

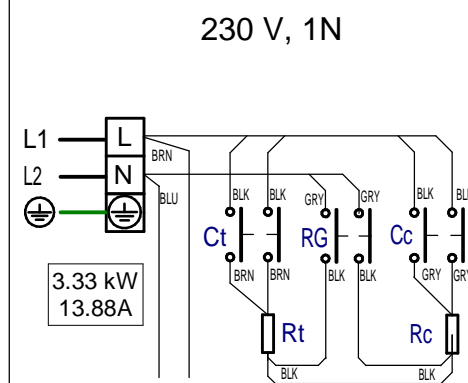

# CO-142

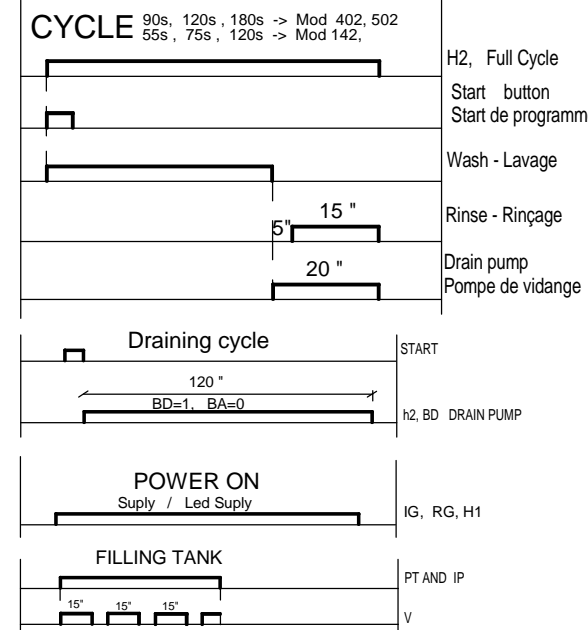
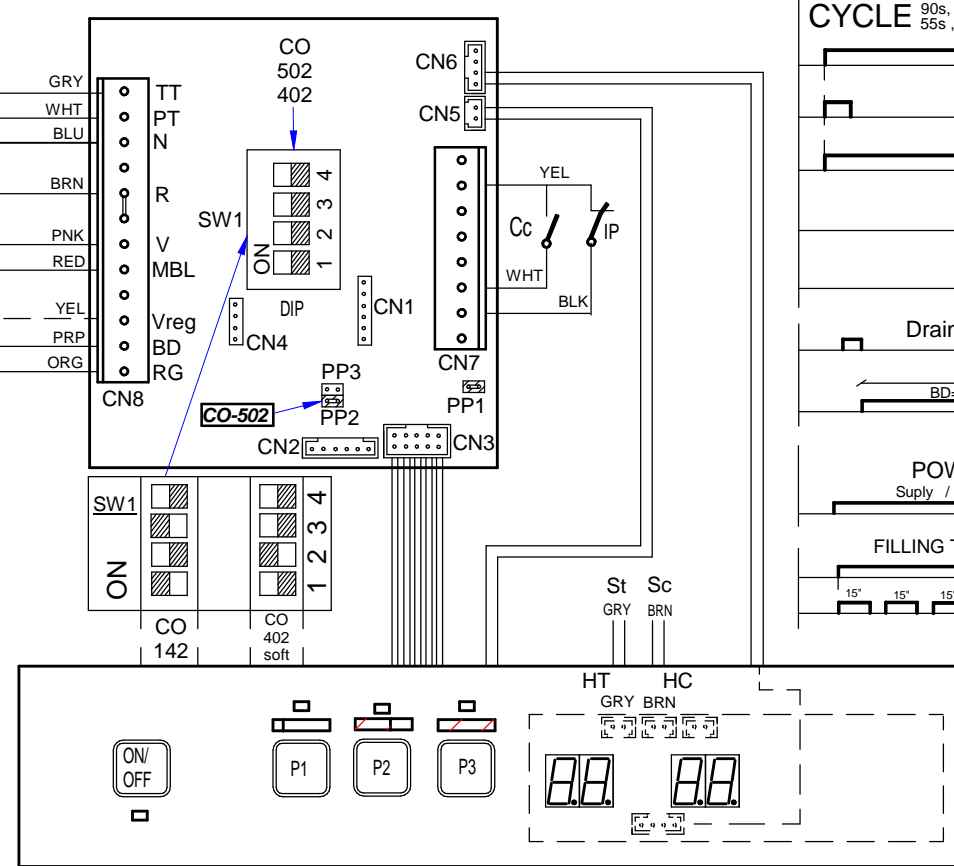
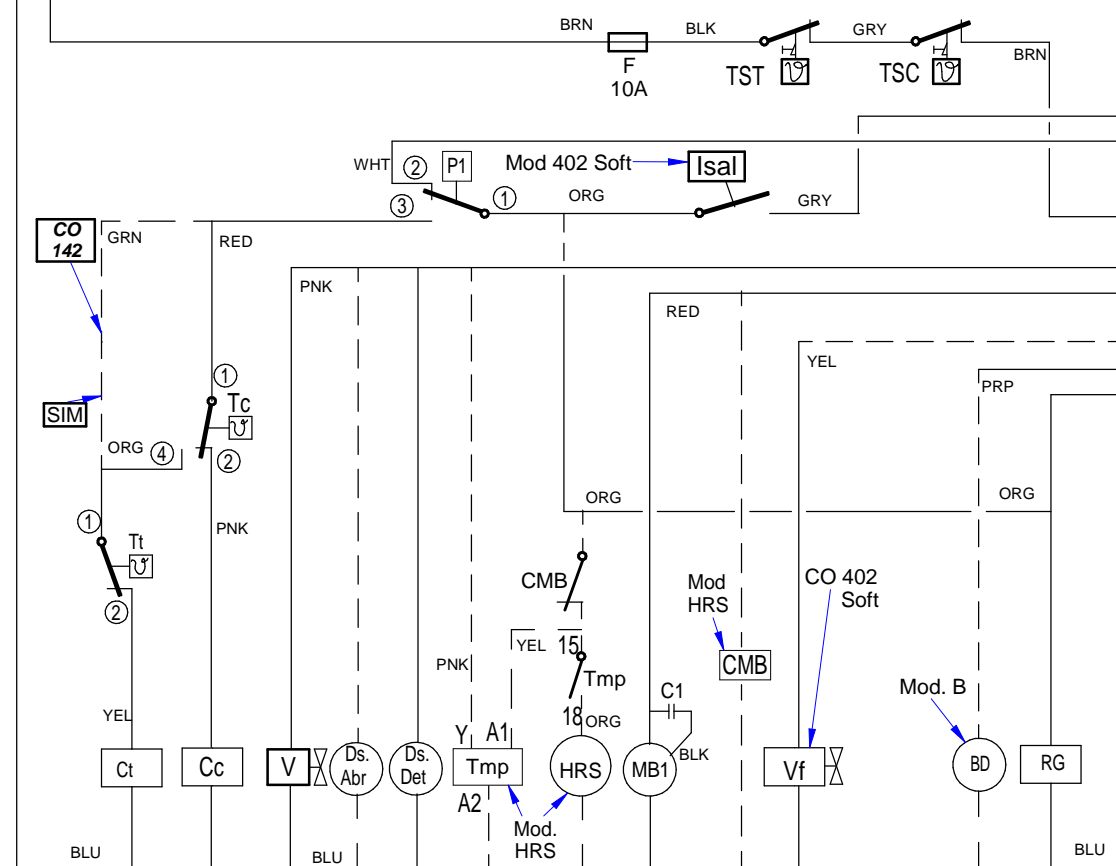
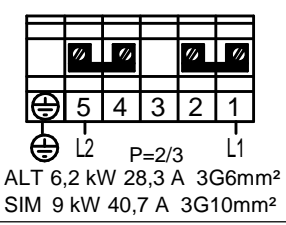
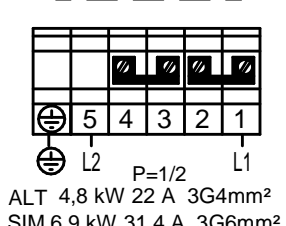
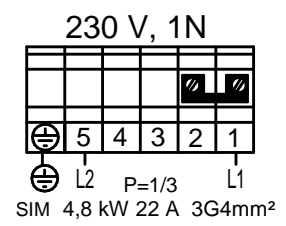
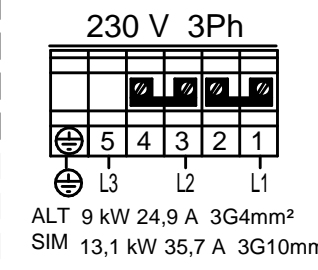
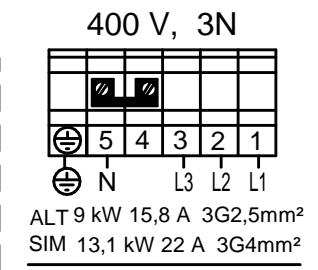
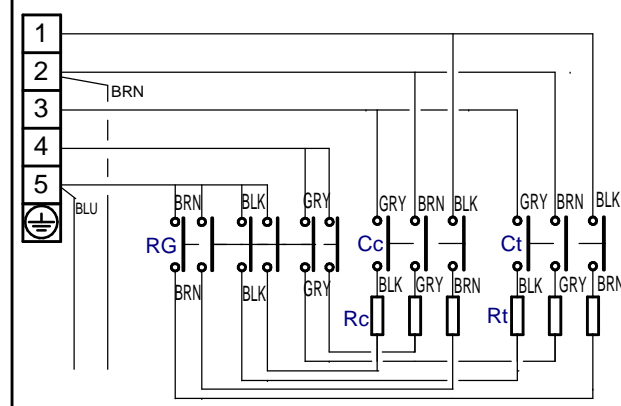

12121300

# COP-504

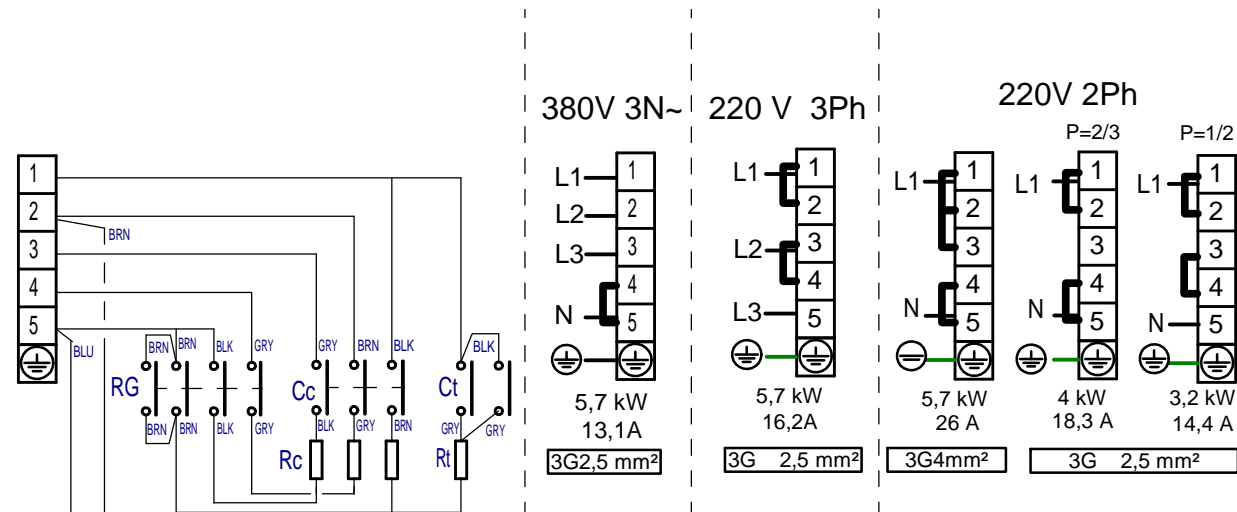

# COP-144

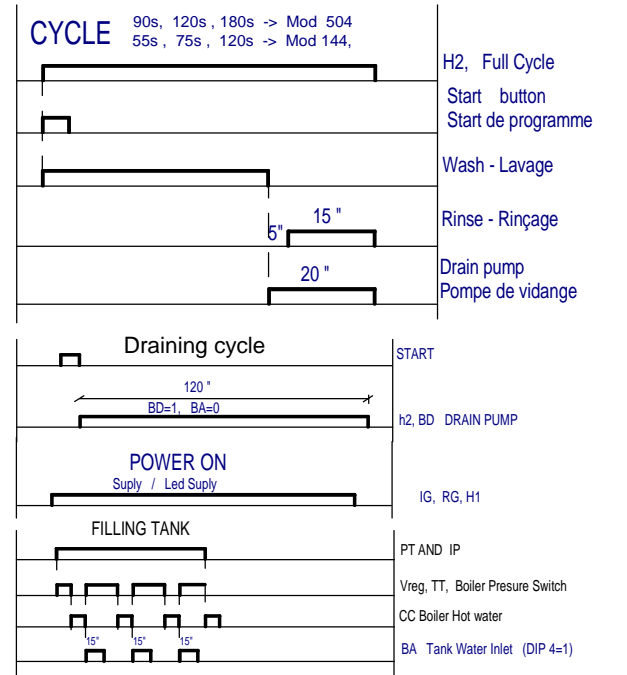
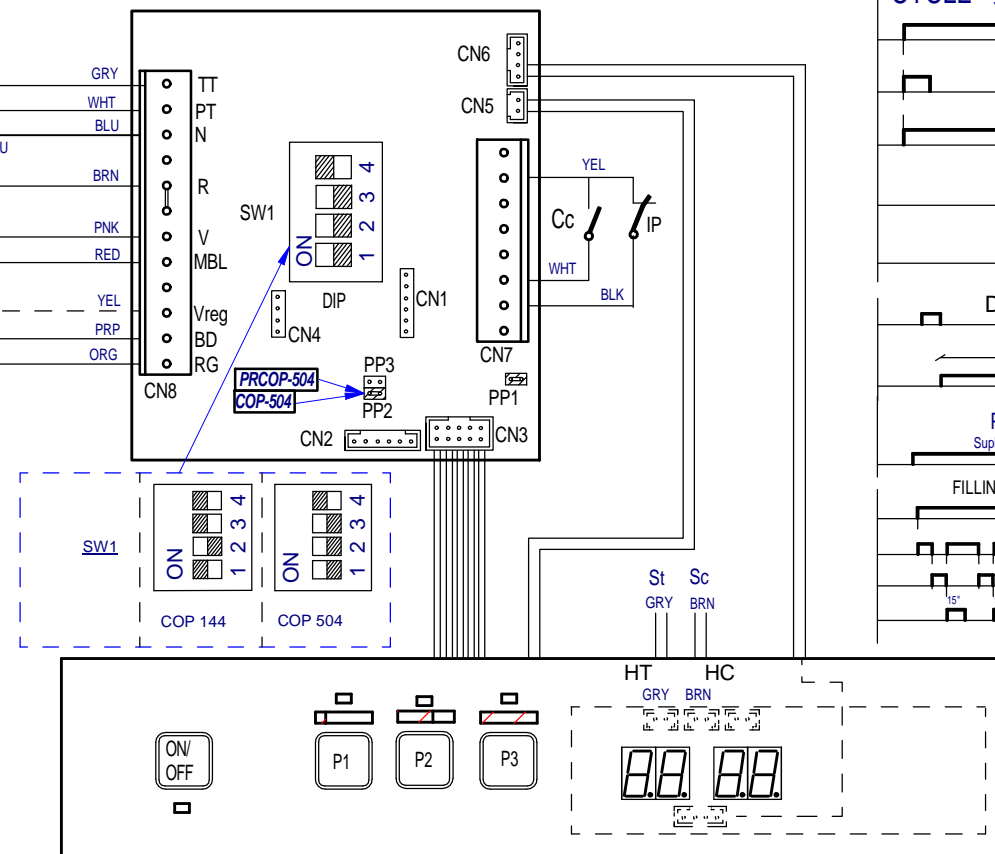
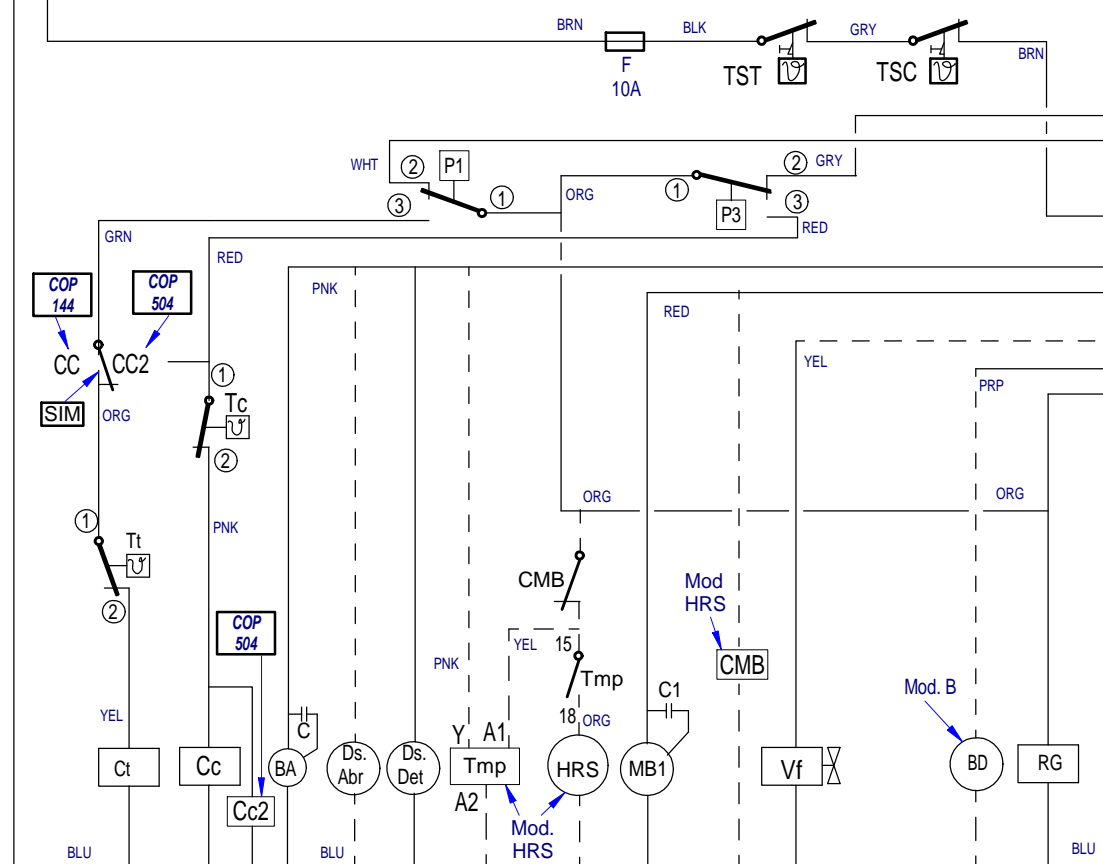
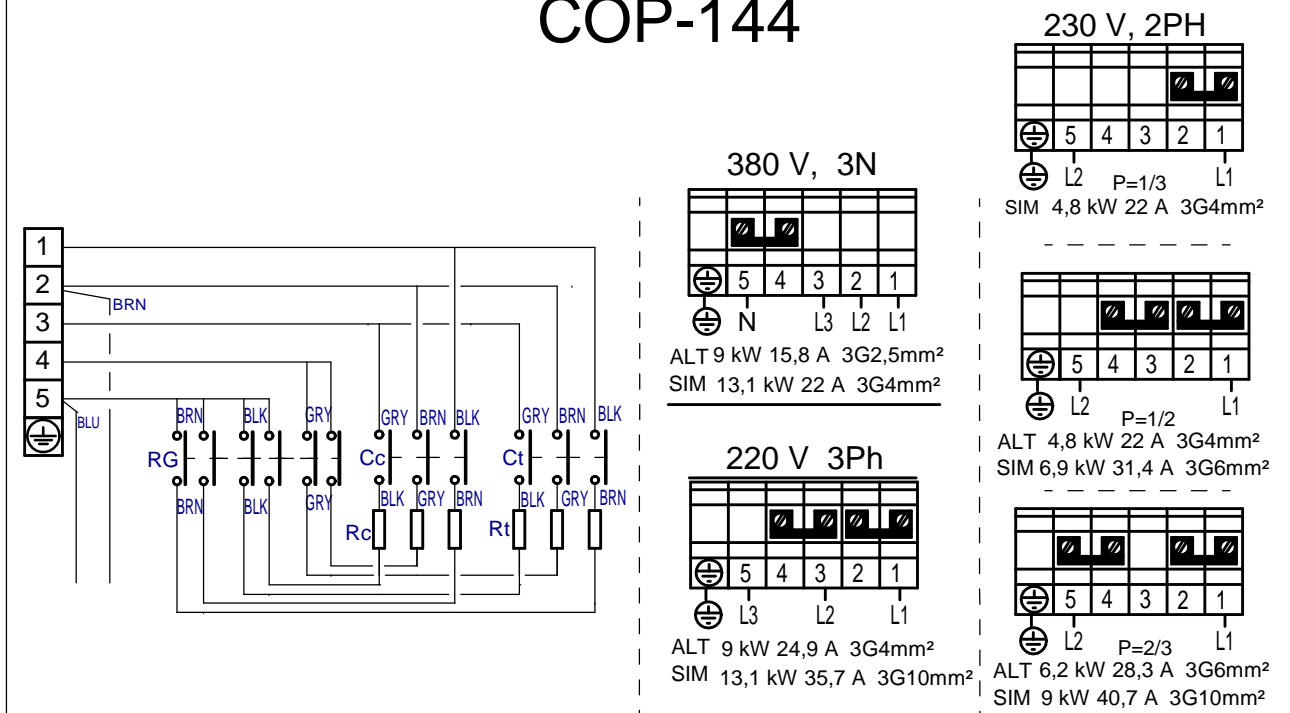

12218817

# AD 125, 505

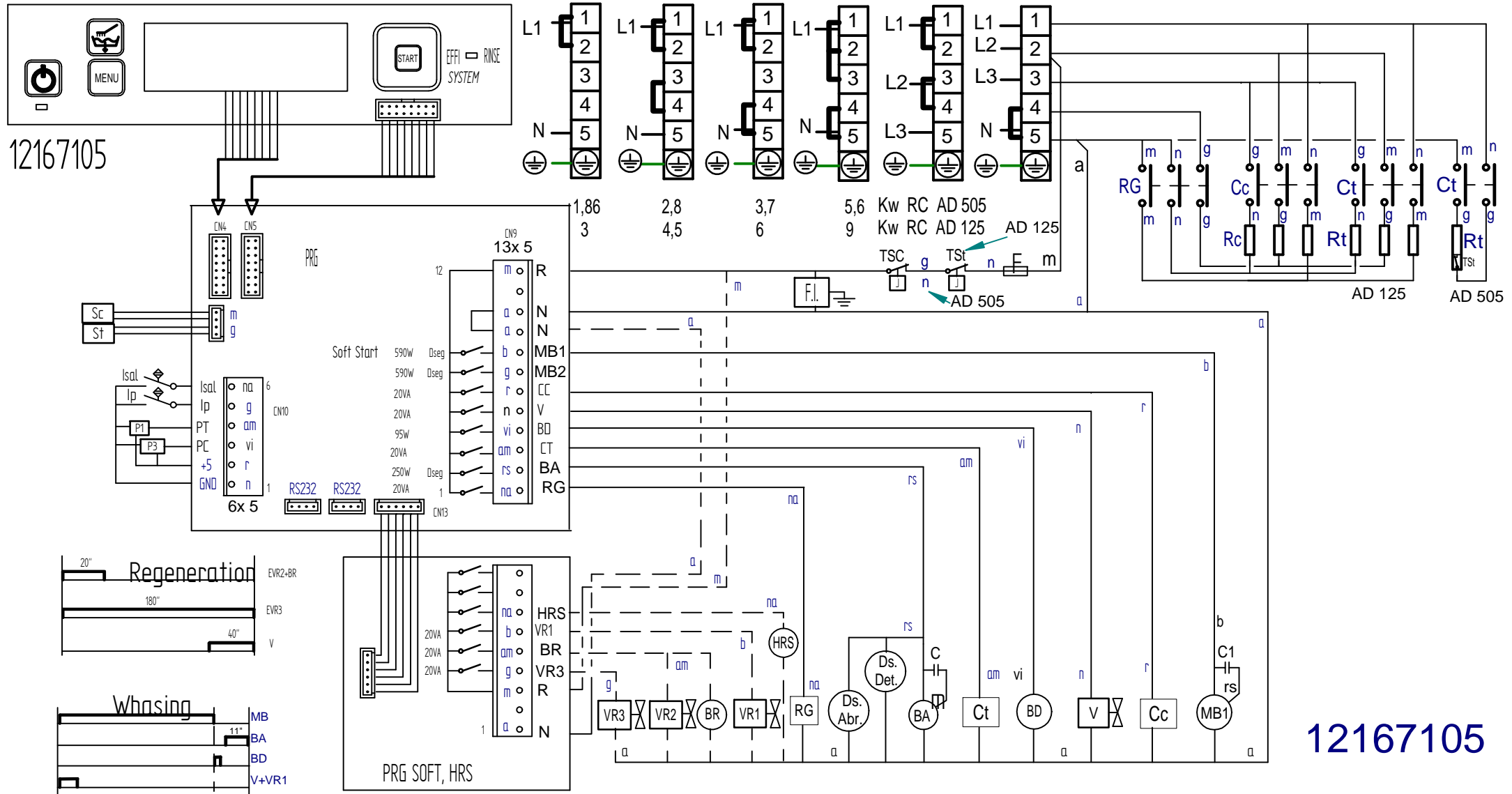

Simb / LENG		ESPAÑOL	ENGLISH	FRANÇAIS
A,B (CCO)	=	Puntos de conexión con K1	Connection points with K1	Points de connexion K1
C1,C2,C3,C4	=	Condensador electrico	Electric condenser	Condensateur électrique
CA	=	Rele Auxiliar de Aclarado	Rinse Auxiliary Relay	Relais auxiliaire rinçage
CMBL1,2	=	Contactador Bomba lavado 1,2	Wash 1,2 Pump Contactor	Contacteur pompe lavage 1.2
CMBPL	=	Contactador Bomba PreLavado	Prewash Pump Contactor	Contacteur Pompe prélavage
CMEV	=	Contactador Motor Extractor de Vahos	Steam Exhaust Motor Contactor	Contacteur Moteur Extraction vapeur
CMS	=	Contactador Motor Secado	Drying Motor Contactor	Contacteur moteur Séchage
CMREC	=	Contactador Motor Recuperador	Recover Motor Thermal Overload	Contacteur moteur Recuperateur
CRC11,12,13	=	Contactador Calentamiento Calderin	Boiler Heating Contactor	Contacteur Chauffage Chaudière
CRS11,12,21,22	=	Contactador Calentamiento Secado 1,2	Drying 1, 2 Heating Contactor	Contacteur chauffage séchage 1.2
CRTA1,2	=	Contactador Calentamiento Aclarado	Rinse heating Contactor	Contacteur chauffage Rinçage
CRT11,12	=	Contactador Calentamiento Tanque 1	Tank 1 Heating Contactor	Contacteur Chauffage Cuve 1
CRT21,22	=	Contactador Calentamiento Tanque 2	Tank 2 Heating Contactor	Contacteur Chauffage Cuve 2
DS.ABR	=	Dosificador Abrillantador	Rinse doser	Doseur tensoactive
DS.DET	=	Dosificador Detergente	Detergent doser	Doseur détergent
F	=	Fusible	Fuse	Fusible
FMEV	=	Termico Motor Extractor	Steam Exhaust Motor Thermal Overload	Thermique Moteur Extraction vapeur
FML1,2	=	Termico Motor Bomba Lavado1,2	Wash 1,2 Pump Motor Thermal Overload	Thermique Moteur pompe lavage 1.2
FMS1,2	=	Termico Motor Secado 1,2	Drying Motor Thermal Overload	Thermique du Moteur Séchage
FMREC	=	Termico Motor Recuperador	Recover Motor Thermal Overload	Thermique du Moteur Recuperateur
H1	=	Lampara Indicador Marcha	Operation light	Voyant de fonctionnement
H2	=	Lampara Indicador Atorado	Stuck Indicator Lamp	Voyant Bloqués
IA	=	Interruptor Accionamiento Aclarado	Rinsing actuator Switch	Interrupteur d'actionneur de rinçage
IE1,2	=	Pulsador Parada de emergencia 1,2	Emergency 1,2 stop push button	Bouton-poussoir Arrêt d'urgence 1,2
IG	=	Interruptor general.	Power On	Interrupteur général
IGS	=	Interruptor General de seguridad.	Disconnect Switch	Interrupteur Général de sécurité
IL	=	Interruptor Accionamiento Lavado	Wash actuator Switch	Interrupteur d'actionneur de lavage
IM / IP	=	Pulsador Marcha / Parada	Start / Stop push button	Bouton de démarrage / arrêt
IPA	=	Interruptor Puerta Lavado	Washer Door Switch	Interrupteur de porte de lavage
IPPL	=	Interruptor Puerta PreLavado	Prewash Door Switch	Interrupteur de porte prélavage
IPT1,2	=	Interruptor Puerta Tanque 1,2	Tank 1.2 Door Switch	Interrupteur de porte cuve 1.2
IR	=	Interruptor Retroceso Desenganche	Reverse stuck Switch	Interrupteur marche arrière à la blocage
ISV	=	Interruptor Seguridad Enganchon	Overload stuck Switch	Interrupteur marche à la blocage
PRG	=	Control Electronico	Electronic Control	Contrôle électronique
KA1, 2	=	Rele Auxiliar Llenado y Aclarado 1, 2	Fill and Rinse 1, 2 Auxiliary Relay	Relais auxiliaire remplissage et rinçage 1, 2
KP	=	Rele de Puerta	Door Relay	Relais de porte
KTT1	=	Rele Auxiliar Termostato Tanque1	Auxiliary Relay Tank Thermostat1	Thermostat Relais auxiliaire cuve 1
K1	=	Rele Auxiliar Generador Agua Caliente	Auxiliary Relay Hot Water Generator	Générateur auxiliaire Relais eau chaude
MBA	=	Moto Bomba Aclarado	Pump Rinsing	Pompe Rinçage
MBL1,2	=	Moto Bomba Lavado1,2	Washed Pump 1,2	Pompe de lavage 1,2
MBP	=	Moto Bomba Llenado	Filling Pump	Pompe de remplissage
MBPL	=	Moto Bomba PreLavado	Prewash Pump	Pompe à prélavage
MEV	=	Motor Extractor de Vahos	Steam extractor motor	Moteur extracteur vapeur
MREC	=	Motor Recuperador	Motor Recovery	Moteur Récupérateur
MS1,2	=	Motor Secado 1,2	Drying motor 1,2	Moteur de séchage 1,2
MV	=	Motor Arrastre	Advance Motor	Moteur d'entraînement
PA	=	Presostato Aclarado	Rinsed tank Pressure Switch	Pressostat de rinçage
PPL	=	Presostato Prelavado	Prewash tank Pressure Switch	Pressostat de prélavage cuve
PT1	=	Presostato Tanque 1	Washed tank 1 Pressure Switch	Pressostat de lavage cuve 1
PT2	=	Presostato Tanque 2	Washed tank 2 Pressure Switch	Pressostat de lavage cuve 2
R,N	=	Puntos conexión 230V	230V connection points	Points de connexion 230V
RC11,12,13	=	Resistencia Calentamiento Calderin	Boiler Element Heating	Resistance Chauffage Chaudière
RS1, 2	=	Resistencia Calentamiento Secado 1, 2	Drying Element Heating	Resistance Chauffage séchage
RTA	=	Resistencia Calentamiento Aclarado	Rinse tank Element Heating	Resistance Chauffage rinçage
RT11,12	=	Resistencia Calentamiento Tanque 1	Washed Tank 1 Element Heating	Resistance Chauffage lavage cuve 1
RT2	=	Resistencia Calentamiento Tanque 2	Washed Tank 2 Element Heating	Resistance Chauffage lavage cuve 2
SF	=	Interruptor Fin recorrido	Safety end Switch	Interrupteur fin de coourse
TA	=	Termostato Aclarado	Rinse Thermostat	Thermostat de rinçage
TC11	=	Termostato Calderin Temperatura Max.	Boiler thermostat Max. temperature	Thermostat Température max. chaudière
TC12	=	Termostato Calderin Temperatura min.	Boiler thermostat min. temperature	Thermostat Température min. chaudière
TREC	=	Termostato Recuperador	Recovery Thermostat	Thermostat récupérateur
TRF	=	Transformador	Transformer	Transformateur
TSA	=	Termostato Seguridad Aclarado	Rinse Hi-limit Thermostat	Thermostat Limiteur rinçage
TS1,2	=	Termostato Secado 1, 2	Drying 1,2 Thermostat	Thermostat séchage 1, 2
TSC1	=	Termostato Seguridad Calderin 1	Boiler 1 Hi-limit Thermostat	Thermostat Limiteur Chaudière
TST1,2	=	Termostato Seguridad Tanque 1,2	Washed 1,2 Hi-limit Thermostat	Thermostat Limiteur lavage 1, 2
TT1,2	=	Termostato Tanque 1, 2	Washed 1,2 Thermostat	Thermostat lavage 1, 2
VA	=	Electrovalvula Llenado y Aclarado	Filling and Rinse Solenoid Valve	Electrovanne Remplissage et rinçage
VEV	=	Electrovalvula Extractor de Vahos	Steam extractor Solenoid Valve	Electrovanne extracteur vapeur
VF	=	Variador de Frecuencia	Variable frequency drive	Variateur de fréquence
VL1,2	=	Electrovalvula Llenado Tanque 1, 2	Filling Tank 1, 2 Solenoid Valve	Electrovanne de remplissage 1, 2
VG	=	Electrovalvula General Recuperador	Recovery Solenoid Valve main	Electrovanne général Recuperateur
VREC	=	Electrovalvula Recuperador	Recovery Solenoid Valve	Electrovanne Recuperateur
ZA	=	Alarma Enganchon	Buzzer alarm stuck	Alarme buzzer blocage
	=			
COLOR	=	COLORES	COLOUR	COULEURS
BLK, bk, n	=	Negro	Black	Noir
BLU, bl, a	=	Azul	Blue	Bleu
BRN, bn, m	=	Marrón	Brown	Marron
GRN, gn, ve	=	Verde	Green	Vert
GRY, gy, g	=	Gris	Grey	Gris
ORG, or, na	=	Naranja	Orange	Orange
PNK, pk, rs	=	Rosa	Pink	Rose
PRP, pr, vi	=	Violeta	Purple	Violet
RED, rd, r	=	Rojo	Red	Rouge
WHT, wh, b	=	Blanco	White	Blanc
YEL, yw, am	=	Amarillo	Yellow	Jaune
YEL/GRN, am/ve	=	Amarillo/verde	Yellow / green	Jaune / vert
			L 37	12168021