

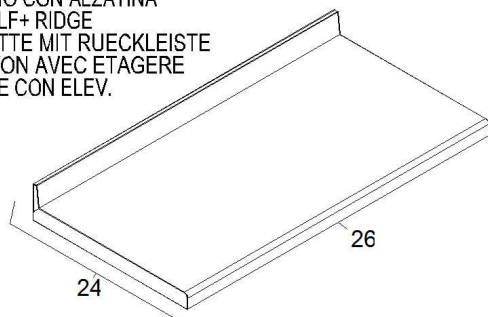

KUAA

Edition 20070629-

/A=PIANO CON ALZATINA
 /A=SHELF+ RIDGE
 /A=PLATTE MIT RUECKLEISTE
 /A=RAYON AVEC ETAGERE
 /A=TOPE CON ELEV.



/M=PIANO SENZA ALZATINA
 /M=SHELF WITHOUT RIDGE
 /M=PLATTE OHNE RUECKLEISTE
 /M=RAYON SANS ETAGERE
 /M=TOPE SIN ELEV

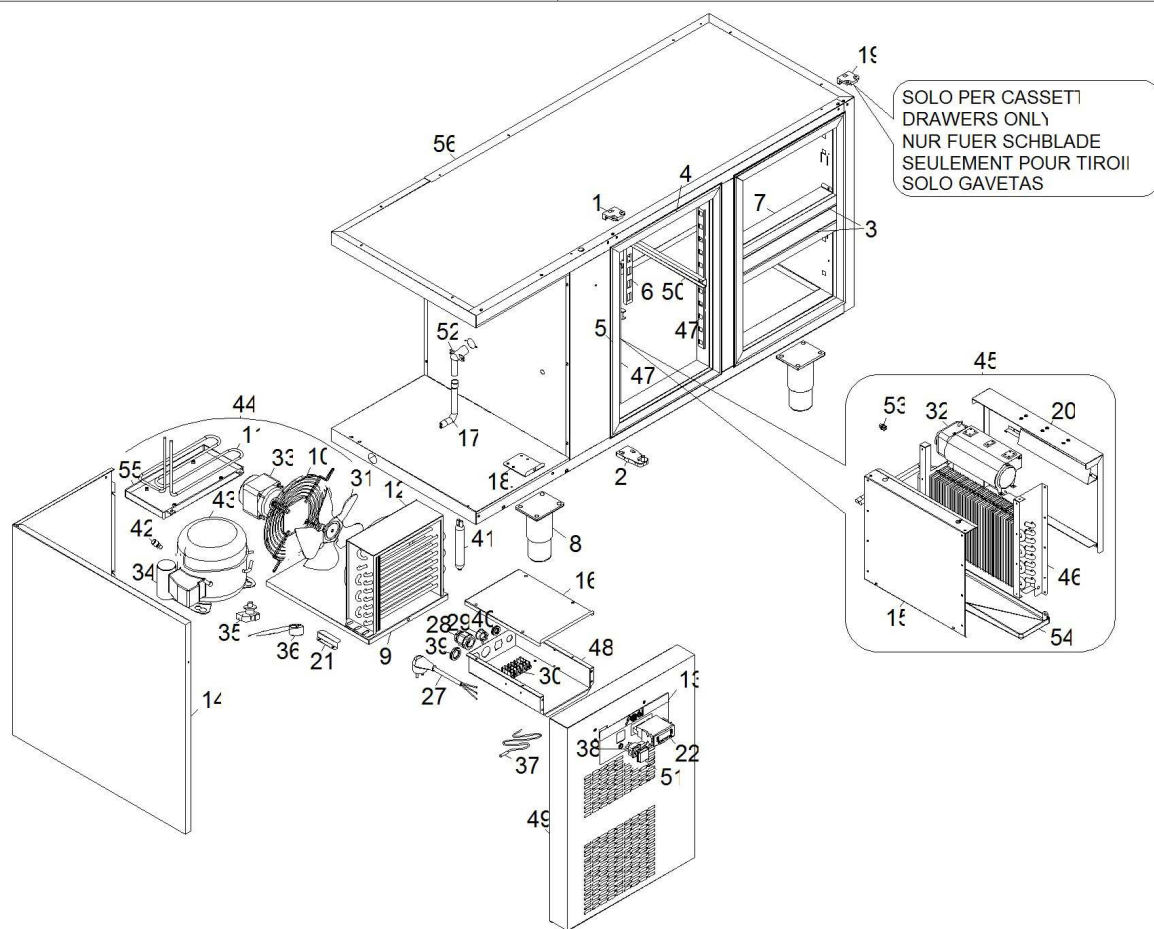
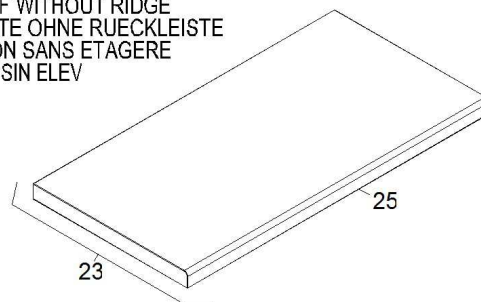

SOLO PER CASSETT
 DRAWERS ONLY
 NUR FUER SCHBLADE
 SEULEMENT POUR TIROII
 SOLO GAVETAS

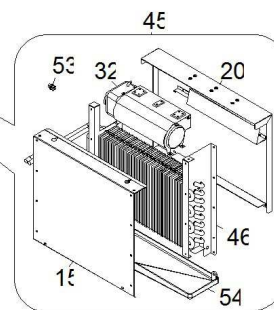

Modello Typ Model Modelle Modelo

		KUA KUAA KUAM KIA KIAA KIAM KIAB KIABA KIABM	KUA2 KUAA2 KUAM2 KIA2 KIAA2 KIAM2 - - -	- - - KIA13 KIA13A KIA13M -	- - - KIA11 KIA11A KIA11M -	KUB KUBA KUBM KIB KIBA KIBM KIBB KIBBA KIBBM	KUB2 KUB2A KUB2M KIB2 KIB2A KIB2M -	KUB4 KUB4A KUB4M KIB4 KIB4A KIB4M -	KUB11 KUB11A KUB11M KIB11 KIB11A KIB11M -	- - - KIB13 KIB13A KIB13M -	- - - KIB22 KIB22A KIB22M -	KUC KUCA KUCM KIC KICA KICM KICB KICBA KICBM	KUC2 KUC2A KUC2M KIC2 KIC2A KIC2M -	KUC4 KUC4A KUC4M KIC2 KIC2A KIC2M -	KUC11 KUC11A KUC11M KIC2 KIC2A KIC2M -	- - - KIC13 KIC13A KIC13M -	- - - KIC22 KIC22A KIC22M -
Num.cassetti Schubläd Drawers Tiroirs Gabetas	1/2SUP 1/2INF 1/3 2/3	- - - -	1 1 - -	- - 3 -	- - 1 1	- - - -	1 1 - -	2 2 - -	- - 1 1	- - 3 -	- - 2 2	- - - -	1 1 - -	2 2 - -	- - 1 1	- - 3 -	- - 2 2
Porte Türen Doors Portes Puertas		2	1	1	1	3	2	1	2	2	1	4	3	2	3	3	2

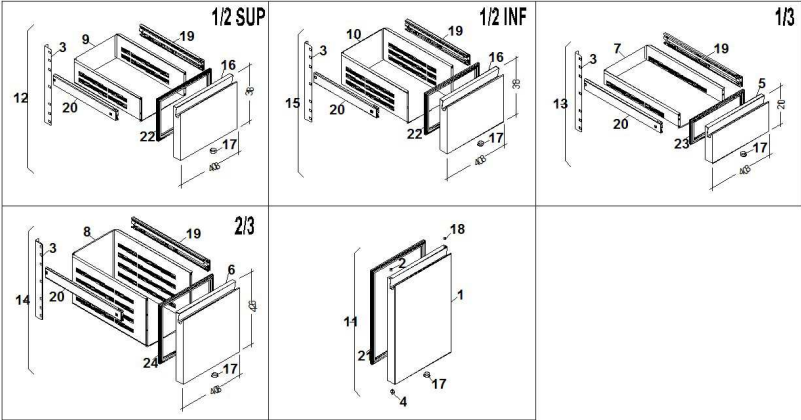

Page	Pos	Code	Description	Info
002	001	3043180	TOP BRACKET	01/09/2005-
002	002	3088700	BOTTOM BRACKET	06/10/2006-
002	003	3044810	FRAME TRIM	01/09/2005-
002	004	3044820	FRAME TRIM	01/09/2005-
002	005	3044830	FRAME TRIM	01/09/2005-
002	006	3045110	RACK	01/09/2005-23/07/2012
002	006	3208680	RACK	24/07/2012-
002	007	3045840	HORIZONTAL RISER	01/09/2005-
002	008	3047130	FOOT	01/09/2005-20/04/2010
002	008	3145280	FOOT	21/04/2010-
002	009	3047140	TRAY	01/09/2005-
002	010	3064100	FAN.PROT.	01/09/2005-06/04/2009
002	010	3097570	FAN GUARD	07/04/2009-
002	011	3047170	PIPE COIL	01/09/2005-
002	012	3047190	CONDENSER	01/09/2005-06/04/2009
002	012	3165760	CONDENSER	07/04/2009-
002	013	3093570	SILK-SCREE.PANEL	29/06/2007-
002	014	3047660	SIDE-BACK	01/09/2005-
002	015	3047810	HULL	01/09/2005-
002	016	3047920	PANEL-BOARD COVER	01/09/2005-
002	017	3048360	DRAIN TRAP	01/09/2005-
002	018	3048370	BRACKET	01/09/2005-
002	019	3048420	TOP BRACKET	01/09/2005-
002	020	3051700	COVER	01/09/2005-
002	021	3056800	TRAY GUIDE	01/09/2005-
002	022	32V8590	THERMOREGULATOR	26/04/2007-
002	023	6021020	ASSEMBLED TOP	01/09/2005-
002	024	6021030	ASSEMBLED TOP	01/09/2005-
002	025	30N1880	SHELF	01/09/2005-
002	026	30N1910	SHELF+RIDGE	01/09/2005-
002	027	32A2200	POWER SUPPLY CABLE	01/09/2005-
002	028	32D0020	CABLE CLAMP Ø 4 - 12	01/09/2005-
002	029	32D0680	CABLE CLAMP	01/09/2005-
002	030	32D0750	TERMINAL BOARD	01/09/2005-
002	031	32M3280	FAN	01/09/2005-
002	032	32M5920	FAN	01/09/2005-
002	033	32M6870	FAN MOTOR	01/09/2005-06/04/2009
002	033	32M7020	FANMOTOR	07/04/2009-
002	034	32V1500	CONDENSER	01/09/2005-
002	035	32V3900	RELAY	01/09/2005-
002	036	32V3910	ENGINE CUTOUT	01/09/2005-
002	037	32V6010	POROB NTC	26/04/2007-
002	038	32W3970	BIPOLAR SWITCH	01/09/2005-
002	039	32X0120	GROMMETØ 21	01/09/2005-
002	040	32X0140	GROMMET Ø 20	01/09/2005-
002	041	33A0180	FILTER	01/09/2005-
002	042	33A1200	AUXIL.VALVE	01/09/2005-
002	043	34D6140	COMPRESSOR	01/09/2005-10/01/2012
002	043	3216230	COMPRESSOR	11/01/2012-
002	044	34E2870	MOTOR UNIT	01/09/2005-06/04/2009
002	044	3165300	MOTOR UNIT	07/04/2009-10/01/2012

Page	Pos	Code	Description	Info
002	044	3216350	MOTOR UNIT	11/01/2012-
002	045	34E2920	EVAP. GROUP	01/09/2005-
002	047	35L4510	RACK	01/09/2005-23/07/2012
002	047	3208670	RACK	24/07/2012-
002	048	35L5500	PANEL BOARD	01/09/2005-
002	049	3108710	CONTROL BOARD	29/06/2007-
002	050	35L6080	GUIDE	01/09/2005-
002	051	36C5180	SWITCH PROT.	01/09/2005-
002	052	36E3990	CONDENS. DRAIN	01/09/2005-
002	053	36Z2220	PROBE STOPPER	26/04/2007-
002	054	36Z2370	COND. TRAY	01/09/2005-
002	055	36Z2380	TRAY	01/09/2005-
002	056	40K2113	BODY	01/09/2005-
003	001	30G4700	LEFT DOOR	01/09/2005-
003	002	3044110	BUSHING	01/09/2005-
003	004	3047630	BUSHING	01/09/2005-05/10/2006
003	004	3088710	BUSHING	06/10/2006-
003	011	6020920	DOOR REPLACEMENT UNIT	01/09/2005-
003	017	36C2650	CLAMP-ON	01/09/2005-
003	018	36D0630	PLUG	01/09/2005-
003	021	37Q4710	GASKET	01/09/2005-