

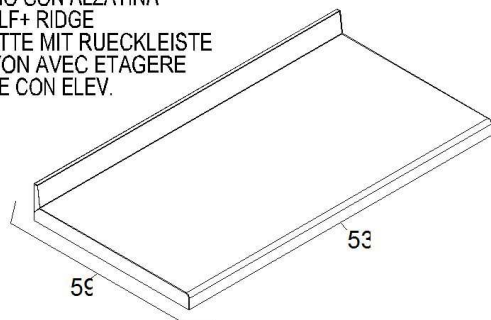

**KIABA**

**Edition 20070629-**

/A=PIANO CON ALZATINA  
 /A=SHELF+ RIDGE  
 /A=PLATTE MIT RUECKLEISTE  
 /A=RAYON AVEC ETAGERE  
 /A=TOPE CON ELEV.



/M=PIANO SENZA ALZATINA  
 /M=SHELF WITHOUT RIDGE  
 /M=PLATTE OHNE RUECKLEISTE  
 /M=RAYON SANS ETAGERE  
 /M=TOPE SIN ELEV

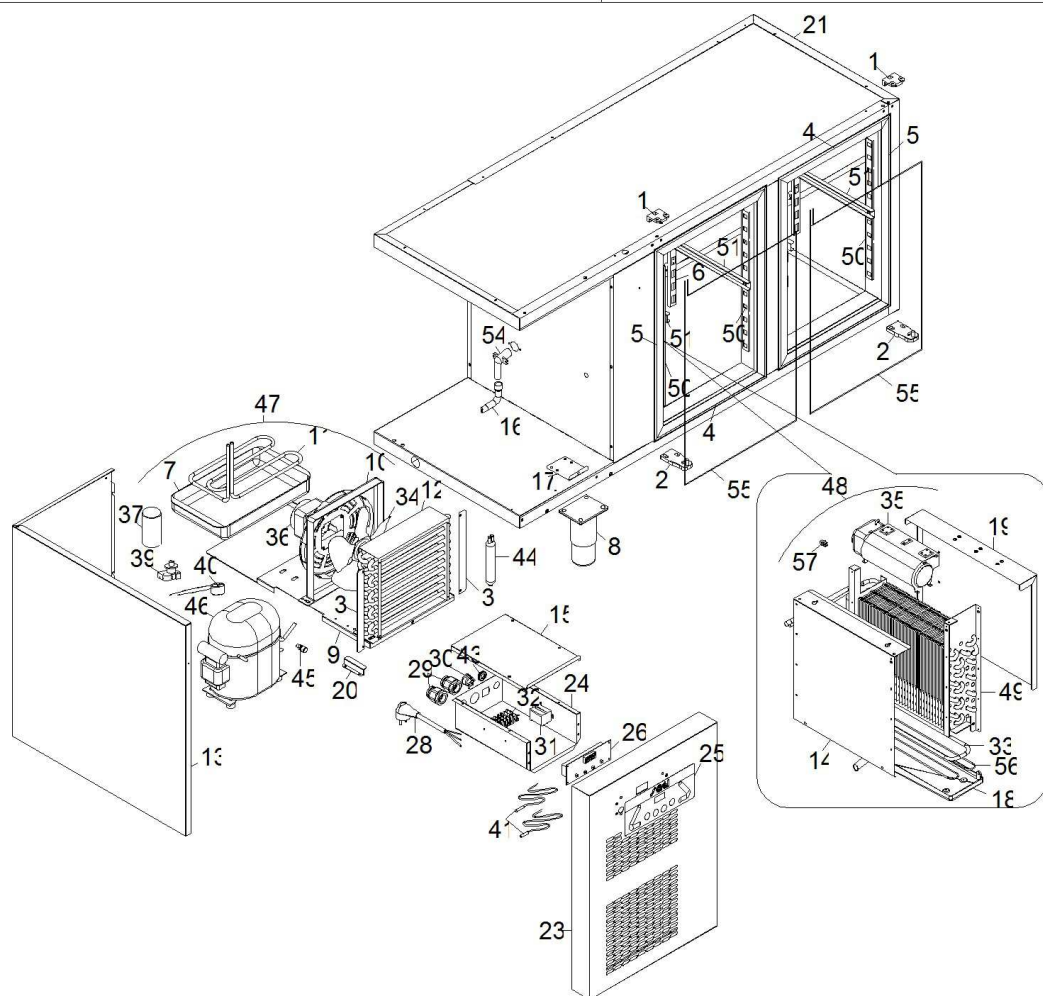
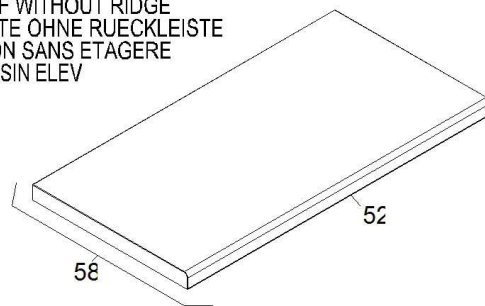

Modello Typ Model Modelle Modelo

|   |                                |   |   |   |   |  |   |   |   |   |   |  |   |   |  |   |   |
|---|--------------------------------|---|---|---|---|--|---|---|---|---|---|--|---|---|--|---|---|
|   |                                | KUA<br>KUA<br>KUAM<br>KIA<br>KIAA<br>KIAM<br>KIAB<br>KIABA<br>KIABM | KUA2<br>KUA2A<br>KUA2M<br>KIA2<br>KIA2A<br>KIA2M<br>- | -<br>-<br>-<br>KIA13<br>KIA13A<br>KIA13M<br>- | -<br>-<br>-<br>KIA11<br>KIA11A<br>KIA11M<br>- | KUB<br>KUBA<br>KUBM<br>KIB<br>KIBA<br>KIBM<br>KIBB<br>KIBBA<br>KIBBM | KUB2<br>KUB2A<br>KUB2M<br>KIB2<br>KIB2A<br>KIB2M<br>- | KUB4<br>KUB4A<br>KUB4M<br>KIB4<br>KIB4A<br>KIB4M<br>- | KUB11<br>KUB11A<br>KUB11M<br>KIB11<br>KIB11A<br>KIB11M<br>- | -<br>-<br>-<br>KIB13<br>KIB13A<br>KIB13M<br>- | -<br>-<br>-<br>KIB22<br>KIB22A<br>KIB22M<br>- | KUC<br>KUCA<br>KUCM<br>KIC<br>KICA<br>KICM<br>KICB<br>KICBA<br>KICBM | KUC2<br>KUC2A<br>KUC2M<br>KIC2<br>KIC2A<br>KIC2M<br>- | KUC4<br>KUC4A<br>KUC4M<br>KIC2<br>KIC2A<br>KIC2M<br>- | KUC11<br>KUC11A<br>KUC11M<br>KIC2<br>KIC2A<br>KIC2M<br>- | -<br>-<br>-<br>KIC13<br>KIC13A<br>KIC13M<br>- | -<br>-<br>-<br>KIC22<br>KIC22A<br>KIC22M<br>- |
| Num.cassetti<br>Schubläd<br>Drawers<br>Tiroirs<br>Gabetas | 1/2SUP<br>1/2INF<br>1/3<br>2/3 | -<br>-<br>-<br>-  | 1<br>1<br>-<br>-                                      | -<br>-<br>3<br>-                              | -<br>-<br>1<br>1                              | -<br>-<br>-<br>-   | 1<br>1<br>-<br>-                                      | 2<br>2<br>-<br>-                                      | -<br>-<br>1<br>1  | -<br>-<br>3<br>-                              | -<br>-<br>2<br>2                              | -<br>-<br>-<br>-   | 1<br>1<br>-<br>-                                      | 2<br>2<br>-<br>-                                      | -<br>-<br>1<br>1   | -<br>-<br>3<br>-                              | -<br>-<br>2<br>2                              |
| Porte<br>Türen<br>Doors<br>Portes<br>Puertas              |                                | 2   | 1   | 1   | 1   | 3  | 2   | 1   | 2   | 2   | 1   | 4  | 3   | 2   | 3  | 3   | 2   |

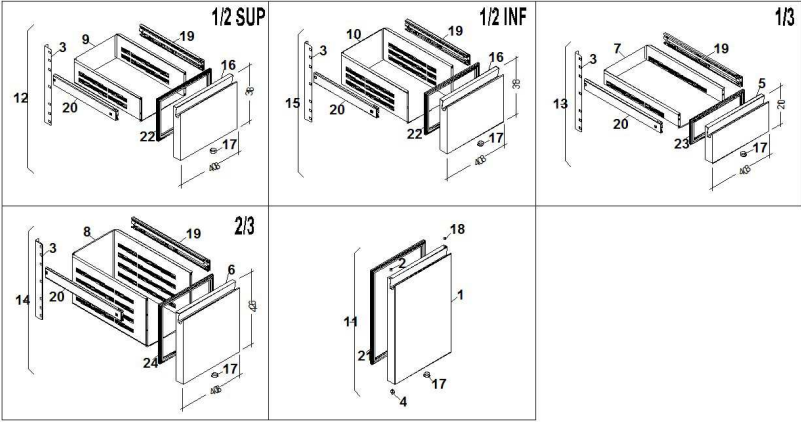

| Page | Pos | Code          | Description          | Info                  |
|------|-----|---------------|----------------------|-----------------------|
| 002  | 001 | 3043180       | TOP BRACKET          | 01/11/2005-           |
| 002  | 002 | 3088700       | BOTTOM BRACKET       | 06/10/2006-           |
| 002  | 003 | 3060010       | CONVEYOR             | 01/11/2005-           |
| 002  | 004 | 3044820       | FRAME TRIM           | 01/11/2005-           |
| 002  | 005 | 3044830       | FRAME TRIM           | 01/11/2005-           |
| 002  | 006 | 3045110       | RACK                 | 01/11/2005-23/07/2012 |
| 002  | 006 | 3208680       | RACK                 | 24/07/2012-           |
| 002  | 007 | 3620010       | TRAY                 | 01/11/2005-           |
| 002  | 008 | 3047130       | FOOT                 | 01/11/2005-20/04/2010 |
| 002  | 008 | 3145280       | FOOT                 | 21/04/2010-           |
| 002  | 009 | 3058910       | TRAY                 | 01/11/2005-           |
| 002  | 010 | 3620230       | CONVEYOR             | 01/11/2005-           |
| 002  | 011 | 35X2970       | PIPE COIL            | 01/11/2005-           |
| 002  | 012 | 34D4010       | CONDENSER            | 01/11/2005-           |
| 002  | 013 | 3047660       | SIDE-BACK            | 01/11/2005-           |
| 002  | 014 | 3047840       | HULL                 | 01/11/2005-           |
| 002  | 015 | 3047920       | PANEL-BOARD COVER    | 01/11/2005-15/02/2009 |
| 002  | 015 | 3164760       | PANEL-BOARD COVER    | 16/02/2009-           |
| 002  | 016 | 3062080       | DRAIN TRAP           | 17/02/2006-           |
| 002  | 017 | 3048370       | BRACKET              | 01/11/2005-           |
| 002  | 018 | 3045460       | COND. TRAY           | 01/11/2005-           |
| 002  | 019 | 3062960       | COVER                | 01/11/2005-           |
| 002  | 020 | 3056800       | TRAY GUIDE           | 01/11/2005-           |
| 002  | 021 | KIABA-Pos.021 | BODY                 | 01/11/2005-           |
| 002  | 023 | 3108870       | CONTROL BOARD        | 29/06/2007-15/02/2009 |
| 002  | 023 | 3164740       | CONTROL BOARD        | 16/02/2009-           |
| 002  | 024 | 3047910       | PANEL BOARD          | 29/06/2007-15/02/2009 |
| 002  | 024 | 3164750       | PANEL BOARD          | 16/02/2009-           |
| 002  | 025 | 3093580       | SILK-SCREE.PANEL     | 29/06/2007-           |
| 002  | 026 | 3108890       | ELECTRONIC CARD      | 29/06/2007-29/06/2007 |
| 002  | 026 | 3135410       | ELECTRONIC CARD      | 30/06/2007-15/02/2009 |
| 002  | 026 | 3179250       | ELECTRONIC CARD      | 16/02/2009-           |
| 002  | 028 | 32A2200       | POWER SUPPLY CABLE   | 01/11/2005-           |
| 002  | 029 | 32D0020       | CABLE CLAMP Ø 4 - 12 | 01/11/2005-           |
| 002  | 030 | 32D0680       | CABLE CLAMP          | 01/11/2005-           |
| 002  | 031 | 32V3720       | RELAY                | 01/11/2005-           |
| 002  | 032 | 32D0740       | TERMINAL BOARD       | 01/11/2005-           |
| 002  | 033 | 3048210       | RESISTOR             | 01/11/2005-           |
| 002  | 034 | 32M2510       | FAN                  | 01/11/2005-           |
| 002  | 035 | 3059250       | TANGENTIAL FAN       | 01/11/2005-           |
| 002  | 036 | 32M7020       | FANMOTOR             | 01/11/2005-           |
| 002  | 037 | 32Z7690       | CONDENSER            | 01/11/2005-           |
| 002  | 039 | 32Z7590       | RELAY                | 01/11/2005-           |
| 002  | 040 | 32Z7640       | ENGINE CUTOUT        | 01/11/2005-           |
| 002  | 041 | 32V6010       | POROB NTC            | 01/11/2005-           |
| 002  | 043 | 32X0140       | GROMMET Ø 20         | 01/11/2005-           |
| 002  | 044 | 33A0180       | FILTER               | 01/11/2005-           |
| 002  | 045 | 33A1200       | AUXIL.VALVE          | 01/11/2005-           |
| 002  | 046 | 34D4530       | COMPRESSOR           | 01/11/2005-28/11/2011 |
| 002  | 046 | 3215760       | COMPRESSOR           | 29/11/2011-           |
| 002  | 047 | 3054770       | MOTOR UNIT           | 01/11/2005-           |

| Page | Pos | Code    | Description           | Info                  |
|------|-----|---------|-----------------------|-----------------------|
| 002  | 048 | 3058040 | EVAP. GROUP           | 01/11/2005-           |
| 002  | 050 | 35L4510 | RACK                  | 01/11/2005-23/07/2012 |
| 002  | 050 | 3208670 | RACK                  | 24/07/2012-           |
| 002  | 051 | 35L6080 | GUIDE                 | 01/11/2005-           |
| 002  | 052 | 3052330 | SHELF                 | 01/11/2005-           |
| 002  | 053 | 3052350 | SHELF+RIDGE           | 01/11/2005-           |
| 002  | 054 | 36E3990 | CONDENS. DRAIN        | 01/11/2005-           |
| 002  | 055 | 3065300 | RESISTOR              | 21/03/2006-           |
| 002  | 056 | 3058070 | RESISTOR              | 01/11/2005-           |
| 002  | 057 | 36Z2220 | PROBE STOPPER         | 01/11/2005-           |
| 002  | 058 | 6020960 | ASSEMBLED TOP         | 01/11/2005-           |
| 002  | 059 | 6020970 | ASSEMBLED TOP         | 01/11/2005-           |
| 003  | 001 | 30G4700 | LEFT DOOR             | 01/09/2005-           |
| 003  | 004 | 3047630 | BUSHING               | 01/09/2005-05/10/2006 |
| 003  | 004 | 3088710 | BUSHING               | 06/10/2006-           |
| 003  | 011 | 6020920 | DOOR REPLACEMENT UNIT | 01/09/2005-           |
| 003  | 017 | 36C2650 | CLAMP-ON              | 01/09/2005-           |
| 003  | 018 | 36D0630 | PLUG                  | 01/09/2005-           |