

**ABBATTITORI GASTRONOMIA
POSITIVI**

GASTRONOM BLAST CHILLERS

**GASTRONOMIE
SCHNELLABKÜHLER**

**CELLULES DE REFROIDISSEMENT
RAPIDE POUR GASTRONOMIE**

ZP 112S



Pagina 1

Sezione 4

Punti modificati e natura delle correzioni

[illegible]



**ESPLOSI – EXPLODED DRAWINGS
EXPLOSIONZEICHNUNGEN - VUE ECLATEE**

Codice XESH6X72
Pagina 2

Verifica: Ufficio tecnico De Cian

Emissione: Ufficio tecnico De Cian

Approvazione: Direzione tecnica Zambon

Copia controllata nr. _____

☒ Copia non controllata

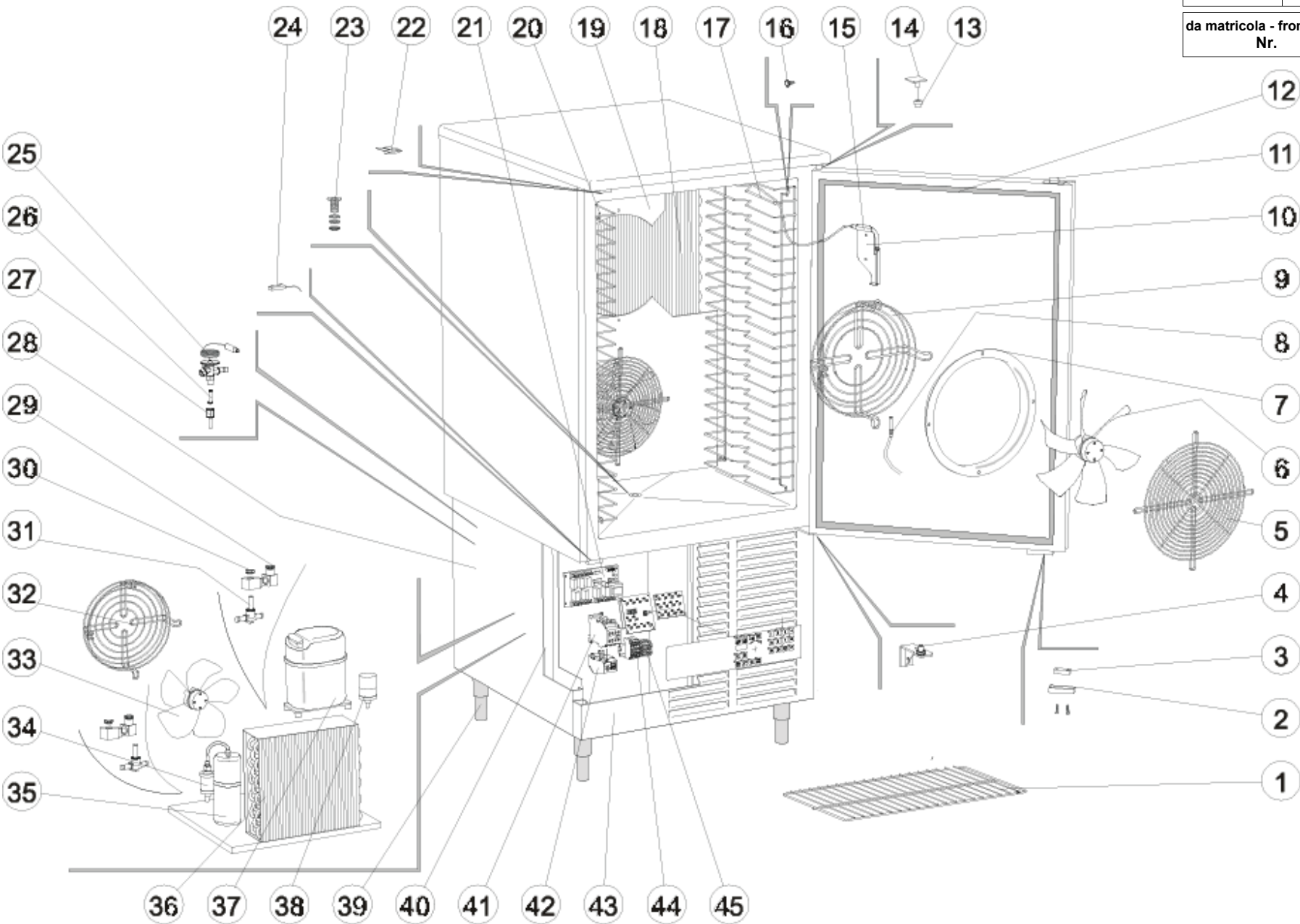

	COD.	REV.	DESCRIZIONE	DESCRIPTION	BESCHREIBUNG	DESCRIPTION
1	RA170009		GRIGLIA PAST. 600X400 AISI304	PASTRY GRID 600X400 AISI304	KONDITOREIROST 600X400 AISI304	GRILLE PATISSERIE 600X400 AISI304
2	RG830009		SCATOLA MAGNETE	MAGNETO BOX	MAGNET-KASTEN	BOITE MAGNETO
3	RA840005		UNITA' MAGNETICA	MAGNETIC UNIT	MAGNETEINHEIT	UNITE MAGNETIQUE
4	RF200008		ASSIEME CERNERA INFERIORE PORTA	LOWER HINGE FOR DOOR	UNTERES SCHARNIER FUER TUER	CHARNIERE INFERIEURE POUR PORTE
5	RA170017		GRIGLIA PROTEZIONE VENTOLA 300V INOX	PROTECTION GRID FOR FAN 300V	SCHUTZGITTER FUER VENTILATOR 300	GRILLE PROTECTION VENTILATEUR 300
6	RA880009	C	MOTOVENTILATORE A4E300-AA01-48 (112)	FAN A4E300-AA01-48 (112)	VENTILATOR A4E300-AA01-48 (112)	VENTILATEUR A4E300-AA01-48 (112)
7	RA110011		BOCCAGLIO VENTOLA 300 AL.	FAN CONVEYOR 300 AL.	VENTILATOR-KONVEYOR 300 AL.	EMBOUT VENTILATEUR 300 AL.
8	RA930008	C	SONDA PTC L.2500 SILICONE	PROBE PTC L.2500	FÜHLER PTC L. 2500	SONDE PTC L.2500
9	RA170023		GRIGLIA SOST. VENTOLA 300 4P V INOX	SUPPORT GRID FOR FAN 300 4P	GITTERHALTER FUER VENTILATOR 300 4P	SUPPORT GRILLE VENTILATEUR 300 4P
10	RG830038		SUPPORTO SX SONDA AL CUORE	SENSOR ROD LEFT SUPPORT	LINK KERNFÜHLERHALTER	SUPPORT GAUCHE SONDE AU CŒUR
11	RZ960029		KIT SCROCCHETTO	CATCH KIT	SCHNAPPER KIT	KIT ENCLenchement
12	RA190037		GUARNIZIONE DI TENUTA	SEAL	DICHTUNG	GARNITURE
13	RA050001		BOCCOLA CERNIERA SUPERIORE PORTA	BUSH FOR UPPER DOOR HINGE	BUCHSE FUER OBERSCHARNIER DER TUER	DOUILLE POUR CHARNIERE SUPERIEURE PORTE
14	RF200005		ASSIEME CERNIERA SUPERIORE PORTA	UPPER HINGE FOR DOOR	OBERES SCHARNIER FUER TUER	CHARNIERE SUPERIEURE PORTE
15	RA930010	C	SONDA AISI INFILZO SENZA RISCALDAMENTO	CORE PROBE	KERNFUEHLER	SONDE AU COEUR
16	RA470005		PERNO SUPPORTO PARATIA F4 2/3	PIN FOR TRAY SUPPORT F4 2/3	BOLZEN FUER SCHALEHALTER F4 2/3	PIVOT POUR PORTE-PLAQUES F4 2/3
17	RA175010		ASS. PARATIA 112 GASTR.	SUPPORT FOR GN TRAY FOR MOD. 112	GN SCHALENHALTER FÜR MOD. 112	CLOISON PORTE-PLAQUES POUR MOD. 112
18	RA140003		EVAPORATORE 2R32T PER ABB.112	EVAPORATOR 2R32T FOR MOD. 112	VERDÄMPFER 2R32T FUER MOD. 112	EVAPORATEUR 2R32T POUR MOD. 112
19	RG310006		CONVOGLIATORE 112	FAN COVERING 112	VENTILATORABDECKUNG 112	COUVRE VENTILATEUR 112
20	RA175010		ASS. PARATIA 112 GASTR.	SUPPORT FOR GN TRAY FOR MOD. 112	GN SCHALENHALTER FÜR MOD. 112	CLOISON PORTE-PLAQUES POUR MOD. 112
21	RA910060	C	SCHEDA BASE 7 RELE' AL001BA060	MASTER CARD - 7 RELAYS AL001BA060	HAUPTPLATINE - 7 RELAIS AL001BA060	FICHE BASE-7 RELAIS AK001BA060
22	RG830039		FERMO IN AISI PER SCROCCHETTO	CATCH SEAT	AUFNAHME FUER SCHNAPPER	ARRET D'ENCLenchement
23	RA651002		PILETTA SCARICO 1" L=30	DRAIN STRAINER 1" L=30	BECKENAUSLAUF 1" L=30	CREPINE VIDANGE 1" L=30
24	RA840004		SENSORE MAGNETICO	MAGNETIC SENSOR	MAGNETSENSOR	CAPTEUR MAGNETIQUE
25	RA715017		CORPO VALVOLA TES2 R404A ODF	VALVE BODY TES2 R404A ODF	VENTILKOERPER TES2 R404A ODF	CORPS SOUPAPE TES2 R404A ODF
26	RA716019		ORIFICIO N° 03 CON FILTRO	ORIFICE N°03 WITH FILTER	ÖFFNUNG N° 03 MIT FILTER	ORIFICE N°03 AVEC FILTRE
27	RA716502		ADATTATORE A BRASARE PER T-TE D.10	ADAPTER FOR T-TE D.10	ADAPTER FUER T-TE D.10	ADAPTATEUR POUR T-TE D.10
28	RG370004		FIANCO VANO MOTORE 112	SIDE PANEL FOR ENGINE COMPARTMENT 112	SEITENWAND FUER MOTORRAUM 112	COTE COMPARTIMENT MOTEUR 112
29	RA714017		CONNETTORE PG11 PER VALVOLA SOLENOIDE CASTEL	CONNECTOR PG11 FOR SOLENOIDE VALVE	VERBINFER PG11 FUER SOLENOID-VENTIL	CONNECTEUR PG11 POUR SOUPAPE SOLENOIDE
30	RA714016	C	BOBINA 220-50/60 PER VALVOLA SOLENOIDE CASTEL	COIL 220-50/60 FOR SOLENOIDE VALVE	SPUL 220-50/60 FUER SOLENOID-VENTIL	BOBINE 220-50/60 POUR SOUPAPE SOLENOIDE
31	RA714014		VALVOLA SOLENOIDE Ø10 SALD. CASTEL 1068/M10S	CASTEL SOLENOIDE VALVE Ø10 1068/M10S	CASTEL SOLENOID-VENTIL Ø10 1068/M10S	SOUPAPE SOLENOIDE CASTEL Ø 10 1068/M10S
32	RA170005		GRIGLIA G035000-00-01EBM	GRID G035000-00-01EBM	GITTER G035000-00-01EBM	GRILLE G035000-00-01EBM
33	RA880035	C	MOTOVENTILATORE EBM AE350-AP06-01	MOTOR FOR FAN EBM AE350-AP06-01	MOTOR FUER VENTILATEUR EBM E350-AP06-01	MOTEUR VENTILATEUR EBM AE350-AP06-01
34	RA012009		FILTRO DEIDR. CASTEL 4308/3S	DEHYDRATION FILTER 4308/3S	WASSERENTZIEHUNG-FILTER 4308/3S	FILTRE DEHYDRATATION 4308/3S
35	RA014104		RICEVITORE LIQUIDO DL 1.60 100X240	LIQUID RESERVE DL. 1.60 100X240	FLUESSIGKEITRESERVE D. 1.60 100X240	RECEPTEUR DE LIQUIDE DL. 1.60 100X240
36	RA090015		CONDENSATORE 2522-16T-5R-380-SP3.5-5AL	CONDENSER 2522-16T-5R-380-SP3.5-5AL	KONDENSER 2522-16T-5R-380-SP3.5-5AL	CONDENSATEUR 2522-16T-5R-380-SP3.5-5AL
37	RA073006	C	COMPRESSORE ASPERA J9226GKR404A	COMPRESSOR ASPERA J9226GKR404A	KOMPRESSOR ASPERA J9226GKR404A	COMPRESSEUR ASPERA J9226GKR404A
38	RA191002		PIEDINO ACCIAIO INOX 11/4x120"	STAINLESS STEEL FOOT 11/4x120	EDELSTAHL FUSS 11/4x120	PIED EN ACIER INOX 11/4x120
39	RG860008		SCHIENA VANO MOTORE 112	BACK PANEL FOR ENGINE COMPARTMENT 112	RUECK FUER MOTORRAUM 112	DOS POUR COMPARTIMENT MOTEUR 112
40	RA890004		RELÉ FINDER 62.82.82300308	FINDERRELAY 62.82.82300308	RELAIS FINDER 62.82.82300308	RELAIS FINDER 62.82.82300308
41	RA980002	C	TERMICO 3UA5000-1F 3.2-5 A	THERMAL 3UA5000-1F 3.2-5A	WAERMESCHUTZ 3UA5000-1F 3.2-5A	INTERRUPTEUR 3UA5000-1F 3.2-5A



42	RF360041			ASSIEME CRUSCOTTO 112	FRONT PANEL FOR MOD. 112	VORDERPANEEL FUER MOD. 112	PANNEAU FRONTAL POUR MOD. 112
43	RA850001			PORTAFUSIBILE 8W/A1	FUSE CARRIER 8W/A1	SICHERUNGSKOERPER 8W/A1	CORPS FUSIBLE 8W/A1
44	0101259			MORSETTO TERMINALE	TERMINAL JUNCTION BLOCK	ENDKLEMME	BORNE TERMINAL
45	RA910070		C	SCHEDA TASTIERA CT1SI0020101	KEYBOARD CARD CT1SI0020101	TASTATUR-PLATINE CT1SI0020101	FICHE CLAVIER CT1SI0020101
	RA130005			ADESIVI "ATTENZIONE 400V"	ADHESIVE "WARNING 400V"	KLEBSTOFF "ACHTUNG 400V"	ADHESIF "ATTENTION 400V"
	RA986501			FUSIBILE 2A F5020K2A	FUSE 2A F5020K2A	SCHMELZSICHERUNG 2A F5020K2A	FUSIBLE 2A F5020K2A
	RA986502			FUSIBILE 400 MA 5X20F	FUSE 400 MA 5X20F	SCHMELZSICHERUNG 400 MA 5X20F	FUSIBLE 400 MA 5X20F
	RA986503			FUSIBILE 4A F5020K4A	FUSE 4A F5020K4A	SCHMELZSICHERUNG 4A F5020K4A	FUSIBLE 4A F5020K4A



COD. XESH6X72

PAG. 5