

COD. XESH6X02		PAG. 19
da matricola - from serial Nr. 091298454		a matricola - to serial Nr.

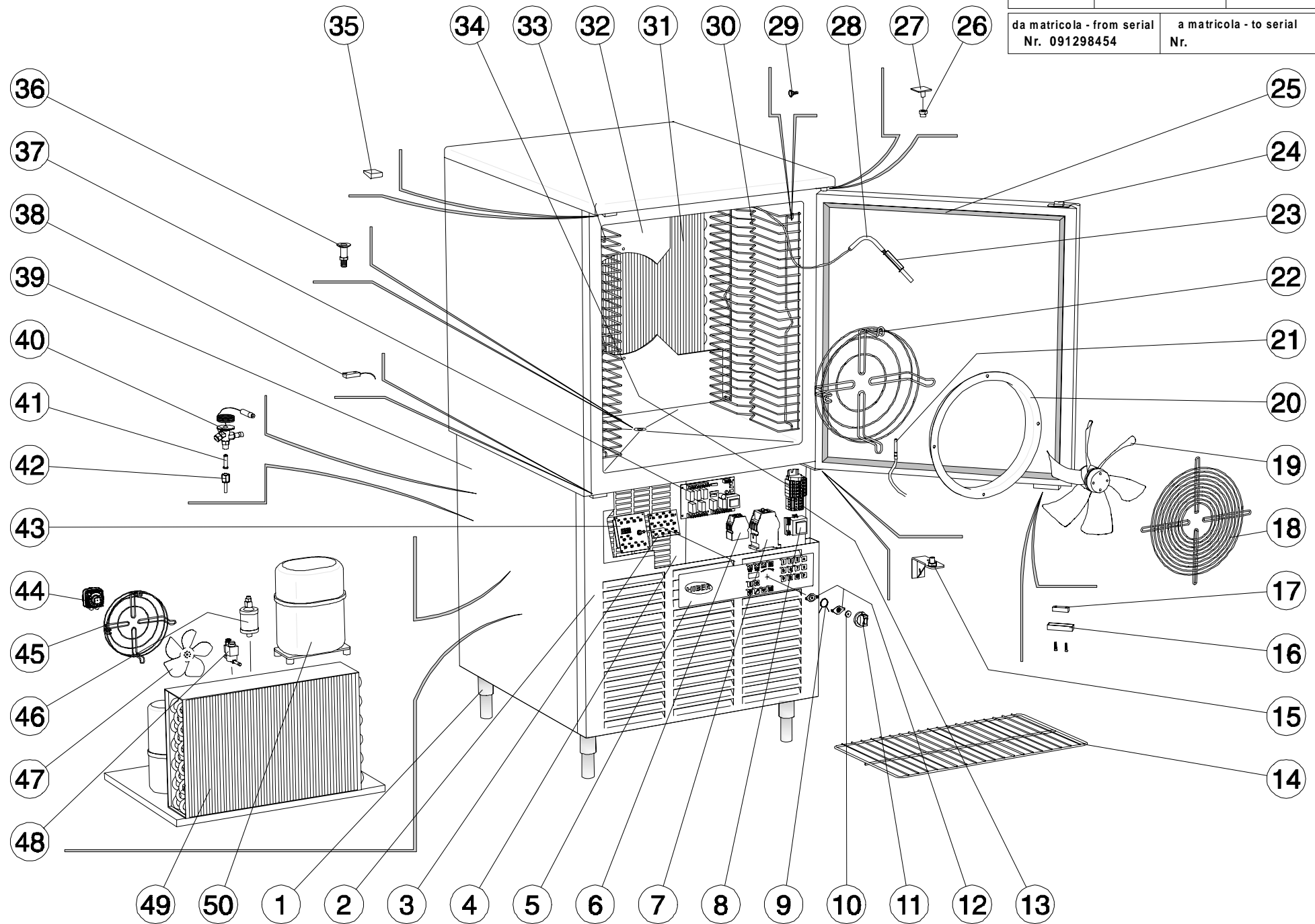

	COD.	REV.	DESCRIZIONE	DESCRIPTION	BESCHREIBUNG	DESCRIPTION
1	RA191002		PIEDINO ACCIAIO INOX 11/4x120"	STAINLESS STEEL FOOT 11/4x120"	EDELSTAHL FUSS 11/4x120"	PIED EN ACIER INOX 11/4x120"
2	RF360004		ASS.CRUSCOTTO 110	FRONT PANEL FOR MOD. 110	VORDERPANEEL FÜR MOD. 110	PANNEAU FRONTAL POUR MOD. 110
3	RA910062		SCHEDA PROGRAMMI AL001DA060	PROGRAMS CARD AL001DA060	PROGRAMM-PLATINE AL001DA060	FICHE PROGRAMME AL001DA060
4	RG860007		SCHIENA VANO MOTORE 110	BACK PANEL F. ENGINE COMPART. 110	RÜCK FÜR MOTORRAUM 110	DOS POUR COMPARTIMENT MOTEUR 110
5	RA130045		MASC. TASTIERA + PROG.POS.110-210 H	POSITIVE KEYBOARD PLATE + PROGRAM. 110 – 210 H	POSITIVE TASTATURFOLIE + PROGRAM. 110 – 210 H	MASQUE PLATINE POSITIVE + PROGRAM. 110 – 210 H
6	RA980002		TERMICO 3UA5000-1F 3.2-5 A	THERMAL 3UA5000-1F 3.2-5A	WAERMESCHUTZ 3UA5000-1F 3.2-5A	INTERRUPTEUR 3UA5000-1F 3.2-5 A
7	RA890007		TELERUTTORE 3TF4011-OAUO 240V	ELECTROMAGNETIC SWITCH 3TF4011-OAUO	FERNSCHALTER 3TF4011-OAUO 240V	TELERUPTEUR 3TF4011-OAUO 240V
8			NON INSTALLATO	NOT INSTALLED	NICHT INSTALLIERT	PAS MONTE
9	RA919006		MOLLA POTENZIOMETRO SCHEDA P""	CARD POTENTIOMETER SPRING P""	POTENTIOMETER FEDER VON P"PLATINE"	RESSORT POTENTIOMETRE FICHE P""
10	RA919010		GUARNIZIONE MANOPOLA PER 2/3	SEAL FOR KNOB FOR 2/3	DICHTUNG F. KNEBEL F. 2/3	GARNITURE MANETTE P/ 2-3
1	RA919005		MANOPOLA POTENZIOMETRO	POTENTIOMETER CONTROL KNOB	KNEBEL FUER POTENTIOMETER	MANETTE P/POTENTIOMETRE
2	RA919009		SUPP.MOLLA POTENZ.SCHEDE D-H-P	SUPPORT F. D-H"CARDPOTENZ.SPRING"	HALTERR. F. POTENZ. FEDER F. PLATIN	SUPPORT RESSORT P/POTENT.FICHE D-H
3	RA850005		MORSETTIERA LX2 (TIPO 2)	TERMINAL BOARD LX2 (TYPE 2)	KLEMMKASTEN LX2 (TYP 2)	BORNE LX2 (TYPE 2)
4	RA170009		GRIGLIA PAST. 600X400 AISI304	PASTRY GRID 600X400 AISI304	KONDI TOREIROST 600X400 AISI304	GRILLE PATISSERIE 600X400 AISI304
5	RF200003		ASS. CERNIERA INF. PORTA 110-210	LOWER HINGE FOR DOOR 110 - 210	UNTERES SCHARNIER F.TÜR 110 - 210	CHARNIERE INFERIEURE P/PORTE 110 – 210
6	RG830009		SCATOLA MAGNETE	MAGNETO BOX	MAGNET-KASTEN	BOITE MAGNETO
7	RA840005		UNITA' MAGNETICA	MAGNETIC UNIT	MAGNETEINHEIT	UNITE MAGNETIQUE
8	RA170019		GRIGLIA PROT.VENT.400 V"INOX"	PROTECTION GRID FOR FAN 400 V""	SCHUTZGITTER FÜR VENTILATOR 300	GRILLE PROTECTION VENTILATEUR 300
9	RA880011		MOTOVENT. A4E400-AA06-17 (110-C20)	FAN A4E400-AA06-17 (110-C20)	VENTILATOR A4E400-AA06-17 (110-C20)	VENTILATEUR A4E400-AA06-17 (110-C20)
10	RA110013		BOCCAGLIO VENT. 400 AL.	FAN CONVEYOR 400 AL.	VENTILATOR-KONVEYOR 400 AL.	EMBOUT VENTILATEUR 400 AL.
11	RA930008		SONDA PTC L.2500 SILICONE	PROBE PTC L.2500	FÜHLER PTC L. 2500	SONDE PTC L.2500
12	RA170036		GRIGLIA SOST.VENT.400 V"INOX"	SUPPORT GRID FOR FAN 400 V""	GITTERHALTER FÜR VENTILATOR 400V	SUPPORT GRILLE VENTILATEUR 400V
13	RA570003		ASS. PORTASONDE SPILLONE	PROBE SUPPORT FOR PRICKER PROBE	FÜHLERHALTER FUER NADELFUEHLER	PORTE-SONDE P/AGUILLE
14	RZ960029		KIT SCROCCHETTO	CATCH KIT	SCHNAPPER KIT	KIT ENCLenchement
15	RA190036		GUARNIZIONE DI TENUTA	SEAL	DICHTUNG	GARNITURE
16	RA050001		BOCCOLA CERNIERA SUPER.PORTA	BUSH FOR UPPER DOOR HINGE	BUCHSE F. OBERSCHARNIER DER TUER	DOUILLE P/CHARNIERE SUP.PORTE
17	RF200005		ASS. CERNIERA SUP. PORTA	UPPER HINGE FOR DOOR	OBERES SCHARNIER FÜR TÜR	CHARNIERE SUPERIEURE PORTE
18	RA930004		SONDA INF.PTC 3X100 3MT SILIC.	CORE PROBE 3X100 3M	KERNFUEHLER 3X100 3M	SONDE AU COEUR
19	RA470005		PERNO SUPPORTO PARATIA F4 2/3	PIN FOR TRAY SUPPORT	BOLZEN FÜR SCHALEHALTER	PIVOT P/PORTE-PLAQUES 3X100 3MT
10	RA175009		ASS. PARATIA 110 GASTR.	SUPPORT FOR GN TRAY	GN SCHALENHALTER FÜR MOD. 110	CLOISON PORTE-PLAQUES POUR MOD. 110
11	RA140004		EVAPORATORE 4R26T X ABB.110	EVAPORATOR 4R26T FOR MOD. 110	VERDÄMPFER 4R26T FÜR MOD. 110	EVAPORATEUR 4R26T POUR MOD. 110
12	RG310004		CONVOGLIATORE 110-C20	FAN COVERING 110-C20	VENTILATORABDECKUNG 110-C20	COUVRE VENTILATEUR 110-C20
13	RA175009		ASS. PARATIA 110 GASTR.	SUPPORT FOR GN TRAY	GN SCHALENHALTER FÜR MOD. 110	CLOISON PORTE-PLAQUES POUR MOD. 110
14	RA850001		PORTAFUSIBILE BARRA DIN	FUSE CARRIER FOR DIN-BAR	SICHERUNGSKOERPER FÜR DIN-STANGE	CORPS FUSIBLE P/BARRE DIN
15	RA494001		AGGANCIO SCROCCHETTO	CATCH SEAT	AUFNAHME FÜR SCHNAPPER	ARRET D'ENCLenchement
16	RA651000		PILETTA SCARICO COMPL.3/4 L=30	DRAIN STRAINER 3/4 L= 30	BECKENAUSLAUF 3/4 L=30	CREPINE VIDANGE 3/4 L=30
17	RA910060		SCHEDA BASE 7 RELE' AL001BA060	MASTER CARD – 7 RELAIS AL001BA060	HAUPTPLATINE – 7 RELAIS AL001BA060	FICHE BASE – 7 RELAIS AL001BA060
18	RA840004		SENSORE MAGNETICO	MAGNETIC SENSOR	MAGNETSENSOR	CAPTEUR MAGNETIQUE
19	RG370003		FIANCO VANO MOTORE 110	SIDE PANEL F. ENGINE COMPARTMENT 110	SEITENWAND	COTE COMPARTIMENT MOTEUR 110

3	RA715017		CORPO VALVOLA TES2 R404A ODF	VALVE BODY TES2 R404A ODF	VENTILKOERPER TES2 R404A ODF	CORPS SOUPAPE TES2 R404A ODF
1	RA716019		ORIFICIO N° 03 C/FILTRO ODF	ORIFICE N° 03 WITH FILTER ODF	ÖFFNUNG N°03 MIT FILTER ODF	ORIFICE N°03 AVEC FILTRE ODF
2	RA716502		ADATTATORE A BRASARE X T-TE D.10	ADAPTER FOR T-TE D.10	ADAPTER FÜR T-TE D.10	ADAPTATEUR POUR T-TE D.10
3	RA910065		SCHEDA TASTIERA AL001DA055	KEYBOARD CARD AL001DA055	TASTATUR-PLATINE AL001DA055	FICHE CLAVIER AL001DA055
4	RA880035		MOTOVENT. EBM AE350-AP06-01	MOTOR FOR FAN EBM AE350-AP06-01	MOTOR F. VENTILATEUR EBM AE350-AP06-01	MOTEUR VENTILATEUR EBM AE350-AP06-01
5	RA170052		GRIGLIA EBM 64560-2-4039 PER GR 350	GRID EBM 64560-2-4039 FOR GR 350	GITTER EBM 64560-2-4039 FÜR GR 350	GRILLE EBM 64560-2-4039 POUR GR 350
3	RA012009		FILTRO DEIDR. CASTEL 4308/3S	DEHYDRATION FILTER 4308/3S	WASSERENTZIEHUNG-FILTER 4308/3S	FILTRE DEHYDRATATION 4308/3S
7			INCLUSO IN PARTICOLARE 44	INCLUDED IN POS. 44	IM POS. 44 ENTHÄLT	INCLUS A LA POS. 43
3	RA714014		VALV. SOL.Ø10 SALD.CASTEL 1068/M10S	CASTEL SOLENOIDE VALVE Ø10 1068/M10S	CASTEL SOLENOID-VENTIL Ø10 1068/M10S	SOUPAPE SOLENOIDE CASTEL Ø10 1068/M10S
3	RA714016		BOBINA 220-50/60 PER VAL.SOL.CASTEL	COIL 220-50/60 FOR SOLENOIDE VALVE	SPUL 220-50/60 FÜR SOLENOID-VENTIL	BOBINE 220-50/60 P/SOUPAPE SOLENOIDE
3	RA714017		CONNETTORE PG11 X VALV. SOL. CASTEL	CONNECTOR PG11 F. SOLENOIDE VALVE	VERBINDFER PG11 FÜR SOLENOID-VENTIL	CONNECTEUR PG11 P. SOUPAPE SOLENOID
3	RA090015		CONDEN. 2522-16T-5R-380-SP3.5-5AL	CONDENSER 2522-16T-5R-380-SP3.5-5AL	KONDENSER 2522-16T-5R-380-SP3.5-5AL	CONDENSATEUR 2522-16T-5R-380-SP3.5-5AL
1	RA073006		COMPRESSORE ASPERA J9232GS	COMPRESSOR ASPERA J2212GS	KOMPRESSOR ASPERA J2212GS	COMPRESSEUR ASPERA J2212GS
	RA953005		PRESSOSTATO ALTA RANCO 063P104000	PRESSURE SWITCH – HIGH PRESSURE	DRUCKWÄCHTER – HOCH DRUCK	PRESSOSTAT – PRESSION HAUTE
	RA919008		SUONERIA DB 20 24V	BUZZER DB 20 24V	SUMMER DB 20 24V	SONNERIE DB 20 24V
	RA130005		ADESIVI ATTENZIONE400V""	ADHESIVE WARNING 400V	KLEBSTOFF ACHTUNG 400V	ADHESIF ATTENTION 400V
	RA986501		FUSIBILE 2A F5020K2A	FUSE 2A F5020K2A	SCHMELZSICHERUNG 2A F5020K2A	FUSIBLE 2A F5020K2A
	RA986502		FUSIBILE 400 MA 5X20F	FUSE 400 MA 5X20F	SCHMELZSICHERUNG 400 MA 5X20F	FUSIBLE 400 MA 5X20F
	RA986503		FUSIBILE 4A F5020K4A	FUSE 4A F5020K4A	SCHMELZSICHERUNG 4A F5020K4A	FUSIBLE 4A F5020K4A

00	Prima emissione	15/04/99	Fontanive	Zambon
REV.	MODIFICHE	DATA	FIRMA	VISTO
	COD. XESH6X02		PAG. 21	

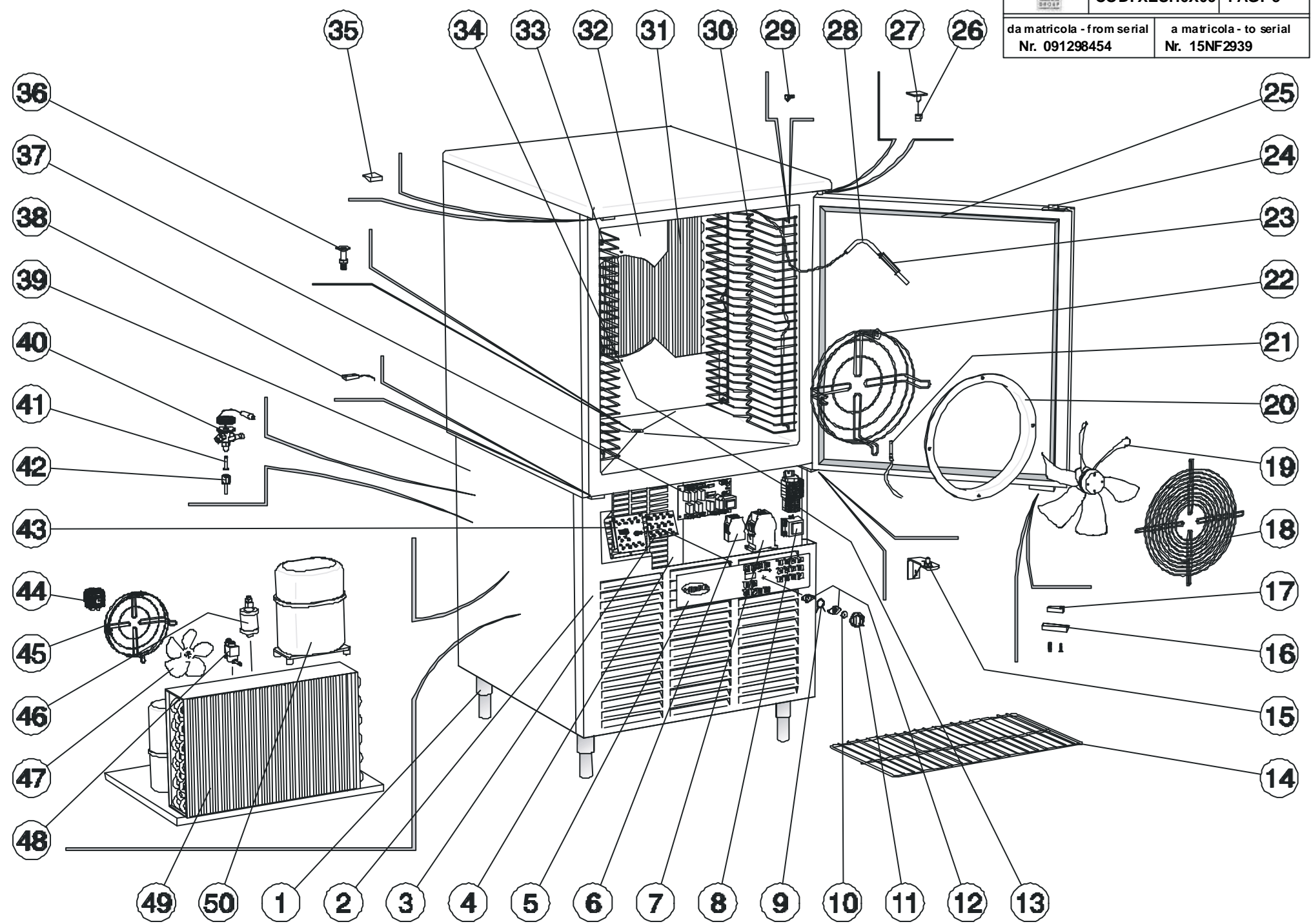

	COD.	REV.	DESCRIZIONE	DESCRIPTION	BESCHREIBUNG	DESCRIPTION
1	RA191002		PIEDINO ACCIAIO INOX 11/4x120"	STAINLESS STEEL FOOT 11/4x120"	EDELSTAHL FUSS 11/4x120"	PIED EN ACIER INOX 11/4x120"
2	RF360004		ASS.CRUSCOTTO 110	FRONT PANEL FOR MOD. 110	VORDERPANEEL FÜR MOD. 110	PANNEAU FRONTAL POUR MOD. 110
3	RA910062		SCHEDA PROGRAMMI AL001DA060	PROGRAMS CARD AL001DA060	PROGRAMM-PLATINE AL001DA060	FICHE PROGRAMME AL001DA060
4	RG860007		SCHIENA VANO MOTORE 110	BACK PANEL F. ENGINE COMPART. 110	RÜCK FÜR MOTORRAUM 110	DOS POUR COMPARTIMENT MOTEUR 110
5	RA130045		MASC. TASTIERA + PROG.POS.110-210 H	POSITIVE KEYBOARD PLATE + PROGRAM. 110 – 210 H	POSITIVE TASTATURFOLIE + PROGRAM. 110 – 210 H	MASQUE PLATINE POSITIVE + PROGRAM. 110 – 210 H
6	RA980002		TERMICO 3UA5000-1F 3.2-5 A	THERMAL 3UA5000-1F 3.2-5A	WAERMESCHUTZ 3UA5000-1F 3.2-5A	INTERRUPTEUR 3UA5000-1F 3.2-5 A
7	RA890007		TELERUTTORE 3TF4011-OAUO 240V	ELECTROMAGNETIC SWITCH 3TF4011-OAUO	FERNSCHALTER 3TF4011-OAUO 240V	TELERUPTEUR 3TF4011-OAUO 240V
8			NON INSTALLATO	NOT INSTALLED	NICHT INSTALLIERT	PAS MONTE
9	RA919006		MOLLA POTENZIOMETRO SCHEDA P""	CARD POTENTIOMETER SPRING P""	POTENTIOMETER FEDER VON P"PLATINE"	RESSORT POTENTIOMETRE FICHE P""
10	RA919010		GUARNIZIONE MANOPOLA PER 2/3	SEAL FOR KNOB FOR 2/3	DICHTUNG F. KNEBEL F. 2/3	GARNITURE MANETTE P/ 2-3
11	RA919005		MANOPOLA POTENZIOMETRO	POTENTIOMETER CONTROL KNOB	KNEBEL FUER POTENTIOMETER	MANETTE P/POTENTIOMETRE
12	RA919009		SUPP.MOLLA POTENZ.SCHEDE D-H-P	SUPPORT F. D-H"CARDPOTENZ.SPRING"	HALTERR. F. POTENZ. FEDER F. PLATIN	SUPPORT RESSORT P/POTENT.FICHE D-H
13	RA850005		MORSETTIERA LX2 (TIPO 2)	TERMINAL BOARD LX2 (TYPE 2)	KLEMMKASTEN LX2 (TYP 2)	BORNE LX2 (TYPE 2)
14	RA170009		GRIGLIA PAST. 600X400 AISI304	PASTRY GRID 600X400 AISI304	KONDITOREIROST 600X400 AISI304	GRILLE PATISSERIE 600X400 AISI304
15	RF200003		ASS. CERNIERA INF. PORTA 110-210	LOWER HINGE FOR DOOR 110 - 210	UNTERES SCHARNIER F.TÜR 110 - 210	CHARNIERE INFERIEURE P/PORTE 110 – 210
16	RG830009		SCATOLA MAGNETE	MAGNETO BOX	MAGNET-KASTEN	BOITE MAGNETO
17	RA840005		UNITA' MAGNETICA	MAGNETIC UNIT	MAGNETEINHEIT	UNITE MAGNETIQUE
18	RA170019		GRIGLIA PROT.VENT.400 V"INOX"	PROTECTION GRID FOR FAN 400 V""	SCHUTZGITTER FÜR VENTILATOR 300	GRILLE PROTECTION VENTILATEUR 300
19	RA880011		MOTOVENT. A4E400-AA06-17 (110-C20)	FAN A4E400-AA06-17 (110-C20)	VENTILATOR A4E400-AA06-17 (110-C20)	VENTILATEUR A4E400-AA06-17 (110-C20)
20	RA110013		BOCCAGLIO VENT. 400 AL.	FAN CONVEYOR 400 AL.	VENTILATOR-KONVEYOR 400 AL.	EMBOUT VENTILATEUR 400 AL.
21	RA930008		SONDA PTC L.2500 SILICONE	PROBE PTC L.2500	FÜHLER PTC L. 2500	SONDE PTC L.2500
22	RA170036		GRIGLIA SOST.VENT.400 V"INOX"	SUPPORT GRID FOR FAN 400 V""	GITTERHALTER FÜR VENTILATOR 400V	SUPPORT GRILLE VENTILATEUR 400V
23	RA570003		ASS. PORTASONDE SPILLONE	PROBE SUPPORT FOR PRICKER PROBE	FÜHLERHALTER FUER NADELFUEHLER	PORTE-SONDE P/AGUILLE
24	RZ960029		KIT SCROCCHETTO	CATCH KIT	SCHNAPPER KIT	KIT ENCLenchement
25	RA190036		GUARNIZIONE DI TENUTA	SEAL	DICHTUNG	GARNITURE
26	RA050001		BOCCOLA CERNIERA SUPER.PORTA	BUSH FOR UPPER DOOR HINGE	BUCHSE F. OBERSCHARNIER DER TUEr	DOUILLE P/CHARNIERE SUP.PORTE
27	RF200005		ASS. CERNIERA SUP. PORTA	UPPER HINGE FOR DOOR	OBERES SCHARNIER FÜR TÜR	CHARNIERE SUPERIEURE PORTE
28	RA930004		SONDA INF.PTC 3X100 3MT SILIC.	CORE PROBE 3X100 3M	KERNFUEHLER 3X100 3M	SONDE AU COEUR
29	RA470005		PERNO SUPPORTO PARATIA F4 2/3	PIN FOR TRAY SUPPORT	BOLZEN FÜR SCHALEHALTER	PIVOT P/PORTE-PLAQUES 3X100 3MT
30	RA175009		ASS. PARATIA 110 GASTR.	SUPPORT FOR GN TRAY	GN SCHALENHALTER FÜR MOD. 110	CLOISON PORTE-PLAQUES POUR MOD. 110
31	RA140004		EVAPORATORE 4R26T X ABB.110	EVAPORATOR 4R26T FOR MOD. 110	VERDÄMPFER 4R26T FÜR MOD. 110	EVAPORATEUR 4R26T POUR MOD. 110
32	RG310004		CONVOGLIATORE 110-C20	FAN COVERING 110-C20	VENTILATORABDECKUNG 110-C20	COUVRE VENTILATEUR 110-C20
33	RA175009		ASS. PARATIA 110 GASTR.	SUPPORT FOR GN TRAY	GN SCHALENHALTER FÜR MOD. 110	CLOISON PORTE-PLAQUES POUR MOD. 110
34	RA850001		PORTAFUSIBILE BARRA DIN	FUSE CARRIER FOR DIN-BAR	SICHERUNGSKOERPER FÜR DIN-STANGE	CORPS FUSIBLE P/BARRE DIN
35	RA494001		AGGANCIO SCROCCHETTO	CATCH SEAT	AUFNAHME FÜR SCHNAPPER	ARRET D'ENCLenchement
36	RA651000		PILETTA SCARICO COMPL.3/4 L=30	DRAIN STRAINER 3/4 L= 30	BECKENAUSLAUF 3/4 L=30	CREPINE VIDANGE 3/4 L=30



37	RA910060		SCHEDA BASE 7 RELE' AL001BA060	MASTER CARD – 7 RELAIS AL001BA060	HAUPTPLATINE – 7 RELAIS AL001BA060	FICHE BASE – 7 RELAIS AL001BA060
38	RA840004		SENSORE MAGNETICO	MAGNETIC SENSOR	MAGNETSENSOR	CAPTEUR MAGNETIQUE
39	RG370003		FIANCO VANO MOTORE 110	SIDE PANEL F. ENGINE COMPARTMENT 110	SEITENWAND	COTE COMPARTIMENT MOTEUR 110
40	RA715017		CORPO VALVOLA TES2 R404A ODF	VALVE BODY TES2 R404A ODF	VENTILKOERPER TES2 R404A ODF	CORPS SOUPAPE TES2 R404A ODF
41	RA716019		ORIFICIO N° 03 C/FILTRO ODF	ORIFICE N° 03 WITH FILTER ODF	ÖFFNUNG N°03 MIT FILTER ODF	ORIFICE N°03 AVEC FILTRE ODF
42	RA716502		ADATTATORE A BRASARE X T-TE D.10	ADAPTER FOR T-TE D.10	ADAPTER FÜR T-TE D.10	ADAPTATEUR POUR T-TE D.10
43	RA910065		SCHEDA TASTIERA AL001DA055	KEYBOARD CARD AL001DA055	TASTATUR-PLATINE AL001DA055	FICHE CLAVIER AL001DA055
44	RA880035		MOTOVENT. EBM AE350-AP06-01	MOTOR FOR FAN EBM AE350-AP06-01	MOTOR F. VENTILATEUR EBM AE350-AP06-01	MOTEUR VENTILATEUR EBM AE350-AP06-01
45	RA170052		GRIGLIA EBM 64560-2-4039 PER GR 350	GRID EBM 64560-2-4039 FOR GR 350	GITTER EBM 64560-2-4039 FÜR GR 350	GRILLE EBM 64560-2-4039 POUR GR 350
46	RA012009		FILTRO DEIDR. CASTEL 4308/3S	DEHYDRATION FILTER 4308/3S	WASSERENTZIEHUNG-FILTER 4308/3S	FILTRE DEHYDRATATION 4308/3S
47			INCLUSO IN PARTICOLARE 44	INCLUDED IN POS. 44	IM POS. 44 ENTHÄLT	INCLUS A LA POS. 43
48	RA714014		VALV. SOL.Ø10 SALD.CASTEL 1068/M10S	CASTEL SOLENOIDE VALVE 10 1068/M10S	CASTEL SOLENOID-VENTIL 10 1068/M10S	SOUPAPE SOLENOIDE CASTEL 10 1068/M10S
48	RA714016		BOBINA 220-50/60 PER VAL.SOL.CASTEL	COIL 220-50/60 FOR SOLENOIDE VALVE	SPUL 220-50/60 FÜR SOLENOID-VENTIL	BOBINE 220-50/60 P/SOUPAPE SOLENOIDE
48	RA714017		CONNETTORE PG11 X VALV. SOL. CASTEL	CONNECTOR PG11 F. SOLENOIDE VALVE	VERBINDER PG11 FÜR SOLENOID-VENTIL	CONNECTEUR PG11 P. SOUPAPE SOLENOIDE
49	RA090015		CONDEN. 2522-16T-5R-380-SP3.5-5AL	CONDENSER 2522-16T-5R-380-SP3.5-5AL	KONDENSER 2522-16T-5R-380-SP3.5-5AL	CONDENSATEUR 2522-16T-5R-380-SP3.5-5AL
50	RA073006		COMPRESSORE ASPERA J9232GS	COMPRESSOR ASPERA J2212GS	KOMPRESSOR ASPERA J2212GS	COMPRESSEUR ASPERA J2212GS
	RA953005		PRESSOSTATO ALTA RANCO 063P104000	PRESSURE SWITCH – HIGH PRESSURE	DRUCKWÄCHTER – HOCH DRUCK	PRESSOSTAT – PRESSION HAUTE
	RA919008		SUONERIA DB 20 24V	BUZZER DB 20 24V	SUMMER DB 20 24V	SONNERIE DB 20 24V
	RA130005		ADESIVI "ATTENZIONE 400V"	ADHESIVE WARNING 400V	KLEBSTOFF ACHTUNG 400V	ADHESIF ATTENTION 400V
	RA986501		FUSIBILE 2A F5020K2A	FUSE 2A F5020K2A	SCHMELZSICHERUNG 2A F5020K2A	FUSIBLE 2A F5020K2A
	RA986502		FUSIBILE 400 MA 5X20F	FUSE 400 MA 5X20F	SCHMELZSICHERUNG 400 MA 5X20F	FUSIBLE 400 MA 5X20F
	RA986503		FUSIBILE 4A F5020K4A	FUSE 4A F5020K4A	SCHMELZSICHERUNG 4A F5020K4A	FUSIBLE 4A F5020K4A

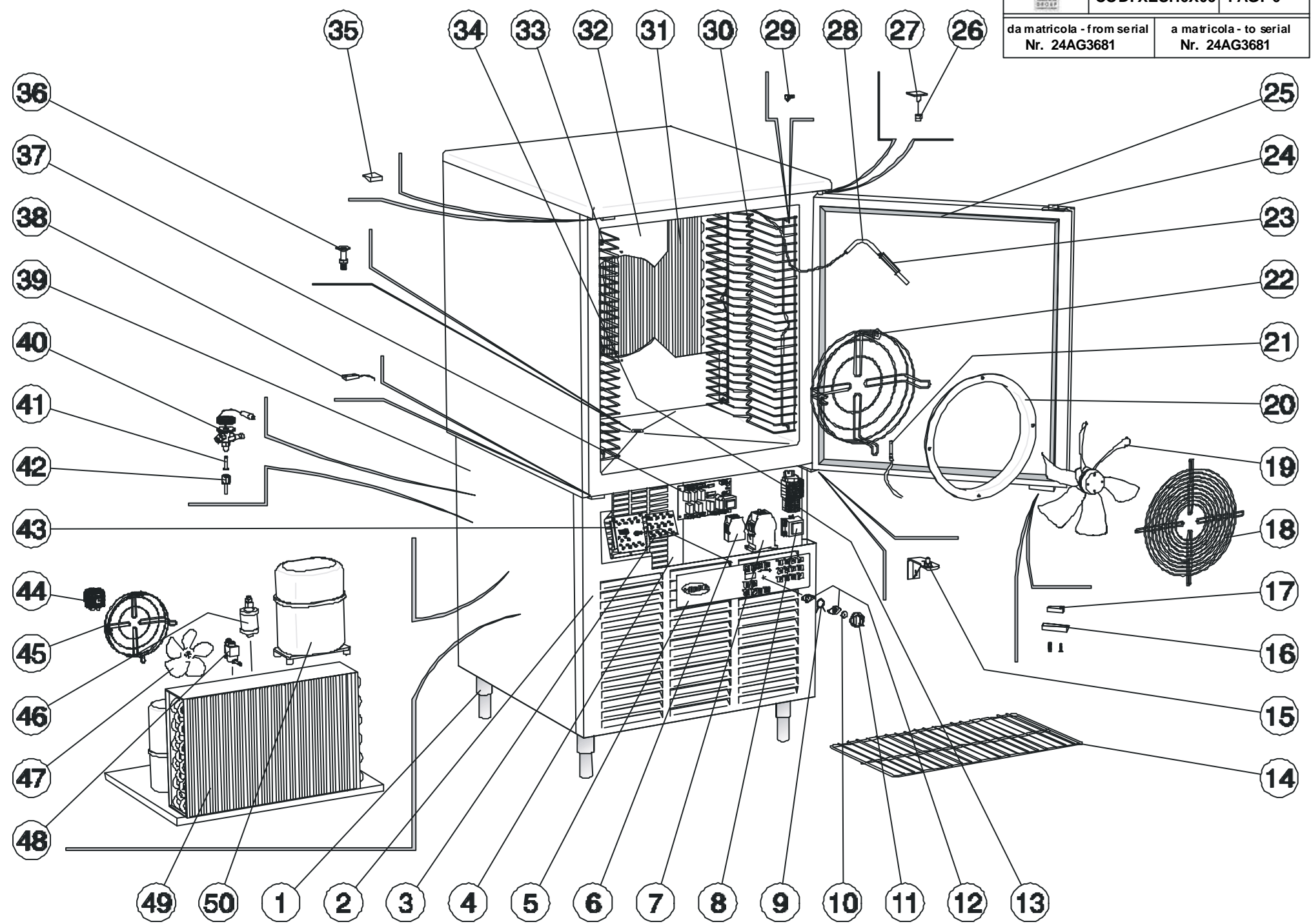

	COD.	REV.	DESCRIZIONE	DESCRIPTION	BESCHREIBUNG	DESCRIPTION
1	RA191002		PIEDINO ACCIAIO INOX 11/4x120"	STAINLESS STEEL FOOT 11/4x120"	EDELSTAHL FUSS 11/4x120"	PIED EN ACIER INOX 11/4x120"
2	RF360004		ASS.CRUSCOTTO 110	FRONT PANEL FOR MOD. 110	VORDERPANEEL FÜR MOD. 110	PANNEAU FRONTAL POUR MOD. 110
3	RA910062		SCHEDA PROGRAMMI AL001DA060	PROGRAMS CARD AL001DA060	PROGRAMM-PLATINE AL001DA060	FICHE PROGRAMME AL001DA060
4	RG860007		SCHIENA VANO MOTORE 110	BACK PANEL F. ENGINE COMPART. 110	RÜCK FÜR MOTORRAUM 110	DOS POUR COMPARTIMENT MOTEUR 110
5	RA130108		MASCH.TAST. "NEW S"	POSITIVE KEYBOARD PLATE – "NEW S"	POSITIVE TASTATURFOLIE – "NEW S"	MASQUE PLATINE POSITIVE – "NEW S"
6	RA980002		TERMICO 3UA5000-1F 3.2-5 A	THERMAL 3UA5000-1F 3.2-5A	WAERMESCHUTZ 3UA5000-1F 3.2-5A	INTERRUPTEUR 3UA5000-1F 3.2-5 A
7	RA890007		TELERUTTORE 3TF4011-OAUO 240V	ELECTROMAGNETIC SWITCH 3TF4011-OAUO	FERNSCHALTER 3TF4011-OAUO 240V	TELERUPTEUR 3TF4011-OAUO 240V
8			NON INSTALLATO	NOT INSTALLED	NICHT INSTALLIERT	PAS MONTE
9	RA919006		MOLLA POTENZIOMETRO SCHEDA P""	CARD POTENTIOMETER SPRING P""	POTENTIOMETER FEDER VON P"PLATINE"	RESSORT POTENTIOMETRE FICHE P""
10	RA919010		GUARNIZIONE MANOPOLA PER 2/3	SEAL FOR KNOB FOR 2/3	DICHTUNG F. KNEBEL F. 2/3	GARNITURE MANETTE P/ 2-3
11	RA919005		MANOPOLA POTENZIOMETRO	POTENTIOMETER CONTROL KNOB	KNEBEL FUER POTENTIOMETER	MANETTE P/POTENTIOMETRE
12	RA919009		SUPP.MOLLA POTENZ.SCHEDE D-H-P	SUPPORT F. D-H"CARDPOTENZ.SPRING"	HALTERR. F. POTENZ. FEDER F. PLATIN	SUPPORT RESSORT P/POTENT.FICHE D-H
13	0101259		MORSETTO TERMINALE	TERMINAL JUNCTION BLOCK	ENDKLEMME	BORNE TERMINAL
13a	0101262		CONTRASSEGNO (L1)	BLOCK MARK (L1)	KLEMMENZEICHEN (L1)	MARQUAGE BORNE (L1)
13b	0101263		CONTRASSEGNO (L2)	BLOCK MARK (L2)	KLEMMENZEICHEN (L2)	MARQUAGE BORNE (L2)
13c	0101264		CONTRASSEGNO (L1)	BLOCK MARK (L3)	KLEMMENZEICHEN (L3)	MARQUAGE BORNE (L3)
13d	0101265		CONTRASSEGNO (TERRA)	BLOCK MARK (EARTH)	KLEMMENZEICHEN (ERDE)	MARQUAGE BORNE (TERRE)
13e	0101266		CONTRASSEGNO (N)	BLOCK MARK (N)	KLEMMENZEICHEN (N)	MARQUAGE BORNE (N)
13f	RA850026		MORSETTO TRIPLICE (FASE)	TRIPLEX BLOCK (PHASE)	DREIFACHKLEMME (PHASE)	TRIPLE BORNE (PHASE)
13g	RA850027		MORSETTO SINGOLO (TERRA)	SINGLE BLOCK (EARTH)	EINZELKLEMME (ERDE)	BORNE SINGULIERE (TERRE)
13h	RA850028		MORSETTO SINGOLO (NEUTRO)	SINGLE BLOCK (NEUTRAL)	EINZELKLEMME (NEUTRAL)	BORNE SINGULIERE (NEUTRE)
13i	RA981012		BARRA DIN	BLOCK RAIL	HUTSCHIENE	BARRE SUPPORT BORNE
14	RA170009		GRIGLIA PAST. 600X400 AISI304	PASTRY GRID 600X400 AISI304	KONDITOREIROST 600X400 AISI304	GRILLE PATISSERIE 600X400 AISI304
15	RF200003		ASS. CERNIERA INF. PORTA 110-210	LOWER HINGE FOR DOOR 110 - 210	UNTERES SCHARNIER F.TÜR 110 - 210	CHARNIERE INFERIEURE P/PORTE 110 – 210
16	RG830009		SCATOLA MAGNETE	MAGNETO BOX	MAGNET-KASTEN	BOITE MAGNETO
17	RA840005		UNITA' MAGNETICA	MAGNETIC UNIT	MAGNETEINHEIT	UNITE MAGNETIQUE
18	RA170019		GRIGLIA PROT.VENT.400 V""INOX"	PROTECTION GRID FOR FAN 400 V""	SCHUTZGITTER FÜR VENTILATOR 300	GRILLE PROTECTION VENTILATEUR 300
19	RA880011		MOTOVENT. A4E400-AA06-17 (110-C20)	FAN A4E400-AA06-17 (110-C20)	VENTILATOR A4E400-AA06-17 (110-C20)	VENTILATEUR A4E400-AA06-17 (110-C20)
20	RA110013		BOCCAGLIO VENT. 400 AL.	FAN CONVEYOR 400 AL.	VENTILATOR-KONVEYOR 400 AL.	EMBOUT VENTILATEUR 400 AL.
21	RA930008		SONDA PTC L.2500 SILICONE	PROBE PTC L.2500	FÜHLER PTC L. 2500	SONDE PTC L.2500
22	RA170036		GRIGLIA SOST.VENT.400 V""INOX"	SUPPORT GRID FOR FAN 400 V""	GITTERHALTER FÜR VENTILATOR 400V	SUPPORT GRILLE VENTILATEUR 400V
23	RA570003		ASS. PORTASONDE SPILLONE	PROBE SUPPORT FOR PRICKER PROBE	FÜHLERHALTER FUER NADELFUEHLER	PORTE-SONDE P/AGUILLE
24	RZ960029		KIT SCROCCHETTO	CATCH KIT	SCHNAPPER KIT	KIT ENCLenchement
25	RA190036		GUARNIZIONE DI TENUTA	SEAL	DICHTUNG	GARNITURE
26	RA050001		BOCCOLA CERNIERA SUPER.PORTA	BUSH FOR UPPER DOOR HINGE	BUCHSE F. OBERSCHARNIER DER TUER	DOUILLE P/CHARNIERE SUP.PORTE
27	RF200005		ASS. CERNIERA SUP. PORTA	UPPER HINGE FOR DOOR	OBERES SCHARNIER FÜR TÜR	CHARNIERE SUPERIEURE PORTE
28	RA930004		SONDA INF.PTC 3X100 3MT SILIC.	CORE PROBE 3X100 3M	KERNFUEHLER 3X100 3M	SONDE AU COEUR
29	RA470005		PERNO SUPPORTO PARATIA F4 2/3	PIN FOR TRAY SUPPORT	BOLZEN FÜR SCHALEHALTER	PIVOT P/PORTE-PLAQUES 3X100 3MT
30	RA175009		ASS. PARATIA 110 GASTR.	SUPPORT FOR GN TRAY	GN SCHALENHALTER FÜR MOD. 110	CLOISON PORTE-PLAQUES POUR MOD. 110



31	RA140004		EVAPORATORE 4R26T X ABB.110	EVAPORATOR 4R26T FOR MOD. 110	VERDÄMPFER 4R26T FÜR MOD. 110	EVAPORATEUR 4R26T POUR MOD. 110
32	RG310004		CONVOGLIATORE 110-C20	FAN COVERING 110-C20	VENTILATORABDECKUNG 110-C20	COUVRE VENTILATEUR 110-C20
33	RA175009		ASS. PARATIA 110 GASTR.	SUPPORT FOR GN TRAY	GN SCHALENHALTER FÜR MOD. 110	CLOISON PORTE-PLAQUES POUR MOD. 110
34	RA850001		PORTAFUSIBILE BARRA DIN	FUSE CARRIER FOR DIN-BAR	SICHERUNGSKOERPER FÜR DIN-STANGE	CORPS FUSIBLE P/BARRE DIN
35	RG830039		FERMO SCROCCHETTO	CATCH SEAT	AUFNAHME FUER SCHNAPPER	ARRET D'ENCLenchement
36	RA651000		PILETTA SCARICO COMPL.3/4 L=30	DRAIN STRAINER 3/4 L= 30	BECKENAUFLAUF 3/4 L=30	CREPINE VIDANGE 3/4 L=30
37	RA910060		SCHEDA BASE 7 RELE' AL001BA060	MASTER CARD – 7 RELAIS AL001BA060	HAUPTPLATINE – 7 RELAIS AL001BA060	FICHE BASE – 7 RELAIS AL001BA060
38	RA840004		SENSORE MAGNETICO	MAGNETIC SENSOR	MAGNETSENSOR	CAPTEUR MAGNETIQUE
39	RG370003		FIANCO VANO MOTORE 110	SIDE PANEL F. ENGINE COMPARTMENT 110	SEITENWAND	COTE COMPARTIMENT MOTEUR 110
40	RA715017		CORPO VALVOLA TES2 R404A ODF	VALVE BODY TES2 R404A ODF	VENTILKOERPER TES2 R404A ODF	CORPS SOUPAPE TES2 R404A ODF
41	RA716019		ORIFICIO N° 03 C/FILTRO ODF	ORIFICE N° 03 WITH FILTER ODF	ÖFFNUNG N°03 MIT FILTER ODF	ORIFICE N°03 AVEC FILTRE ODF
42	RA716502		ADATTATORE A BRASARE X T-TE D.10	ADAPTER FOR T-TE D.10	ADAPTER FÜR T-TE D.10	ADAPTATEUR POUR T-TE D.10
43	RA910070		SCHEDA TASTIERA CT1SI0020101	CARD FOR KEYBOARD CT1SI0020101	PLATINE FÜR TASTATUR CT1SI0020101	FICHE CLAVIER P/ PLATINE CT1SI0020101
44	RA880035		MOTOVENT. EBM AE350-AP06-01	MOTOR FOR FAN EBM AE350-AP06-01	MOTOR F. VENTILATEUR EBM AE350-AP06-01	MOTEUR VENTILATEUR EBM AE350-AP06-01
45	RA170052		GRIGLIA EBM 64560-2-4039 PER GR 350	GRID EBM 64560-2-4039 FOR GR 350	GITTER EBM 64560-2-4039 FÜR GR 350	GRILLE EBM 64560-2-4039 POUR GR 350
46	RA012009		FILTRO DEIDR. CASTEL 4308/3S	DEHYDRATION FILTER 4308/3S	WASSERENTZIEHUNG-FILTER 4308/3S	FILTRE DEHYDRATATION 4308/3S
47			INCLUSO IN PARTICOLARE 44	INCLUDED IN POS. 44	IM POS. 44 ENTHÄLT	INCLUS A LA POS. 43
48	RA714014		VALV. SOL.Ø10 SALD.CASTEL 1068/M10S	CASTEL SOLENOIDE VALVE 10 1068/M10S	CASTEL SOLENOID-VENTIL 10 1068/M10S	SOUPAPE SOLENOIDE CASTEL 10 1068/M10S
48	RA714016		BOBINA 220-50/60 PER VAL.SOL.CASTEL	COIL 220-50/60 FOR SOLENOIDE VALVE	SPUL 220-50/60 FÜR SOLENOID-VENTIL	BOBINE 220-50/60 P/SOUPAPE SOLENOIDE
48	RA714017		CONNETTORE PG11 X VALV. SOL. CASTEL	CONNECTOR PG11 F. SOLENOIDE VALVE	VERBINDFER PG11 FÜR SOLENOID-VENTIL	CONNECTEUR PG11 P. SOUPAPE SOLENOIDE
49	RA090015		CONDEN. 2522-16T-5R-380-SP3.5-5AL	CONDENSER 2522-16T-5R-380-SP3.5-5AL	KONDENSER 2522-16T-5R-380-SP3.5-5AL	CONDENSATEUR 2522-16T-5R-380-SP3.5-5AL
50	RA073006		COMPRESSORE ASPERA J9232GS	COMPRESSOR ASPERA J2212GS	KOMPRESSOR ASPERA J2212GS	COMPRESSEUR ASPERA J2212GS
	RA953005		PRESSOSTATO ALTA RANCO 063P104000	PRESSURE SWITCH – HIGH PRESSURE	DRUCKWÄCHTER – HOCH DRUCK	PRESSOSTAT – PRESSION HAUTE
	RA919008		SUONERIA DB 20 24V	BUZZER DB 20 24V	SUMMER DB 20 24V	SONNERIE DB 20 24V
	RA130005		ADESIVI "ATTENZIONE 400V"	ADHESIVE WARNING 400V	KLEBSTOFF ACHTUNG 400V	ADHESIF ATTENTION 400V
	RA986501		FUSIBILE 2A F5020K2A	FUSE 2A F5020K2A	SCHMELZSICHERUNG 2A F5020K2A	FUSIBLE 2A F5020K2A
	RA986502		FUSIBILE 400 MA 5X20F	FUSE 400 MA 5X20F	SCHMELZSICHERUNG 400 MA 5X20F	FUSIBLE 400 MA 5X20F
	RA986503		FUSIBILE 4A F5020K4A	FUSE 4A F5020K4A	SCHMELZSICHERUNG 4A F5020K4A	FUSIBLE 4A F5020K4A

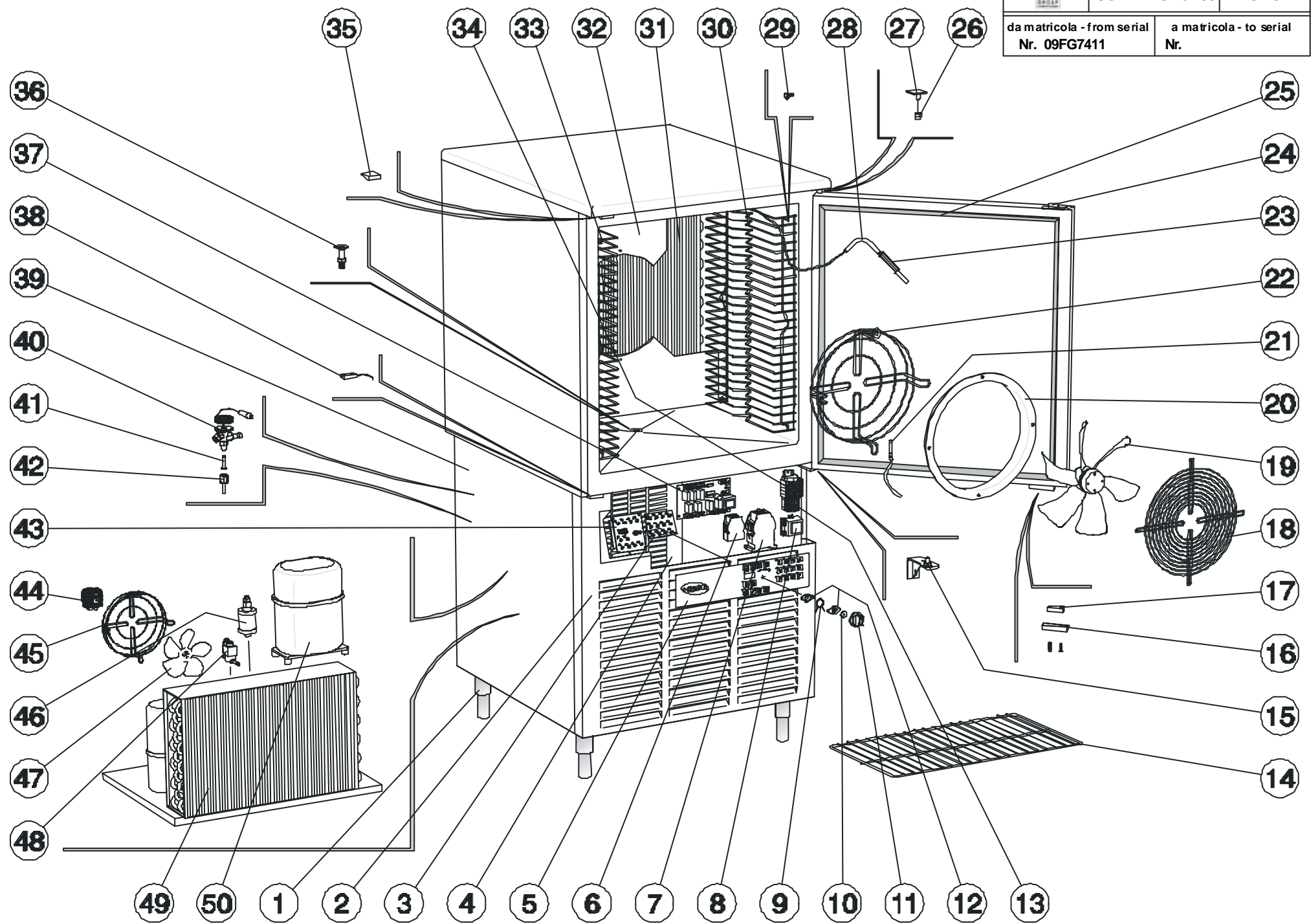

	COD.	REV.	DESCRIZIONE	DESCRIPTION	BESCHREIBUNG	DESCRIPTION
1	RA191002		PIEDINO ACCIAIO INOX 11/4x120"	STAINLESS STEEL FOOT 11/4x120"	EDELSTAHL FUSS 11/4x120"	PIED EN ACIER INOX 11/4x120"
2	RF360004		ASS.CRUSCOTTO 110	FRONT PANEL FOR MOD. 110	VORDERPANEEL FÜR MOD. 110	PANNEAU FRONTAL POUR MOD. 110
3	RA910062		SCHEDA PROGRAMMI AL001DA060	PROGRAMS CARD AL001DA060	PROGRAMM-PLATINE AL001DA060	FICHE PROGRAMME AL001DA060
4	RG860007		SCHIENA VANO MOTORE 110	BACK PANEL F. ENGINE COMPART. 110	RÜCK FÜR MOTORRAUM 110	DOS POUR COMPARTIMENT MOTEUR 110
5	RA130108		MASCH.TAST. "NEW S"	POSITIVE KEYBOARD PLATE – "NEW S"	POSITIVE TASTATURFOLIE – "NEW S"	MASQUE PLATINE POSITIVE – "NEW S"
6	RA980002	S	TERMICO 3UA5000-1F 3.2-5 A FINO AL 06/02/01	THERMAL 3UA5000-1F 3.2-5A UP TO 06/02/01	WAERMESCHUTZ 3UA5000-1F 3.2-5A BIS ZUM 06/02/01	INTERRUPTEUR 3UA5000-1F 3.2-5A JUSQU'AU 06/02/01
6	RA980009		TERMICO ABB TA25DU4 2.8 - 4 A DAL 06/02/01	THERMAL ABB TA25DU4 2.8 - 4 A FROM 06/02/01	WAERMESCHUTZ ABB TA25DU4 2.8 - 4 A VOM 06/02/01	INTERRUPTEUR ABB TA25DU4 2.8 - 4 A DU 06/02/01
7	RA890007		TELERUTTORE 3TF4011-OAUO 240V	ELECTROMAGNETIC SWITCH 3TF4011-OAUO	FERNSCHALTER 3TF4011-OAUO 240V	TELERUPTEUR 3TF4011-OAUO 240V
8			NON INSTALLATO	NOT INSTALLED	NICHT INSTALLIERT	PAS MONTE
9	RA919006		MOLLA POTENZIOMETRO SCHEDA P'''	CARD POTENTIOMETER SPRING P'''	POTENTIOMETER FEDER VON P"PLATINE"	RESSORT POTENTIOMETRE FICHE P'''
10	RA919010		GUARNIZIONE MANOPOLA PER 2/3	SEAL FOR KNOB FOR 2/3	DICHTUNG F. KNEBEL F. 2/3	GARNITURE MANETTE P/ 2-3
11	RA919005		MANOPOLA POTENZIOMETRO	POTENTIOMETER CONTROL KNOB	KNEBEL FUER POTENTIOMETER	MANETTE P/POTENTIOMETRE
12	RA919009		SUPP.MOLLA POTENZ.SCHEDE D-H-P	SUPPORT F. D-H"CARDPOTENZ.SPRING"	HALTERR. F. POTENZ. FEDER F. PLATIN	SUPPORT RESSORT P/POTENT.FICHE D-H
13	0101259		MORSETTO TERMINALE	TERMINAL JUNCTION BLOCK	ENDKLEMME	BORNE TERMINAL
13a	0101262		CONTRASSEGNO (L1)	BLOCK MARK (L1)	KLEMMENZEICHEN (L1)	MARQUAGE BORNE (L1)
13b	0101263		CONTRASSEGNO (L2)	BLOCK MARK (L2)	KLEMMENZEICHEN (L2)	MARQUAGE BORNE (L2)
13c	0101264		CONTRASSEGNO (L3)	BLOCK MARK (L3)	KLEMMENZEICHEN (L3)	MARQUAGE BORNE (L3)
13d	0101265		CONTRASSEGNO (TERRA)	BLOCK MARK (EARTH)	KLEMMENZEICHEN (ERDE)	MARQUAGE BORNE (TERRE)
13e	0101266		CONTRASSEGNO (N)	BLOCK MARK (N)	KLEMMENZEICHEN (N)	MARQUAGE BORNE (N)
13f	RA850026		MORSETTO TRIPLICE (FASE)	TRIPLEX BLOCK (PHASE)	DREIFACHKLEMME (PHASE)	TRIPLE BORNE (PHASE)
13g	RA850027		MORSETTO SINGOLO (TERRA)	SINGLE BLOCK (EARTH)	EINZELKLEMME (ERDE)	BORNE SINGULIERE (TERRE)
13h	RA850028		MORSETTO SINGOLO (NEUTRO)	SINGLE BLOCK (NEUTRAL)	EINZELKLEMME (NEUTRAL)	BORNE SINGULIERE (NEUTRE)
13i	RA981012		BARRA DIN	BLOCK RAIL	HUTSCHIENE	BARRE SUPPORT BORNE
14	RA170009		GRIGLIA PAST. 600X400 AISI304	PASTRY GRID 600X400 AISI304	KONDITOREIROST 600X400 AISI304	GRILLE PATISserie 600X400 AISI304
15	RF200003		ASS. CERNIERA INF. PORTA 110-210	LOWER HINGE FOR DOOR 110 - 210	UNTERES SCHARNIER F.TÜR 110 - 210	CHARNIERE INFERIEURE P/PORTE 110 – 210
16	RG830009		SCATOLA MAGNETE	MAGNETO BOX	MAGNET-KASTEN	BOITE MAGNETO
17	RA840005		UNITA' MAGNETICA	MAGNETIC UNIT	MAGNETEINHEIT	UNITE MAGNETIQUE
18	RA170019		GRIGLIA PROT.VENT.400 V"INOX"	PROTECTION GRID FOR FAN 400 V'''	SCHUTZGITTER FÜR VENTILATOR 300	GRILLE PROTECTION VENTILATEUR 300
19	RA880011		MOTOVENT. A4E400-AA06-17 (110-C20)	FAN A4E400-AA06-17 (110-C20)	VENTILATOR A4E400-AA06-17 (110-C20)	VENTILATEUR A4E400-AA06-17 (110-C20)
20	RA110013		BOCCAGLIO VENT. 400 AL.	FAN CONVEYOR 400 AL.	VENTILATOR-KONVEYOR 400 AL.	EMBOUT VENTILATEUR 400 AL.
21	RA930008		SONDA PTC L.2500 SILICONE	PROBE PTC L.2500	FÜHLER PTC L. 2500	SONDE PTC L.2500
22	RA170036		GRIGLIA SOST.VENT.400 V"INOX"	SUPPORT GRID FOR FAN 400 V'''	GITTERHALTER FÜR VENTILATOR 400V	SUPPORT GRILLE VENTILATEUR 400V
23	RG830038		SUPPORTO SX SONDA AL CUORE	CORE PROBE SUPPORT	KERNFÜHLERHALTER	PORTE-SONDE AU COEUR
24	RZ960029		KIT SCROCCHETTO	CATCH KIT	SCHNAPPER KIT	KIT ENCLenchement
25	RA190036		GUARNIZIONE DI TENUTA	SEAL	DICHTUNG	GARNITURE
26	RA050001		BOCCOLA CERNIERA SUPER.PORTA	BUSH FOR UPPER DOOR HINGE	BUCHSE F. OBERSCHARNIER DER TÜR	DOUILLE P/CHARNIERE SUP.PORTE
27	RF200005		ASS. CERNIERA SUP. PORTA	UPPER HINGE FOR DOOR	OBERES SCHARNIER FÜR TÜR	CHARNIERE SUPERIEURE PORTE
28	RA930010	C	SONDA AISI INF. S/RISC. PTC 3MT SIL.	HEATED CORE PROBE	GEHEIZTER KERNFUEHLER	SONDE AU COEUR CHAUFFEE
29	RA470005		PERNO SUPPORTO PARATIA F4 2/3	PIN FOR TRAY SUPPORT	BOLZEN FÜR SCHALEHALTER	PIVOT P/PORTE-PLAQUES 3X100 3MT
30	RA175009		ASS. PARATIA 110 GASTR.	SUPPORT FOR GN TRAY	GN SCHALENHALTER FÜR MOD. 110	CLOISON PORTE-PLAQUES POUR MOD. 110

31	RA140004		EVAPORATORE 4R26T X ABB.110	EVAPORATOR 4R26T FOR MOD. 110	VERDÄMPFER 4R26T FÜR MOD. 110	EVAPORATEUR 4R26T POUR MOD. 110
32	RG310004		CONVOGLIATORE 110-C20	FAN COVERING 110-C20	VENTILATORABDECKUNG 110-C20	COUVRE VENTILATEUR 110-C20
33	RA175009		ASS. PARATIA 110 GASTR.	SUPPORT FOR GN TRAY	GN SCHALENHALTER FÜR MOD. 110	CLOISON PORTE-PLAQUES POUR MOD. 110
34	RA850001		PORTAFUSIBILE BARRA DIN	FUSE CARRIER FOR DIN-BAR	SICHERUNGSKOERPER FÜR DIN-STANGE	CORPS FUSIBLE P/BARRE DIN
35	RG830039		FERMO SCROCCHETTO	CATCH SEAT	AUFNAHME FUER SCHNAPPER	ARRET D'ENCLenchement
36	RA651002		PILETTA SCARICO 1" L=70	DRAIN STRAINER 1" L=70	BECKENAUSLAUF 1" L=70	CREPINE VIDANGE 1" L=70
37	RA910060		SCHEDA BASE 7 RELE' AL001BA060	MASTER CARD – 7 RELAIS AL001BA060	HAUPTPLATINE – 7 RELAIS AL001BA060	FICHE BASE – 7 RELAIS AL001BA060
38	RA840004		SENSORE MAGNETICO	MAGNETIC SENSOR	MAGNETSENSOR	CAPTEUR MAGNETIQUE
39	RG370003		FIANCO VANO MOTORE 110	SIDE PANEL F. ENGINE COMPARTMENT 110	SEITENWAND	COTE COMPARTIMENT MOTEUR 110
40	RA715017		CORPO VALVOLA TES2 R404A ODF	VALVE BODY TES2 R404A ODF	VENTILKOERPER TES2 R404A ODF	CORPS SOUPAPE TES2 R404A ODF
41	RA716019		ORIFICIO N° 03 C/FILTRO ODF	ORIFICE N° 03 WITH FILTER ODF	ÖFFNUNG N°03 MIT FILTER ODF	ORIFICE N°03 AVEC FILTRE ODF
42	RA716502		ADATTATORE A BRASARE X T-TE D.10	ADAPTER FOR T-TE D.10	ADAPTER FÜR T-TE D.10	ADAPTATEUR POUR T-TE D.10
43	RA910070		SCHEDA TASTIERA CT1SI0020101	CARD FOR KEYBOARD CT1SI0020101	PLATINE FÜR TASTATUR CT1SI0020101	FICHE CLAVIER P/ PLATINE CT1SI0020101
44	RA880035		MOTOVENT. EBM AE350-AP06-01	MOTOR FOR FAN EBM AE350-AP06-01	MOTOR F. VENTILATEUR EBM AE350-AP06-01	MOTEUR VENTILATEUR EBM AE350-AP06-01
45	RA170052		GRIGLIA EBM 64560-2-4039 PER GR 350	GRID EBM 64560-2-4039 FOR GR 350	GITTER EBM 64560-2-4039 FÜR GR 350	GRILLE EBM 64560-2-4039 POUR GR 350
46	RA012009		FILTRO DEIDR. CASTEL 4308/3S	DEHYDRATION FILTER 4308/3S	WASSERENTZIEHUNG-FILTER 4308/3S	FILTRE DEHYDRATATION 4308/3S
47			INCLUSO IN PARTICOLARE 44	INCLUDED IN POS. 44	IM POS. 44 ENTHÄLT	INCLUS A LA POS. 43
48	RA714014		VALV. SOL.Ø10 SALD.CASTEL 1068/M10S	CASTEL SOLENOIDE VALVE 10 1068/M10S	CASTEL SOLENOID-VENTIL 10 1068/M10S	SOUPAPE SOLENOIDE CASTEL 10 1068/M10S
48	RA714016		BOBINA 220-50/60 PER VAL.SOL.CASTEL	COIL 220-50/60 FOR SOLENOIDE VALVE	SPUL 220-50/60 FÜR SOLENOID-VENTIL	BOBINE 220-50/60 P/SOUPAPE SOLENOIDE
48	RA714017		CONNETTORE PG11 X VALV. SOL. CASTEL	CONNECTOR PG11 F. SOLENOIDE VALVE	VERBINDFER PG11 FÜR SOLENOID-VENTIL	CONNECTEUR PG11 P. SOUPAPE SOLENOIDE
49	RA090015		CONDEN. 2522-16T-5R-380-SP3.5-5AL	CONDENSER 2522-16T-5R-380-SP3.5-5AL	KONDENSER 2522-16T-5R-380-SP3.5-5AL	CONDENSATEUR 2522-16T-5R-380-SP3.5-5AL
50	RA073006		COMPRESSORE ASPERA J9232GS	COMPRESSOR ASPERA J2212GS	KOMPRESSOR ASPERA J2212GS	COMPRESSEUR ASPERA J2212GS
	RA953005		PRESSOSTATO ALTA RANCO 063P104000	PRESSURE SWITCH – HIGH PRESSURE	DRUCKWÄCHTER – HOCH DRUCK	PRESSOSTAT – PRESSION HAUTE
	RA919008		SUONERIA DB 20 24V	BUZZER DB 20 24V	SUMMER DB 20 24V	SONNERIE DB 20 24V
	RA130005		ADESIVI "ATTENZIONE 400V"	ADHESIVE WARNING 400V	KLEBSTOFF ACHTUNG 400V	ADHESIF ATTENTION 400V
	RA986501		FUSIBILE 2A F5020K2A	FUSE 2A F5020K2A	SCHMELZSICHERUNG 2A F5020K2A	FUSIBLE 2A F5020K2A
	RA986502		FUSIBILE 400 MA 5X20F	FUSE 400 MA 5X20F	SCHMELZSICHERUNG 400 MA 5X20F	FUSIBLE 400 MA 5X20F
	RA986503		FUSIBILE 4A F5020K4A	FUSE 4A F5020K4A	SCHMELZSICHERUNG 4A F5020K4A	FUSIBLE 4A F5020K4A

03	Pagina 10: sostituito codice pos. 6	06/02/01	De Cian	Zambon
02	Pagine 10-11: sostituito cod. pos. 23-28-36	29/05/00	Fontanive	Zambon
01	Pagine 7-8: sostituito cod. pos. 5-35-43, tolto assieme pos. 13 e inseriti particolari	04/02/00	Fontanive	Zambon