

Serie Serie Série	SYSTEM 700	Modello Modell Modèle	7EUK/40	Codice Kodex Code Code	AM0104023062	Tav. Detail Détail	1/3
Primo numero di serie Erste Seriennummer First serial number Première numéro de série	Ultimo numero di serie Letzte Seriennummer Last serial number Dernière numéro de série			Revisi Revision Révision		00	
Disegnato Gezeichnet	MASARIN	Approvato Geprüft	File Date		23062-7EUK_40 Esploso.idw	Data Datum	21/04/2011
 ambach® GROSSKÜCHENTECHNIK - GRANDI CUCINE						39052 Kalln-Caldaro (ITALY) Tel. 0471-662213 Telex 0471-60205	

Cestelli per cuocipasta/Pastakörbe/Pastacooker baskets/Paniers à pâtes

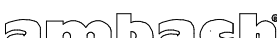

Serie Serie Série	SYSTEM 700	Modello Modell Modèle	7EUK/40	Codice Kodex Code Code	AM0104023062	Tav. Detail Detail	2/3
Primo numero di serie Erste Seriennummer First serial number Première numéro de série		Ultimo numero di serie Letzte Seriennummer Last serial number Dernière numéro de série			Revision Revision Revision Revision		
Disegnato Gezeichnet		Approvato Geprüft		File Date		Data Datum	
MASARIN				23062-7EUK_40 Esploso.idw		21/04/2011	
						38052 Katten-Calden/ITALY Tel. 0471-662213 Telex 0471-662055	

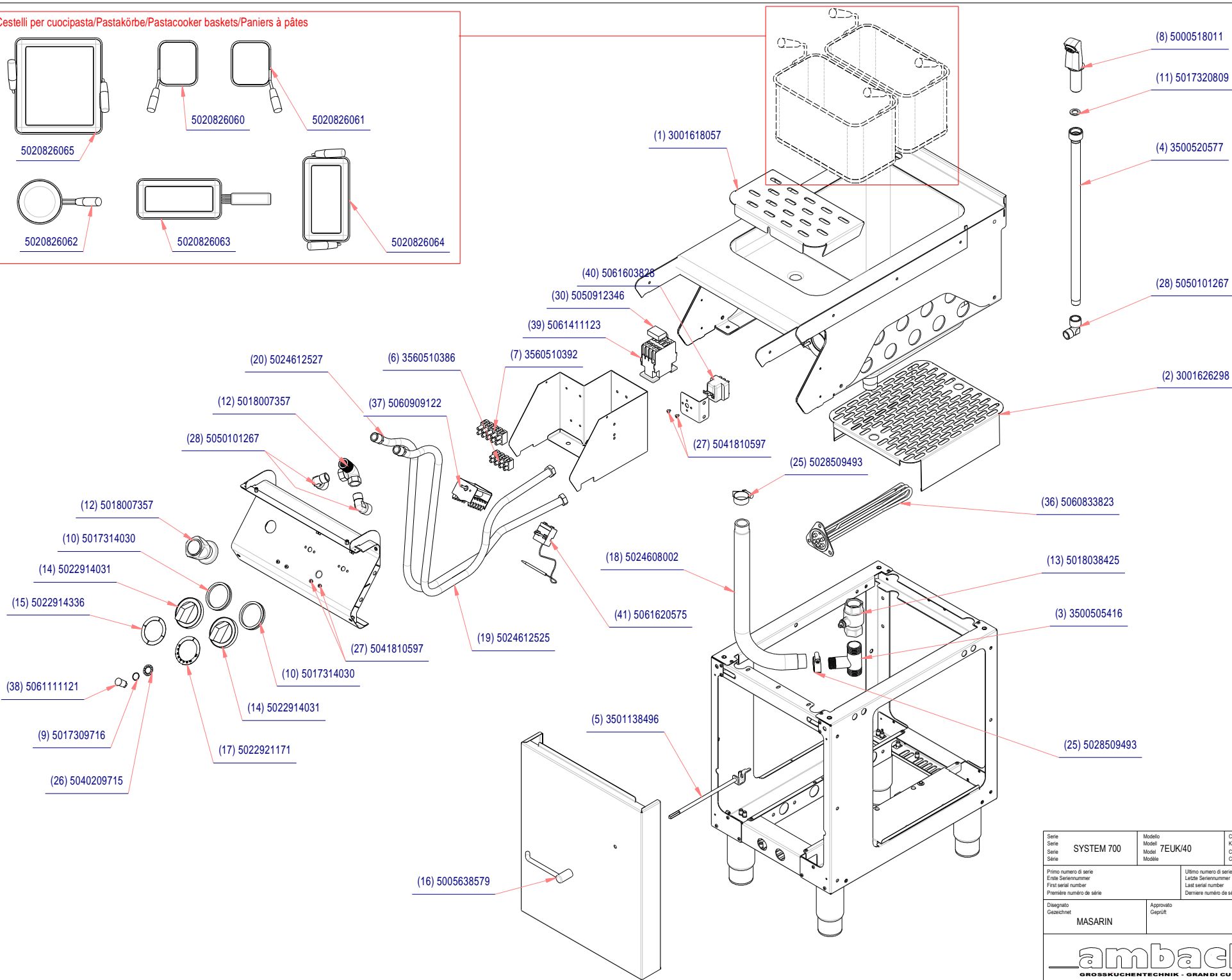
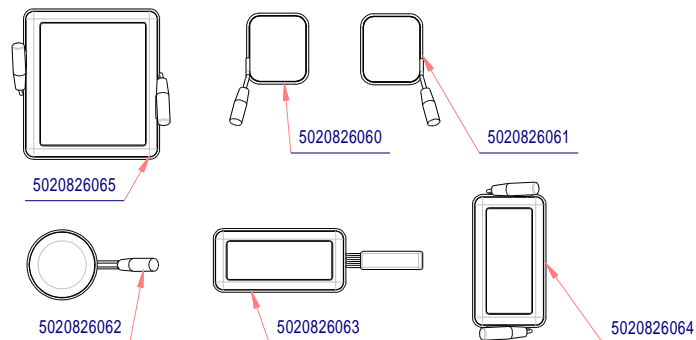
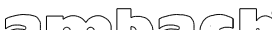
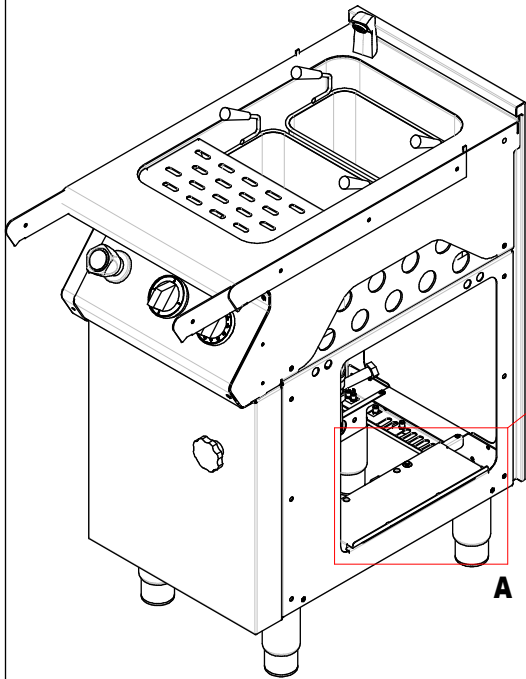

A

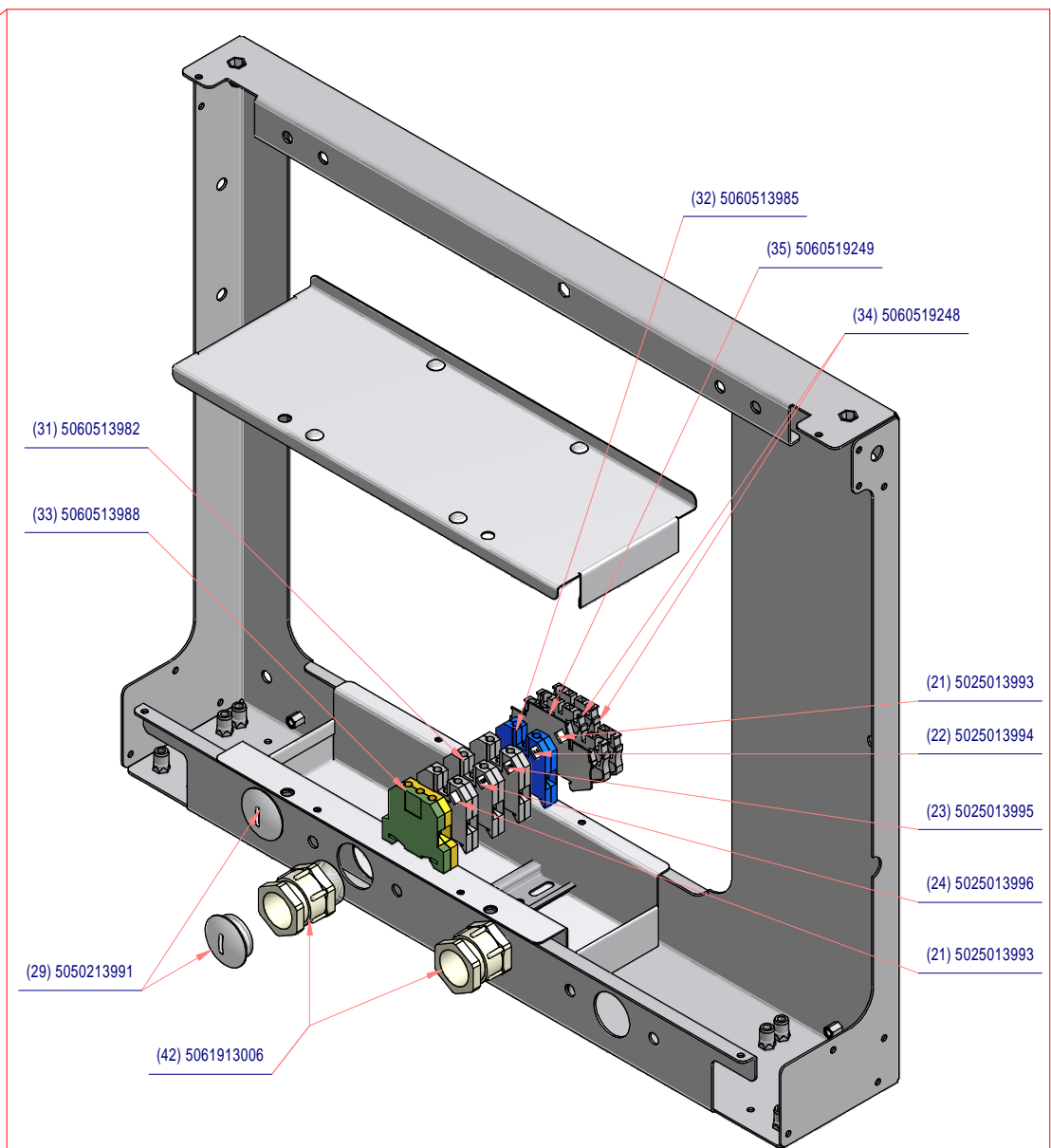

A

Serie Serie Série	SYSTEM 700	Modello Modell Modèle	7EUK/40	Codice Kodex Code Code	AM0104023062	Tav. Detail Detail Detail	3/3
Primo numero di serie Erste Seriennummer First serial number Première numéro de série		Ultimo numero di serie Letzte Seriennummer Last serial number Dernière numéro de série			Revisione Revision Revision Révision		
					00		
Disegnato Gezeichnet	Approvato Geprüft	File Date			23062-7EUK_40 Esplsoo.idw	Data Datum	
MASARIN					21/04/2011		
					38052 Kallern-Castello-ITALY Tel. 0471-662213 Telex 0471-60205		
GROSSKUCHENTECHNIK - GRANDI CUCINE							

AM0104023062

7EUK/40

CUOCIPASTA ELETTRICO 7EUK/40
ELT. PASTAKOCHER 7EUK/40

ELT. PASTA COOKER 7EUK/40
CUISEUR À PÂTES ÉLT. 7EUK/40

	CODE	Descrizione	Beschreibung	Description	Désignation	St/Qty	Start	Finish	Serialnr.
1	AM3001618057	RIPIANO SGOCCIOLATOIO EUK/45 II	ABTROPFBLECH EUK/45 II	DRIP PLATE UK/45 II	TÔLE D'ÉGOUTTAGE EUK/45 II				
2	AM3001626298	FONDO FORATO 7EUK/40-7GUK/40	GELOCHTER EINLEGEBODEN 7EUK/40-7GUK/40	PERFORATED BASE PLATE 7EUK/40-7GUK/40	DOUBLE FOND PERFORÉ 7EUK/40-7GUK/40				
3	AM3500505416	TUBO SCARICO ACQUA CPG/GPK	ROHR WASSERABLAUF CPG/GPK	WATER OUTLET PIPE CPG/GPK	TUYAU D'ÉCOULEMENT D'EAU CPG/GPK				
4	AM3500520577	ASSIEME TUBO ENTRATA ACQUA	ZUSAMMEMBAU ROHR WASSEREINLAUF	WATER INLET PIPE ASSEMBLY	ENSEMBLE TUYAU REMPLISSAGE EN EAU				
5	AM3501138496	ASSE RUBIN.SCARICO 7EUK/40	WELLE AUSLAUFHAHN 7EUK/40	SPINDLE DRAIN COCK 7EUK/40	AXE ROBINET DE VIDANGE 7EUK/40				
6	AM3560510386	MORSETTIERA 4 P PA/76 SEZ-6	ANSCHLUSSKLEMME 4 P PA/76 SEZ-6	CONNECTION TERMINAL 4 P PA/76 SEZ-6	BORNE D'ALIMENTATION 4 P PA/76 SEZ-6				
7	AM3560510392	MORSETTIERA 5 P PA/220 SEZ16	ANSCHL.KLEMME 5 P PA/220 SEZ16	CONNEXION TERMINAL 5 P PA/220 SEZ16	BORNE DE CONNEXION ÉLT. 5 P PA/220 SEZ16				
8	AM5000518011	GETTO EROGAZIONE ACQUA 3/4" EUK/II	EINLAUFARMATUR 3/4" EUK/II	WATER FILLING TAP 3/4" EUK/II	ROBINET ALIMENTATION D'EAU 3/4" EUK/II				
9	AM5017309716	GUARNIZIONE ANELLO SILICONE D=18/16X0,5	SILIKONDICHRING D=18/16X0,5	SILICONE GASKET D=18/16X0,5	RONDELLE ÉTANCHEITÉ SILICONE D=18/16X0,5				
10	AM5017314030	GUARNIZIONE MANOPOLA VA 60	DICHTUNG SCHALTKNOPF VA 60	CONTROL KNOB GASKET VA 60	JOINT D'ÉTANCHEITÉ BOUTON DE CDE VA 60				
11	AM5017320809	GUARNIZIONE NOVUS 20 3/4"	DICHTUNG NOVUS 20 3/4"	GASKET NOVUS 20 3/4"	JOINT D'ÉTANCHEITÉ NOVUS 20 3/4"				
12	AM5018007357	RUBINETTO INC.BLU 1/2"	WASSERARMATUR BLAU 1/2"	BLUE COLD WATER TAP 1/2"	ROBINET D'EAU FROIDE (BLEU) 1/2"				
13	AM5018038425	VALVOLA A SFERA 1" R250D	KUGELVENTIL 1" R250D	BALL VALVE 1" R250D	SOUPAPE A BOISSEAU SPHERIQUE 1" R250D				
14	AM5022914031	MANOPOLA ELETTRICA S/90	SCHALTKNOPF ÉLT. S/90	ELECTRIC CONTROL KNOB S/90	MANETTE DE COMMANDE ÉLECTRIQUE S/90				
15	AM5022914336	ANELLO MANOPOLA EL.0-1-2-3	KNEBELSCHEIBE ÉLT. 0-1-2-3	TOMMY DISK ÉLT. VERSION 0-1-2-3	DISQUE A GARRET VERSION ÉL. 0-1-2-3				
16	AM5005638579	VOLANTINO CON INDICE SYSTEM	KNEBEL AUSLAUFHAHN SYSTEM	HANDLE DRAIN COCK SYSTEM	POIGNÉE ROBINET VIDANGE SYSTEM				
17	AM5022921171	ANELLO MANOPOLA 30-100°C	KNEBELSCHEIBE 30-100°C	TOMMY DISK KNOB 30-100°C	DISQUE A GARRET BO. 30-100°C				
18	AM5024608002	TUBO ACQUA CPG/GPK/GUK	WASSERSCHLAUCH CPG/GPK/GUK	WATER PIPE CPG/GPK/GUK	TUYAU D'EAU CPG/GPK/GUK				
19	AM5024612525	TUBO FLESS. 1/2"M-1/2"F L=900	FLEX.STAHLSCHL. 1/2" M-W L=900	FLEXIBLE HOSE 1/2" M-W L=900	TUYAU FLEXIBLE 1/2" M-W L=900				
20	AM5024612527	TUBO FLESS. 1/2"M-1/2"F L=1200	FLEX.STAHLSCHL. 1/2" M-W L=1200	FLEXIBLE HOSE 1/2" M-W L=1200	TUYAU FLEXIBLE 1/2" M-W L=1200				
21	AM5025013993	SEGNALINO MORSETTO (NEUTRO)	KLEMMEMARKIERUNG (NULLEITER)	TERMINAL INDICATOR (NEUTRAL)	INDICATION BORNE (NEUTRE)				
22	AM5025013994	SEGNALINO MORSETTO L1	KLEMMEMARKIERUNG L1	TERMINAL INDICATOR L1	INDICATION BORNE L1				
23	AM5025013995	SEGNALINO MORSETTO L2	KLEMMEMARKIERUNG L2	TERMINAL INDICATOR L2	INDICATION BORNE L2				
24	AM5025013996	SEGNALINO MORSETTO L3	KLEMMEMARKIERUNG L3	TERMINAL INDICATOR L3	INDICATION BORNE L3				
25	AM5028509493	FASCETTA TUBO INOX 32-50/13 W4	ROHRSCHELLE INOX 32-50/13 W4	PIPE CLAMP D=50/13 W4	COLLIER POUR TUYAUX D=50/13 W4				
26	AM5040209715	RONDELLA-FISSAGGIO D=26-DI=15	BEFESTIGUNGSSCHEIBE D=26-DI=15	FIXING WASHER D=26 DI=15	RONDELLE DE FIXATION D=26 DI=15				
27	AM5041810597	VITE TC IMP.CROCE M4x5 INOX	ZYLINDERSCHR.KSL M4x5 INOX	PAN HEAD SCREW M4x5 INOX	VIS A TÊTE CYLINDRIQUE KSL M4x5 INOX				
28	AM5050101267	GOMITO OTTONE M+F 1/2"ART.458	BOGEN MESSING M+W 1/2" ART.458	ELBOW IN BRASS M+F 1/2"ART.458	RACCORD COUDE EN LAITON M+F 1/2" ART.458				
29	AM5050213991	TAPPO FILETTATO PG 21	BLINDSCHRAUBE PG 21	THREADED PLUG PG 21	BOUCHON FILETÉ PG 21				
30	AM5050912346	FILTRO ANTIDISTURBO 130/240 V	SCHÜTZENTSTÖRFILTER 130/240 V	ANTI-INTERFERENCE FILTER 130/240 V	FILTRE ANTI-PARASITES 130/240 V				
31	AM5060513982	MORSETTIERA GRIGIA 16QMM	UNIVERSALKLEMME GRAU 16QMM	GREY UNIVERSAL TERMINAL 16QMM	BORNE UNIVERSELLE GRISE 16QMM				
32	AM5060513985	MORSETTO NEUTRO BLU 16QMM	NULL-LEITERKLEMME BLAU 16QMM	BLUE NEUTRAL TERMINAL 16QMM	BORNE DE NEUTRE BLEUE 16QMM				
33	AM5060513988	MORSETTO DI TERRA GIALOVERD.16QMM	ERDUNGS-KLEMME GELBGRÜN 16QMM	EARTH TERMINAL YELLOW/GREEN16QMM	BORNE DE TERRE JAUNE/VERT 16QMM				
34	AM5060519248	MORSETTO DUE PIANI GRIGIO	ZWEI-ETAGEN ANSCHLUSSKLEMME GRAU	GREY 2-LEVEL TERMINAL	BORNIER À 2 NIVEAUX GRIS				
35	AM5060519249	TERMINALE MORSETTO A DUE PIANI	ABSCHL. ZWEI ETAGEN ANSCHLUSSKLEMME	2 WAYS TERMINAL END PLATE	PLAQUE FERMETURE DE BORNE À DOUBLE ÉTAGE				
36	AM5060833823	RESISTENZA 6000W 230V EUK/TRASV.	HEIZKÖRPER 6000W 230V EUK/QUER	HEATING ELEMENT 6000W 230V EUK/CROSSWAYS	RÉSISTANCE 6000W 230V EUK/TRAVERS				
37	AM5060909122	COMMUTATORE 4 POS. BPE/PE/KSKE	NOCKENSCHALTER 4T. BPE/PE/KSKE	4 STEP SWITCH BPE/PE/KSKE	COMMUTATEUR 4 POSITIONS BPE/PE/KSKE				
38	AM5061111121	LAMPADA SPIA BIANCA 230V T150C	SIGALLEUCHTE WEISS 230V T150C	WHITE CONTROL LAMP 230V T150C	VOYANT LUMINEUX BLANC 230V T150C				
39	AM5061411123	CONTATTORE CL02A400T6AM CGE	SCHÜTZ CGE CL02A400T6AM CGE	CONTACTOR CL02A400T6AM CGE	CONTACTEUR CL02A400T6AM CGE				
40	AM5061603828	TERMOSTATO LIMITAT KKE/PE	SICHERHEITSTHERMOSTAT KKE/PE	SAFETY THERMOSTAT KKE/PE	THERMOSTAT DE SÉCURITÉ KKE/PE				
41	AM5061620575	TERMOSTATO 30-120°C	THERMOSTAT 30-120°C	THERMOSTAT 30-120°C	THERMOSTAT 30-120°C				
42	AM5061913006	PASSACAVI PA. PG/21 Mod.6321PA	VERSCHRAUBUNG PA PG/21 Mod.6321PA	GROMMET PA PG/21 Mod.6321PA	PASSE-CABLES PA PG/21 Mod.6321PA				